



Global Construction



**BUILDING BETTER
TOGETHER**

Building better together.



Data Centres



Energy



Semi Conductors



EV & Batteries

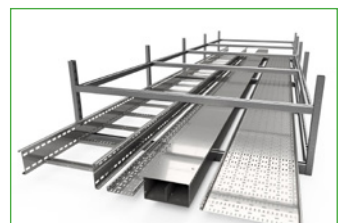

Modular & Pre Fabrication



Healthcare

Global Projects

About Us.....	4
Our Global Presence.....	5
Why Choose Atkore?.....	6
Construction Services.....	7
Design Solutions.....	8
Market Expertise.....	9
One Stop Shop.....	10
Contact Us.....	11





Atkore specializes in Design, Fabrication, and Installation catering to the entire project life cycle. Atkore's trusted service and emphasis on industry-leading workmanship reflects a commitment to quality and reliability in project delivery.

Global Construction Services division has experience in delivering innovative solutions for projects globally, spanning various industries such as Semiconductors, Healthcare, Data Centers, Commercial, and more.

Atkore is involved in a range of project solutions, including rooftop installations showcasing versatility in addressing diverse construction requirements. Being a single source for products and installation offers an advantageous integrated approach for project efficiency and coherence.

This unified approach of providing products and installation services positively reflects on Atkore's core mission. This mission centers on being the customer's first choice by delivering unmatched quality, timely delivery, and value based on sustainable excellence in strategy, people, and processes.

The core mission underscores a customer-centric approach, aiming to position Atkore as the preferred choice by prioritizing quality, delivery time lines, and overall value. The mission incorporates the concept of sustainable excellence, indicating a long-term commitment to high standards in strategy, people management, and operational processes.

By combining these elements, Atkore's Unistrut Construction division, emphasizing its expertise, global reach, and commitment to customer satisfaction through a holistic approach to project solutions.

Our Global Presence

Building Better Together

A leading manufacturer of electrical, infrastructure, cable management support, and design installation

We are a leading manufacturer of electrical solutions that power and protect the world around us. For nearly a century, we have grown through a deep understanding of the high demands of the construction industry. Our portfolio of industry-leading brands, coupled with our breadth of products and solutions, brings exceptional value to our customers.

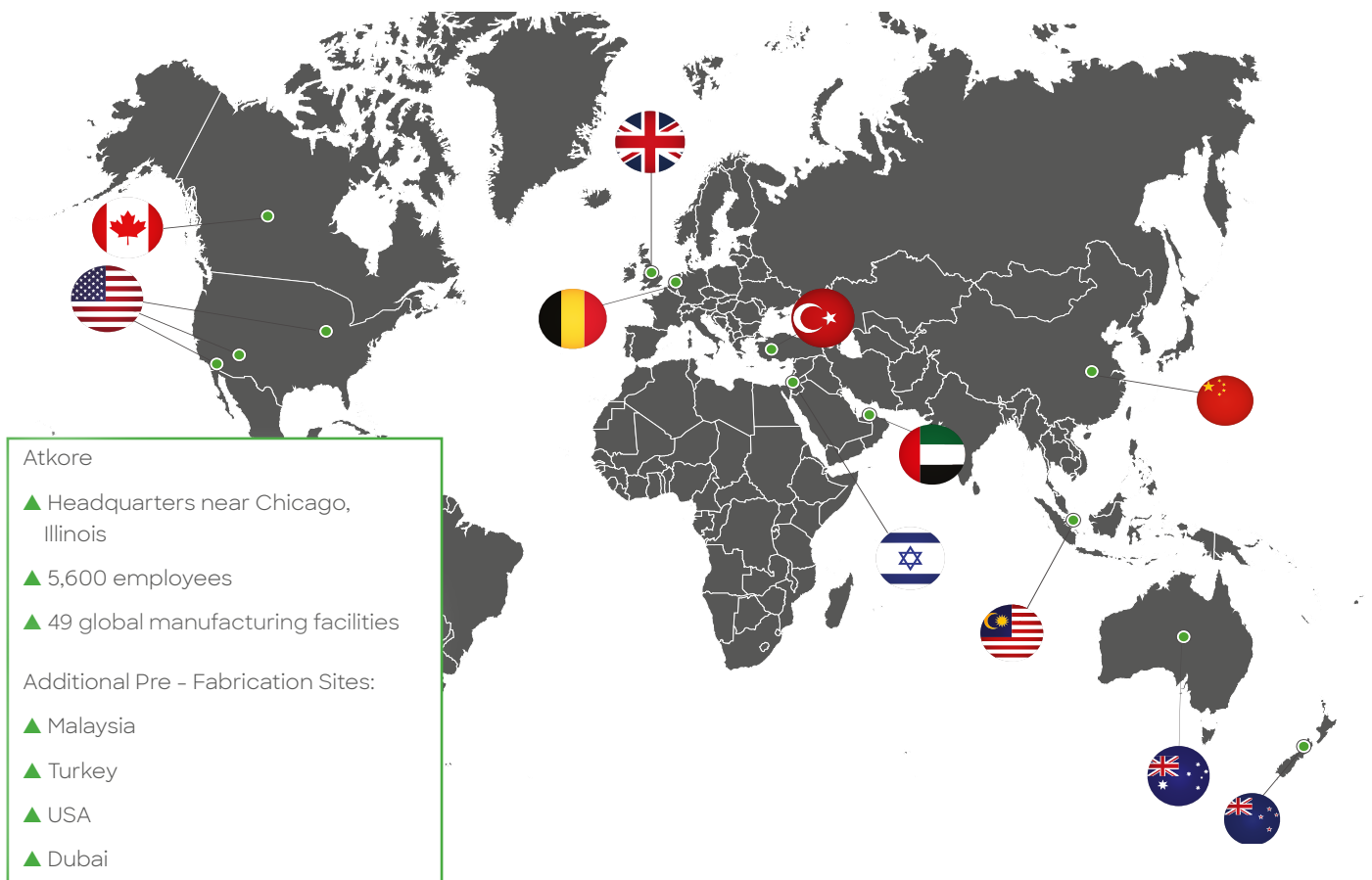

Our Mission

Atkore's mission is to be our customers' first choice by providing unmatched quality, delivery, and value based on sustainable excellence in strategy, people, and process.

Global manufacturing serving global markets

Our 5,600 employees and 49 manufacturing facilities worldwide are contributing to a future where engineers, contractors and our distributor partners can research, select, specify, procure and install the right solutions on time and under budget.

Environmental, Social, and Governance

Our commitment to producing high quality products while ensuring that all materials used in the manufacturing of our products are free of conflict minerals, lessens the negative impact to the people that create, use and deliver our products, while protecting the environment in which we work. We are invested in making environment, health, and safety an indispensable part of our company's commitment to sustainability.

For more information please visit Atkore.com

Why choose Atkore?

Building Better Together



Global Reach

With a 100-year legacy of engineering excellence across North America, Europe, Asia, and the Middle East, Atkore offers unparalleled quality and a global expertise for product development and seamless project delivery. An extensive network of local partners worldwide ensures comprehensive project support.



Value to Project

Atkore's off-site manufacturing (OSM) offers a global partnership, complete with installation services, catering to the standardisation needs of global companies.

Schedule Certainty:

Atkore's vertically integrated manufacturing approach helps eliminate waste and accelerates delivery times.

Cost Certainty:

We strive for the right products to be delivered on time.



Capabilities

Meeting today's construction challenges requires modern methods, encompassing seamless coordination from:

- ▲ Design
- ▲ Manufacture
- ▲ Off-site Manufacturing/Fabrication

We also offer managed design assistance and custom services, including piping, cable management, and exhaust systems, across North America, Europe, Asia, and the Middle East.



Services

Atkore offers comprehensive solutions, including design support and ownership, kitting, pre-assembly with detailed drawings and direction instructions, fabrication in 'strut 3D form,' and the installation of various systems.

Our 2D/3D modular systems, part of Atkore's Off-Site Manufacturing (OSM) expertise, encompass Metal Framing, Cable Management, Piping, Electrical Cables, and On-Site Installation.

Construction Services

Building Better Together

Atkore provides end-to-end solutions for complex projects, covering various stages from engineering and design to product manufacturing, off-site fabrication, and integration. This comprehensive approach enables clients to rely on Atkore for a full spectrum of project needs.

Global Reach: Atkore's capacity to operate on an international scale. This involves collaboration with global partners, showcasing Atkore's ability to navigate diverse and complex environments.

Engineering and Design Services: Atkore's expertise extends to the initial phases of projects, offering engineering and design services.

Product Manufacturing: Atkore engages in product manufacturing. This involves the production of specialized products or materials needed for the projects, ensuring control over the quality and specifications.

Off-site Fabrication: The inclusion of off-site fabrication highlights a modern approach to construction and project execution. Off-site fabrication often brings efficiency and precision to the construction process.

Integration Services: Atkore doesn't just stop at manufacturing; it provides integration services. The ability to seamlessly incorporate various elements into a cohesive whole, demonstrating a holistic understanding of project requirements.

Technical Expertise: Atkore possesses technical expertise needed for handling intricate and challenging projects.

Tailored Solutions: Atkore tailors its services to meet the specific demands of each project. This flexibility can be a significant advantage in industries where one-size-fits-all solutions may not be suitable.

Collaborative Approach: Atkore's willingness to work closely with clients, engineering teams, and other stakeholders to ensure project success.

Project Management Skills: Successfully handling complex, global projects requires effective coordination, planning, and execution.

Atkore has a strong value proposition to its potential clients, partners, and stakeholders, showcasing its capabilities in handling intricate and multifaceted projects on a global scale.

Design Solutions

Building Better Together



Our in-house design and engineering team are subject matter experts in the design application and anchoring solutions for mechanical electrical and plumbing systems. Value engineering solutions for complex projects use the most applicable product geometry and finish from our global library of products. Specialising in a “design to fabricate and install” approach, we ensure maximum total value while delivering the highest quality at the lowest total installed cost.

Experience ranges across all mechanical electrical and plumbing systems encompassing both Atkore and non-Atkore products alike. Work on numerous complex global commercial and industrial construction projects, sets us apart. If we are not the subject matter experts, we know who is and we are more than willing to partner with them to create the highest value for you.

We work across all digital platforms including AutoCAD, Navisworks, and Revit. Working with our partners, we can stamp and seal drawings in most jurisdictions globally.

Products

Atkore products meet local standards in the USA, Europe, Asia, and the Middle East regions, including NEMA, UL, ISO, and AIS compliance. We offer innovative solutions like Hot Aisle Containment, Defender, Seismic products, Trolleys, and Beam Clamps. With us, you will receive one invoice for all Atkore products, and we provide helpful design aids such as a BIM toolbar, BIM/CAD models, configurator, and Master Format specs for easy specification. Our products consistently meet ASTM, UL, ISO, NEMA, AISI, and other international standards.



Competency

Our global construction team is highly skilled in designing, engineering, and installing complex construction projects. We have extensive experience in coordinating the supply chain across North America, Europe, Asia, and the Middle East. Additionally, we excel in off-site manufacturing and have a unique vertical approach to standardising and representing global projects. As both a manufacturer and an OSM solution provider, we have the expertise to deliver exceptional results.



Market Expertise

Building Better Together



Manufacturing Solutions

Mega projects on a global scale require mega solutions. As a manufacturer with locations around the world, Atkore is a leading electrical infrastructure company powering and protecting facilities everywhere. Electrical conduit and fittings, cable management systems, infrastructure products, and safety and security products are all in our product portfolio. With multiple facilities across the globe, you can count on us to have standard and custom manufactured products to benefit your project.



Fabrication Solutions

Our design and engineering teams design solutions to be pre-fabricated off-site by implementing 2D modules that can be built to 3D and deployed and built on site by our construction team. This benefits general and subcontractors expediting schedule time lines by consolidating multiple traits prior to installation and deploying them on site and on time.



Logistic Solutions

Atkore is uniquely positioned both as a manufacturer of products and as a construction service provider. This allows our project management team to coordinate logistics on product, design, installation and construction.

As a result, product schedules are being optimised for Mega projects. We provide true vertical integration: from production to construction deployment; all coordinated and scheduled with Atkore's project management team.



Installation Solutions

Our construction group integrates engineering, design, execute prefabrication and installs modules optimising product schedules by coordinating production throughout our manufacturing sites. Our teams have the experience and know-how from prior mega projects. Effective installation and safety practices are deployed globally by our construction teams.

One Stop Shop

Building Better Together



Large Scale Modularisation



Engineered Solutions

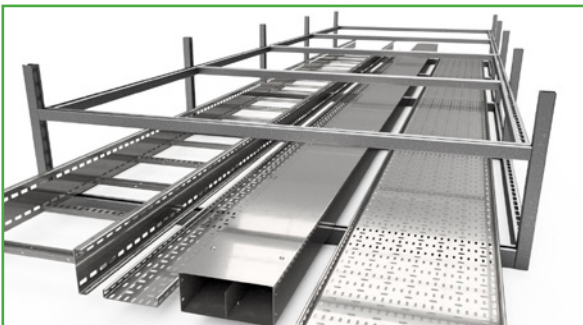

Populated Modules



Quality Assurance



DFMA

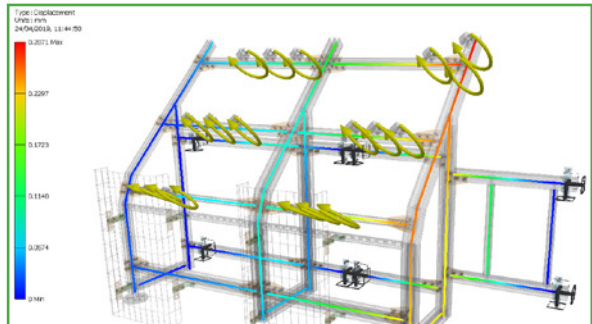

FEA

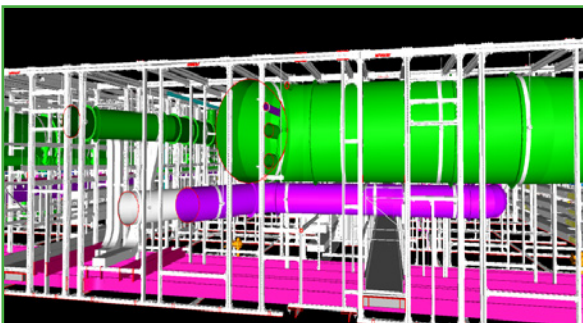

BIM

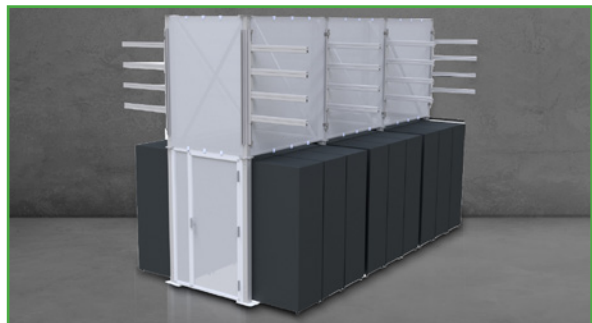

Unistrut Aisle Containment

Contact Us

Building Better Together



One contact, One team...

This concept emphasises the streamlined communication and collaboration within Atkore. All departments work together cohesively, with a single point of contact or a unified approach to problem-solving and decision-making for our customers.

Unistrut Construction (US)

2171 Executive Dr,
Addison, IL 60101 USA

Email: globalconstruction@atkore.com

CM&P International Head Office

Atkore, Castle Court 2,
Castlegate Way,
Dudley,
DY1 4RD
UK



**BUILDING BETTER
TOGETHER**

Atkore

Want to join a company that helps you build
the mindset, skill set and tool set for success?
Visit us at [atkore.com/careers](https://www.atkore.com/careers)