



Atkore BIM Toolbar User Manual

Introduction

The Atkore BIM toolbar provides access to a comprehensive BIM library of Atkore's electrical & mechanical products, including strut, conduit, fittings, cable cleats, cable tray, and bollards. It features tools like the Hanger Configurator for custom configuration and auto placement of hangers. This is a brief guide, if you have any questions or need more assistance feel free to contact us at atkorebimtoolbar@atkore.com

Activation

To activate the Atkore toolbar, click the **Activate** button upon first use.



Region Selection

Select the appropriate library based on your region in the Settings for immediate access to the correct products.

North American (NA (imperial), APAC and EMEA (metric)).



Family Management

The toolbar's Atkore Families function opens a dock-able panel within Revit, Click the Atkore Families button to open the panel.

- Click the **Open Library Manager** button to uncheck products you are unlikely to use.
- Use menu dropdowns for filtering or search to locate products.
- Click on a family to load into the current Revit project.
- Right-click on a family to access catalogs and cut sheets directly
- Use the **Sync** button periodically to ensure you have the most up-to-date and accurate information. We update families either by adding new products or by revising existing ones, based on user feedback or new product developments.



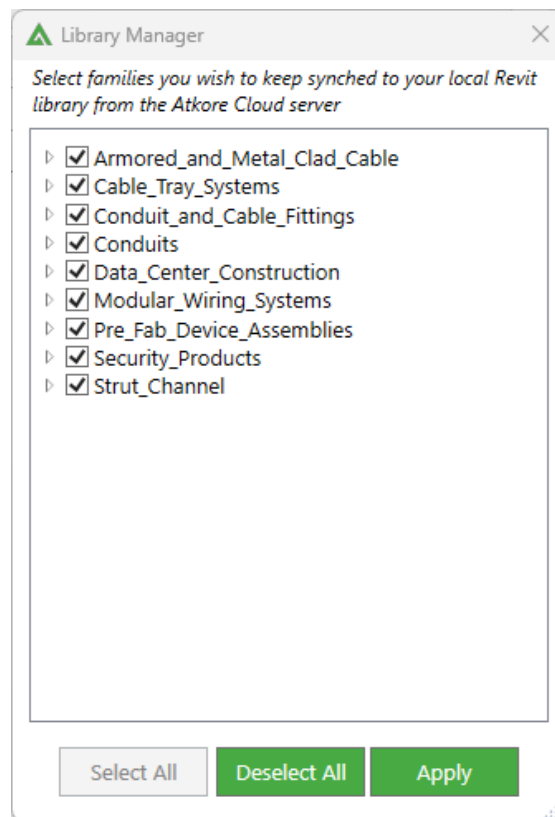
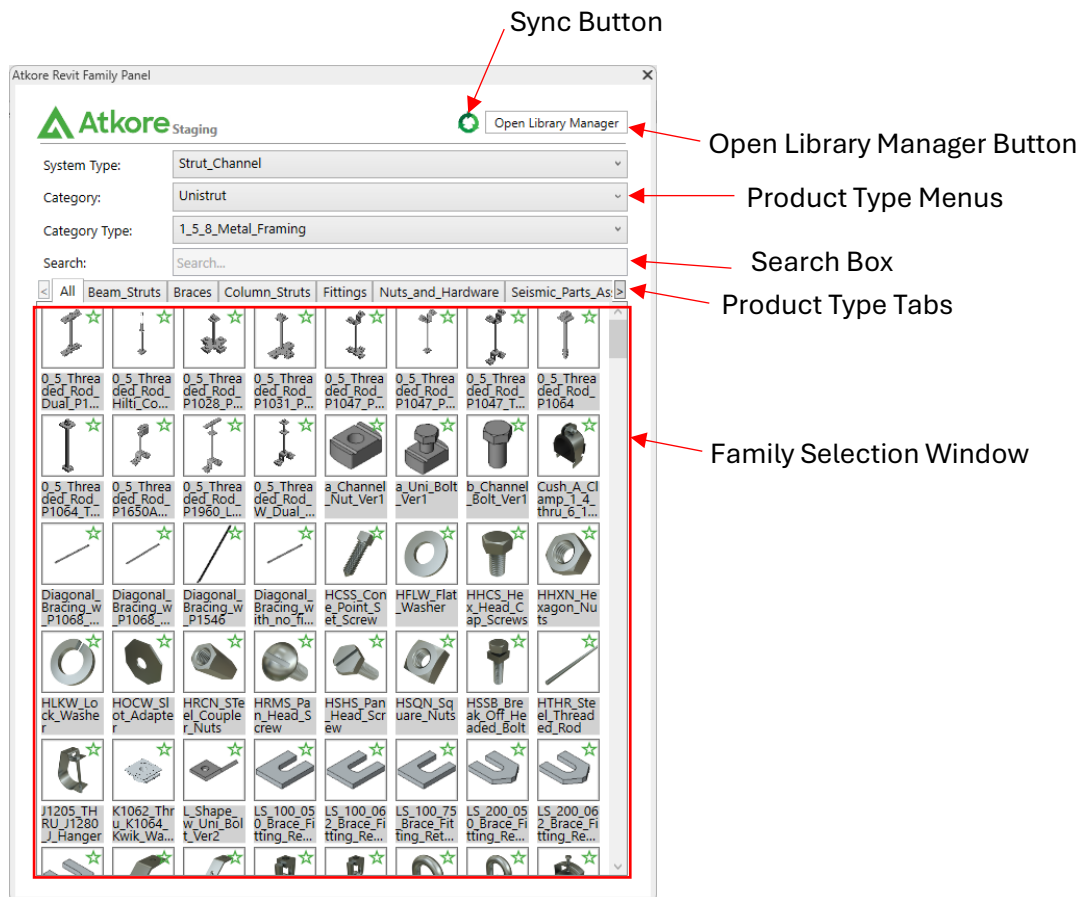

Custom Family Import “My Library”

Easily import your own families into the panel, either from a file, folder, or project:

- Select **My Library** in the System Type menu within the Atkore Revit Family Panel.
- Use the **File** button to import a single Revit family file, the **Folder** button for all families in a folder, or the **Project File** button for a family from the current project.

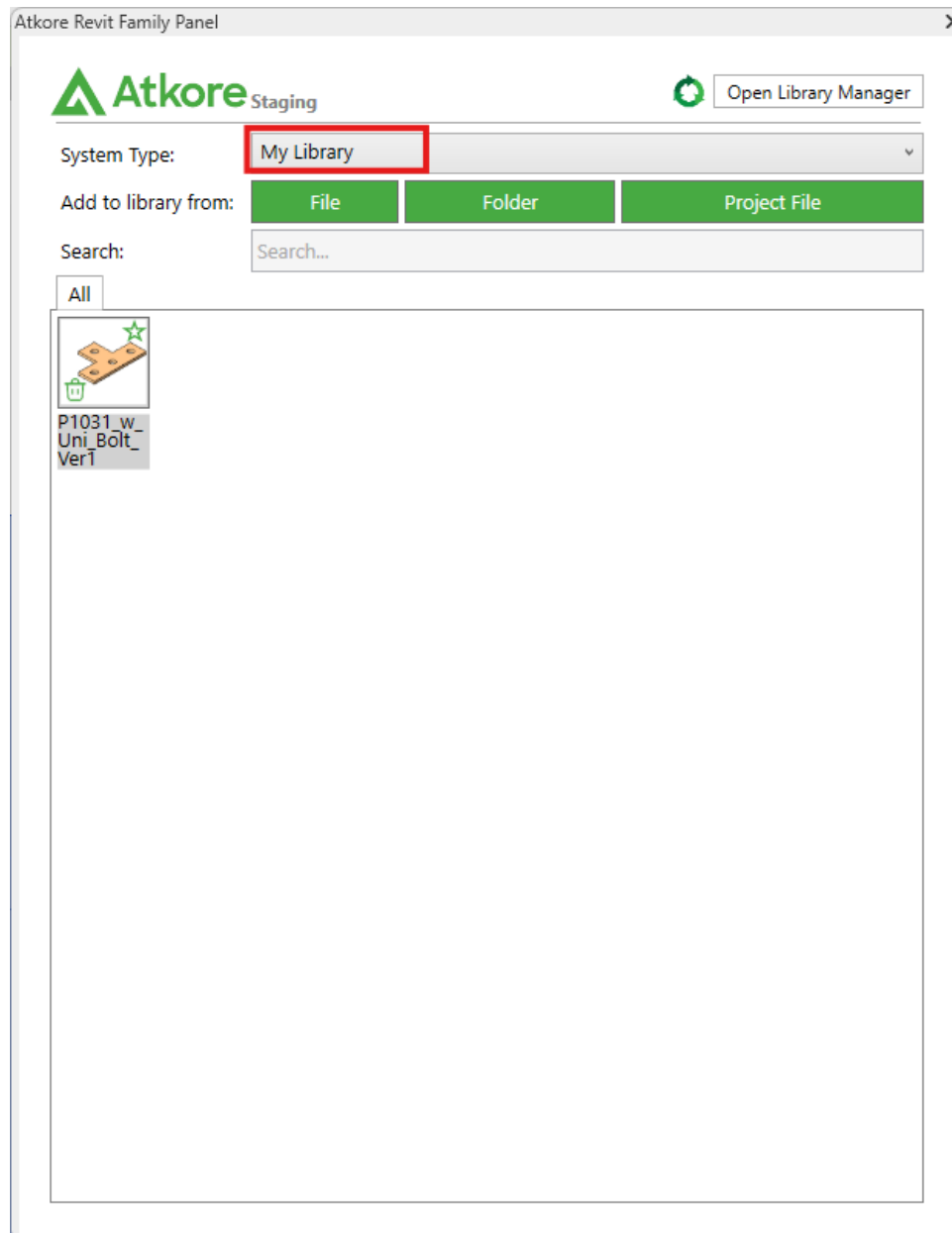

System Family Templates

Pre-made Atkore system family templates are readily available within the toolbar, offering examples of common fitting types that can be used immediately in projects.

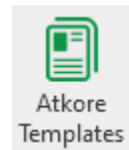

- Click the **Atkore Templates** button to open the panel.
- Use the **Template Type Menu** to switch between different template types.
- Select the desired templates and click the **Download** button to save them to your local hard drive.
- After downloading, create a new project file using the template or copy the system families from the template to your current project.

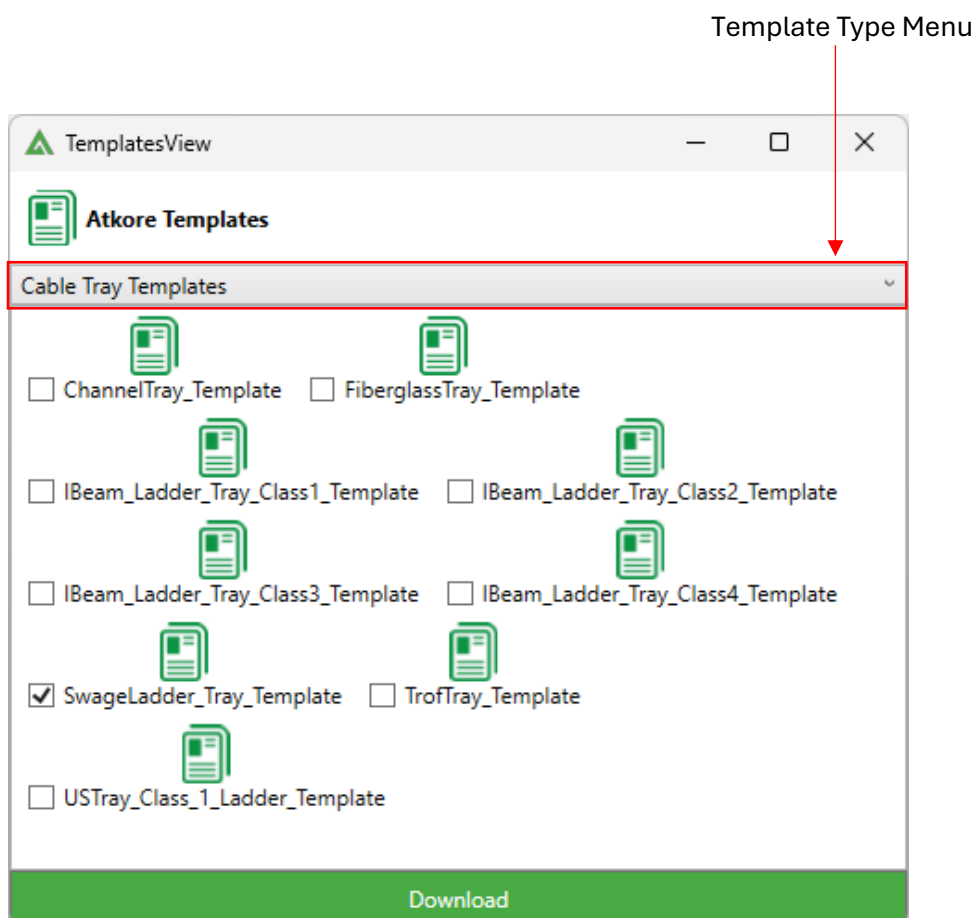

Hanger Configurator

The Hanger Configurator provides highly customizable options for users to create and adjust trapeze hangers and fiberglass grid hangers. Users can modify hanger dimensions, channels, and upper fittings, while also generating detailed PDF Bill of Materials (BOM) reports and drawings. This feature also has series placement capability:



- Click the **Hanger Configurator** button to open the panel.

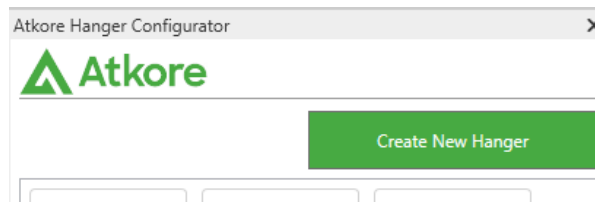

- Select cable tray, conduit, pipe, or duct runs and click **Create New Hanger**.

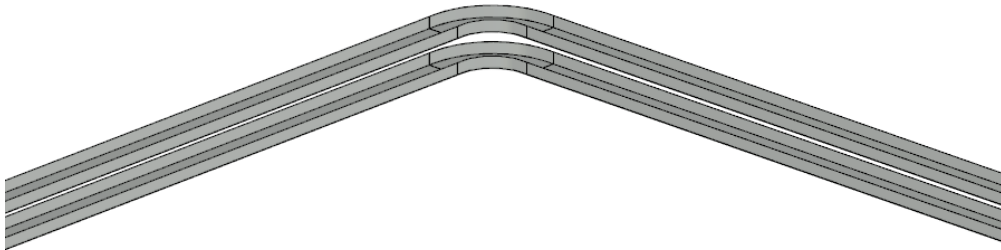

- Modify settings as needed and confirm. (Note: You can customize the green dimensions by clicking on them.)

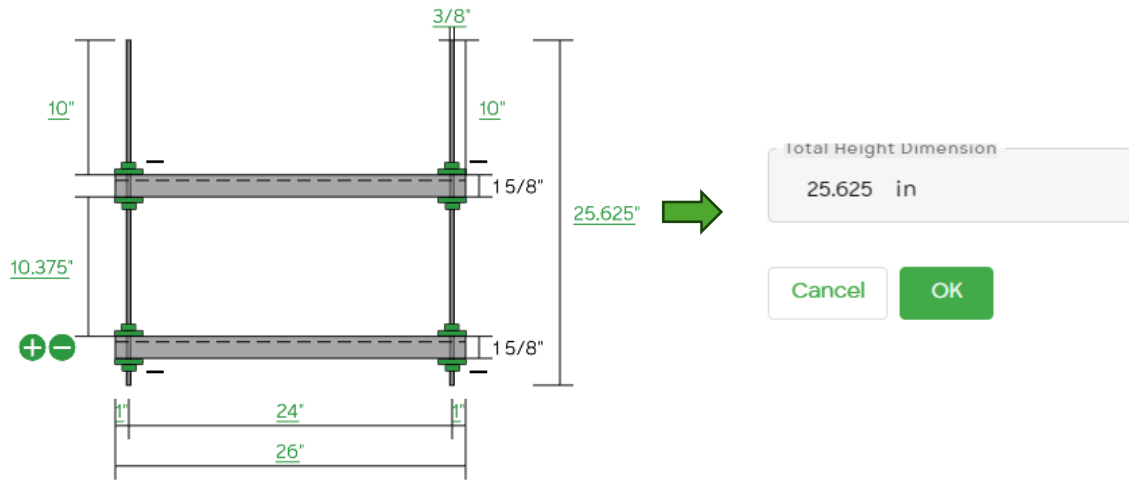

Select Trapeze Hanger Application

- ☒ Custom Trapeze / Multi-tiers
- ☐ Cable Tray
- ☐ Pipe / Conduit
- ☐ Duct

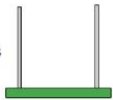

Conduit Trapeze

- ☐ Conduit Trapeze

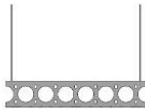

Fiberglass Grid Hanger

- ☐ Pipe / Conduit

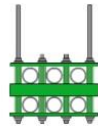

Custom Trapeze Hanger Configurator

Select and fill in all required fields below to generate a trapeze hanger model:

CHANNEL

ROD

FITTING

Specify Span

24 in

Total Channel Length

26 in

Channel 1

EDIT

Channel Type

P1000T

P3300T is recommended based on specified span, load & deflection

Select Channel Direction

UPWARDS

DOWNWARDS

Channel 2

EDIT

DELETE

Channel Type

P1000T

P3300T is recommended based on specified span, load & deflection

Select Channel Direction

UPWARDS

DOWNWARDS

+ ADD CHANNEL

Rod >

Preferred Brand

Unistrut

Power-Strut

Preview

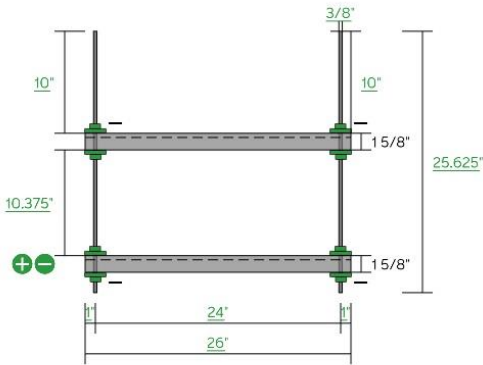

*not to scale

DISCLAIMER: This tool is being provided for information purposes only and is intended only to assist purchasers with visual configuration, preparing bill of materials, modeling and pricing of Atkore products. User/Purchaser is responsible for design, product selection and review and approval by a qualified engineer. All purchases are subject to the terms and conditions available at [Atkore.com/Terms](https://www.atkore.com/Terms).

For any questions or requests contact atkoretoolbar@atkore.com

Confirm

- Rename the hanger and click **Generate Revit Family**.
- Configure placement and click **Place Hanger**.

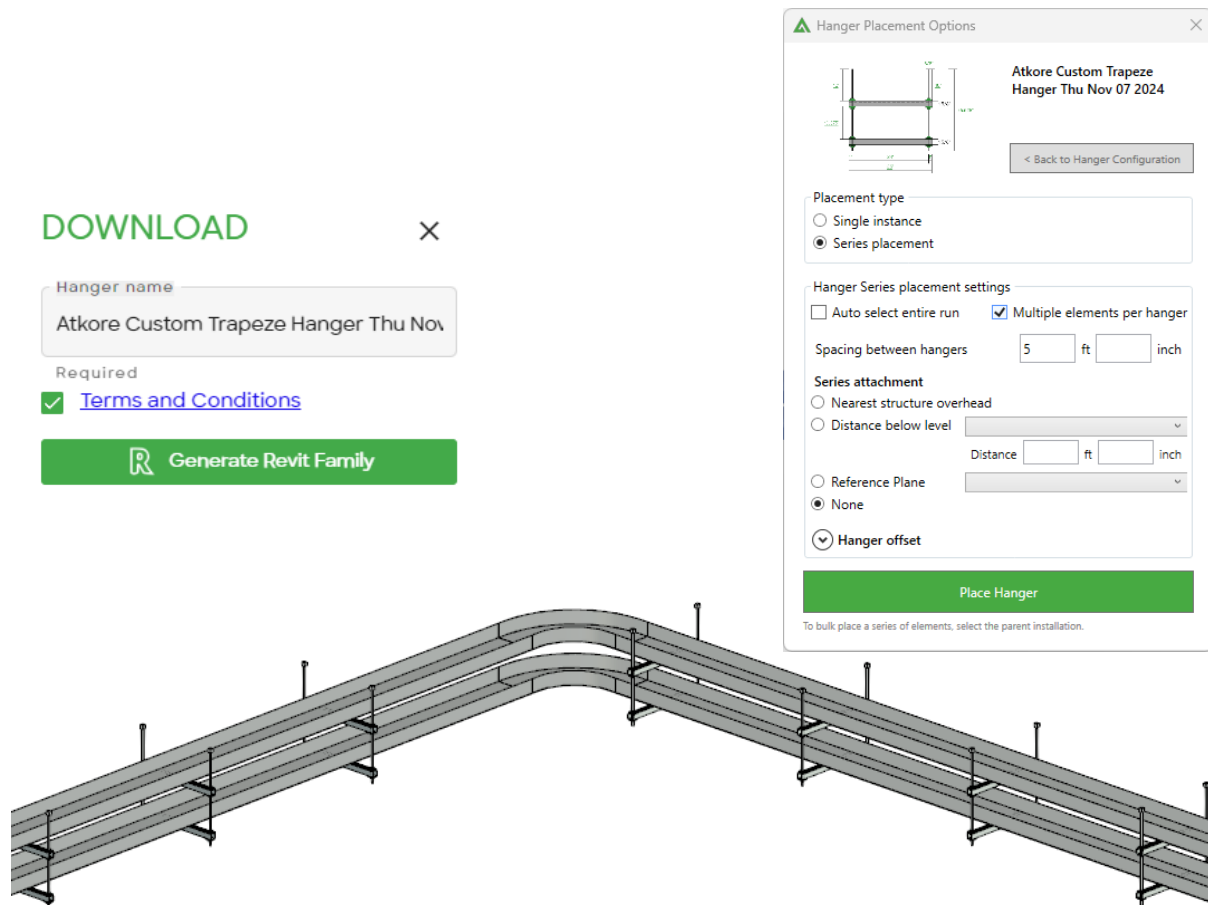

- Reuse hanger configurations within the same project and across different projects by selecting the saved hanger configuration from the **Hanger Configurator** panel and applying it to new locations.

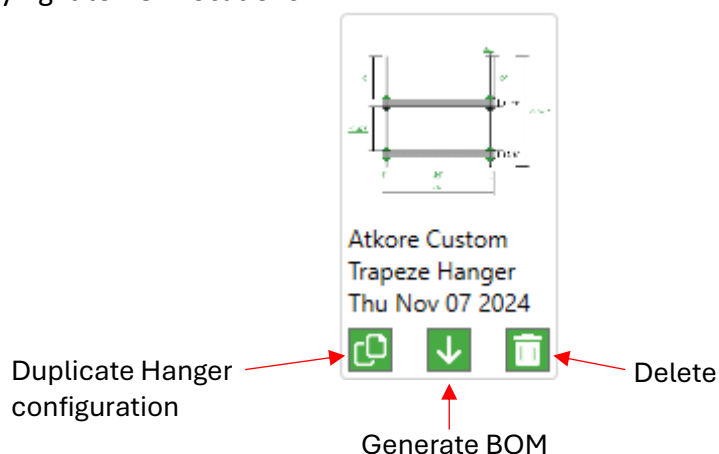

- Select the configuration and click **Back to Hanger Configuration** for adjustments.

Automated Bill of Materials (BOM) Export

The BOM Export tool simplifies the generation of detailed material lists. With just a few clicks, users can export the BOM and hanger details in a zip file that includes both Excel sheets and PDFs, listing all family names, parameters, and total quantities. This feature greatly reduces the time spent on material planning and helps ensure accuracy for procurement and project execution.



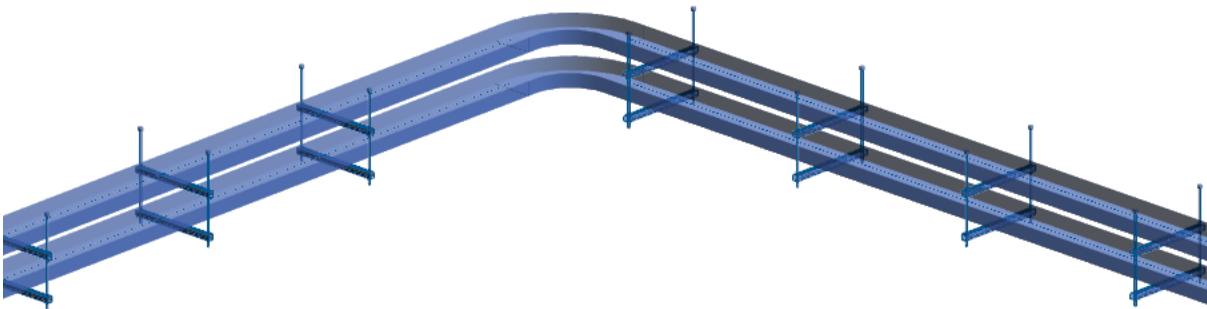

- Choose the elements for the BOM.



- Click the **BOM Export** button and select your desired action (Download BOM and Hangers, Get A Quote, Edit Selection).

 BOM Export

Selected elements

Cable Tray with Fittings: Channel Cable Tray	4	
Channel Horizontal Bend: Standard	2	
Atkore Custom Trapeze Hanger Thu Nov 07 2024: Atkore Custom Trapeze Hanger Thu Nov 07 2024	7	

Next

 BOM Export

Selected elements

Name	Count	Channel
Cable Tray with Fittings: Channel Cable Tray	2	
Cable Tray with Fittings: Channel Cable Tray	2	
Channel Horizontal Bend: Standard	2	
Atkore Custom Trapeze Hanger Thu Nov 07 2024: Atkore Custom Trapeze Hanger Thu Nov 07 2024	7	2' - 2"

< >

Download BOM and Hangers

Get A Quote

Edit Selection

- When you select Download BOM and Hangers, you will receive a zip file containing both an Excel sheet and a PDF. (Refer to the screenshots below for an example.)

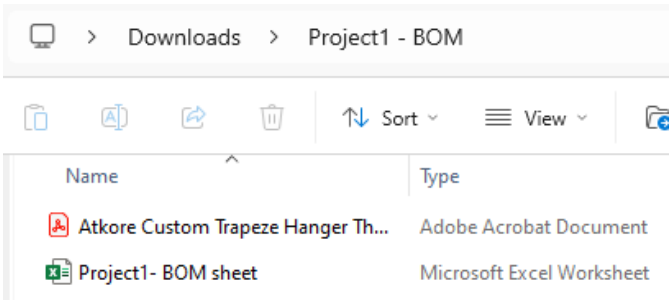

Date: 11/7/2024 Project name: -
Atkore Salesperson #: - Project location: -
Email: - Company: -
Phone Number: - Name: -
Email: -

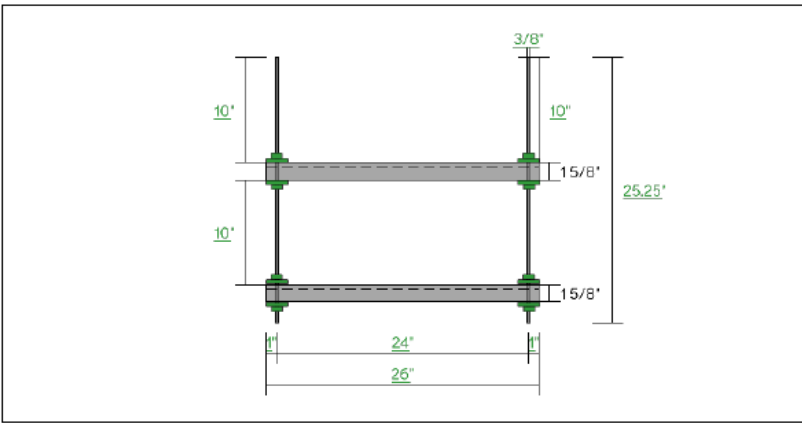

Combined hangers

Hanger Quantity 7 Threaded rods length 353.5" P1000T strut length 364"

Hanger Name:	Atkore Custom Trapeze Hanger Thu Nov 07 2024	Comments:
Hanger Type:	Trapeze Hanger	
Quantity:	7	
Prefabrication:	-	

Item	Description	Material	Length	Quantity
1	P1000T Unistrut Channel	Pre-Galvanized (PG)	26"	1
2	P1000T Unistrut Channel	Pre-Galvanized (PG)	26"	1
3	3/8" HTHR037 Threaded rod	EG	25.25"	2
4	Hex nut and square washers	EG	N/A	8

Date: 11/7/2024

A1		Project1						
A		B	C	D	E	F	G	
1		Project1						
2								
3		Name	Count	Channel Length Row 1	Channel Length Row 2	Channel Type Row 1	Channel Type Row 2	Height
4		Cable Tray with Fittings: Channel Cable Tray	2					4"
5		Cable Tray with Fittings: Channel Cable Tray	2					4"
6		Channel Horizontal Bend: Standard	2					
7		Trapeze Hanger Thu Nov 07 2024: Atkore Custom Trapeze Hanger T	7	2' - 2"	2' - 2"	P1000T	P1000T	
8								

Auto Coupling

The Auto Coupling feature is a time-saver, automatically generating and placing conduit couplings along segments or entire runs based on user-defined criteria, such as minimum and maximum segment lengths.

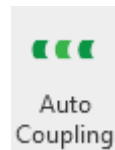

- Choose the conduit run for coupling placement.
- Click the **Auto Coupling** button.
- Choose a product and click **Next**.
- Adjust segment lengths and offsets, then confirm.

The screenshot shows the 'Auto Coupling' dialog box with two main sections:

Coupling Placement

Select your desired coupling from below:

Atkore

Compression Coupling	EMT Compression Couplings	Galvanized Steel Rigid Couplings	Liquidtight to Rigid Couplings	Malleable Liquidtight to Rigid Couplings	PVC Couplings
Rigid IMC Compression Couplings	Split Couplings	Steel EMT Raintight Compression Couplings	Steel EMT Set Screw Couplings	Three Piece Couplings	Universal Splitter Fitting
Universal Splitter Fitting 3/4 inch PC Couplings	Universal Splitter Fitting 1/2 inch PC Couplings	Universal Splitter Fitting 1/2 inch PC Couplings			

Next

Placement Detail

Please specify your desired placement detail:

Minimum segment length	1	ft	0	inch
Maximum segment length	10	ft	0	inch
Offset from elbows/bends	0	ft	6	inch

Back Confirm

Customer Feedback & Technical Support

The Atkore BIM toolbar provides a Contact button to offer customers a convenient way to connect with us:



- Feedback: Share your insights to help us improve the Atkore toolbar and digital content services.
- Contact Sales or technical support: Easily access your local sales representative's contact information.

We continuously update our digital tools and digital contents based on your feedback to provide the most efficient and user-friendly experience possible. Your opinions are invaluable to us, and we are dedicated to ensuring you have the support and resources needed for successful project completion.