

Calbond PVC Coated Conduit, Fittings & Accessories

Product Catalog



Atkore™

Calbond

Choose Calbond...

Affordable Corrosion Protection for Harsh Environments

Calbond PVC Coated Conduit, Fittings and Accessories are easy to install and require little to no maintenance. At a *fraction of the cost* of stainless steel conduit, Calbond PVC Coated Conduit provides the best protection for electrical raceway systems in extreme environments found in applications like oil and gas, mining and industrial wastewater treatment.



The Right Product for Your application:

- PVC Coated Rigid Steel and Aluminum
- UL Listed and NEMA RN -1 Compliant - no exceptions



Call a Calbond expert or visit Calbond.com to better protect your electrical raceway system. 800-225-7473

Introduction

Broadest Selection. Better Response. Best Performance.

Calbond® PVC coated conduit, fittings and accessories, offer extensive protection for electrical conduit systems placed in highly corrosive environments. All Calbond products feature a 40 mil PVC-coated exterior with a 2 mil Urethane-coated interior and threads. Every fitting incorporates our flexible overlapping sleeves, ensuring a tight seal at each connection.

Performance and Safety Tested

Calbond PVC coated rigid conduit with special bonding agent has passed the ETL SEMKO High Temperature H2O PVC Coating adhesion test and the UL series of 4 tests simulating real world weathering of PVC coated conduit. Calbond ETL-verified and UL-6 Listed PVC coated conduit will last substantially longer than non-tested conduit, and is a safer, more robust conduit system that ensures less downtime, with lower replacement costs.

Best in class quality control, count on Calbond for conduit systems expertise, best-in-class product performance and state-of-the art facilities to support today's project requirements.

Superior Corrosion Protection

Calbond's quality assurance program complies with industry standards established by UL, ANSI and NEMA:

- All Calbond products are UL Listed and NEMA RN1 compliant
- UL6 Listed with both zinc coating and PVC coating as primary coatings
- UL PVC adhesion performance tested (DYJC.E226472) where conduit is sequentially subjected to air oven conditioning and exposure test, resistance to salt spray (fog) and adhesion test of ANSI/UL6



Markets Served

Calbond's specially formulated PVC provides superior protection so that conduit systems in bridges and tunnels will hold up longer with lower maintenance costs, wastewater treatment facilities can expect less damage to pipes, tanks, pumps and electrical conduit systems, and petrochemical refining plants will experience fewer arcs, less sparking and safer day-to-day operations.



Mining Industry

The mining industry's harsh environment along with the aerobic and anaerobic microorganisms present in mining water contribute heavily to the corrosion and failure of electrical systems in modern mining. Mining facilities all over the world have come to rely on Calbond's complete line of PVC conduit, conduit bodies, device boxes, junction boxes, liquidtight connectors and hubs, fittings and accessories for the solutions that prevent threats to mining operations. Available in both galvanized rigid steel and rigid aluminum, Calbond PVC conduit systems are easy to install and proven to provide corrosion protection at a fraction of the cost of stainless steel conduit.

Markets Served

Oil & Gas Industry

Calbond conduit systems are designed to withstand extreme temperatures, harsh, toxic flammable and acidic elements, commonly found in the oil and gas industry. PVC coated conduit is often used for its affordability, ease of installation and most importantly, its ability to protect against unscheduled plant shutdowns, lost production, high maintenance repair costs and imposed fines due to corrosion. Calbond® PVC Coated Conduit Systems are highly resistant to oils, grease, acids, alkalis, and moisture making it ideal for the petrochemical industry.



Transportation and Infrastructure

Most bridges were built for a 50-year design life. Due to corrosion, now, state highway departments are faced with repairing and maintaining bridges beyond their original design lives.*

*NACE International – Highways and Bridges

Experts recommend protective and custom coating for corrosion control and maintenance on conduit systems to extend the service life of a bridge beyond its original life span. Controlling corrosion in the transportation and infrastructure market with hot dip galvanizing and advanced PVC coatings in PVC Coated conduit systems lessens the effects of costly shutdowns for repairs in infrastructure and public structures.

With ETL-verified and UL-6 Listed PVC coated conduit, including Calbond's special bonding agent and specially formulated urethane internal coating, Calbond provides the longest available product life cycle for bridges and tunnels. Proven to last substantially longer than conduit that has not passed the rigorous demands of ETL Verification testing, Calbond PVC-coated steel conduit is a safer, more robust conduit system that ensures less downtime, with lower replacement costs.



Markets Served

Wastewater and Water Treatment Plants

Wastewater treatment plants process and handle some of the most corrosive solids and liquids throughout the process engineering world. These corrosive elements cause damage to pipes, tanks, pumps and electrical conduit systems after prolonged use. Corrosion for drinking water and sewer systems creates repair costs of replacing aging infrastructure, leaks, corrosion inhibitors, external coatings for sun or heat exposure, and cathodic protection. PVC coated conduit systems from Calbond can be integrated within a system and protect the workings of the WWTP from corrosive damage.

Calbond® offers a complete line of PVC coated conduit, fittings and conduit accessories for the protection of electrical conduit systems in highly corrosive environments.

Wastewater and Water Treatment Plants benefit from PVC coated conduit systems:

- PVC coating on galvanized rigid steel and aluminum conduit
- UL listed, NEMA RN1 compliant, and ETL verified
- UL6 Listed with both zinc and PVC primary coatings, providing two layers of corrosion protection
- UL PVC adhesion performance tested (DYJC E226472)
- Specially formulated urethane internal coating provides longest available product life cycle



Conduit.....	10
Couplings	14
Elbows.....	22
Conduit Bodies.....	32
Conduit Hubs.....	50
Device Boxes.....	60
GUA Junction Boxes.....	70
Unions.....	82
Sealing Fittings.....	86
Expansion Fittings	102
Pulling Elbows.....	108
Mogul Fittings.....	112
Malleable Fittings	120
Liquidtight Connectors	126
Teck Connectors.....	140
Strut and Strut Straps	144
Strut Accessories	148
Beam Clamps.....	156
Nipples	160
Accessories and Tools	166







Conduit

ETL-Verified PVC Coated Rigid Conduit	12
PVC Coated Aluminum Conduit	13

ETL-Verified PVC Coated Rigid Conduit

Features:

- Exterior PVC coating thickness is a minimum 0.040"
- Interior urethane coating thickness is a minimum 0.002"
- Specialized corrosion resistant coating provided on threads
- Sizes available are ½" to 6"
- Color coded thread protectors
- Couplings shipped with conduit are packaged separately
- Hot Dipped Galvanized (HDG) conduit



Standards:

Calbond PVC Coated Conduit is UL Listed with both the PVC coating as a primary protection and the Hot Dipped Galvanized (HDG) zinc coating as the primary protection per UL6. PVC coated conduit is restricted for use with threaded fittings only (threadless connector not permitted).

- UL/cUL listed, File Number DYJC E226472
- ETL PVC-001 adhesion performance test verified / Cert. of Conformance Number: 104646226CRT-002
- Exceeds NEMA RN1 and ANSI C80.1 Standards

Applications:

Calbond PVC Coated Conduit is used for highly corrosive environments to protect electrical circuits in harsh environments. The coating is Intertek SEMKO ETL PVC-001 Verified for superior corrosion and mechanical protection. Ground continuity is maintained throughout the installation.

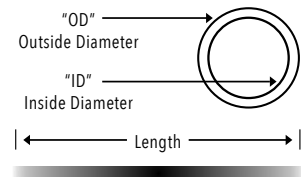

Part Number	ETL - Part Number	Trade Size (in)	Metric Size (mm)	Wall Thickness (in)	Outside Diam. w/ Coating (in)	Inside Diam. (in)	Weight / 100 (lb)	Feet/ Bundle
PV0510CT00	PV0510CT00 -E	½	16	0.104	0.920	0.632	90	1,000
PV0710CT00	PV0710CT00 -E	¾	21	0.107	1.130	0.836	119	900
PV1010CT00	PV1010CT00 -E	1	27	0.126	1.395	1.063	175	750
PV1210CT00	PV1210CT00 -E	1¼	35	0.133	1.740	1.394	237	420
PV1510CT00	PV1510CT00 -E	1½	41	0.138	1.980	1.642	281	380
PV2010CT00	PV2010CT00 -E	2	53	0.146	2.455	2.083	376	300
PV2510CT00	PV2510CT00 -E	2½	63	0.193	2.955	2.489	593	170
PV3010CT00	PV3010CT00 -E	3	78	0.205	3.580	3.090	772	140
PV3510CT00	PV3510CT00 -E	3½	91	0.215	4.080	3.570	922	110
PV4010CT00	PV4010CT00 -E	4	103	0.225	4.580	4.050	1089	110
PV5010CT00	PV5010CT00 -E	5	129	0.245	5.643	5.073	1488	80
PV6010CT00	PV6010CT00 -E	6	155	0.266	6.705	6.093	1998	50

All dimensions are for informational purposes only *Tolerances +/- 5%

PVC Coated Aluminum Conduit

Features:

- Exterior PVC coating thickness is a minimum 0.040"
- Interior urethane coating thickness is a minimum 0.002"
- Specialized corrosion resistant coating provided on threads
- Sizes available are ½" to 6"
- Color coded thread protectors
- Couplings shipped with conduit are packaged separately
- Aluminum Rigid Conduit 6061 T1



Standards:

Calbond is UL listed with both the PVC coating as a primary protection and the zinc coating as the primary protection per UL6A. PVC coated conduit is restricted for use with threaded fittings only (threadless connector not permitted).

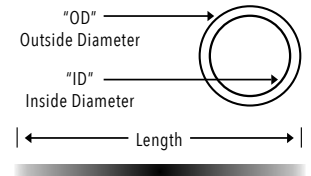

- UL/cUL listed in accordance to UL6A and ANSI C80.5
- UL/cUL listed rigid ferrous metal conduit with polyvinyl chloride coating verified for PVC adhesion performance
- Complies with NEMA RN1
- UL File Number E230584

Applications:

Calbond PVC Coated Aluminum Rigid Conduit is used for highly corrosive environments. The coating will provide corrosion protection and mechanical protection. Ground continuity is maintained throughout the installation.

Glvanized Part Number	Trade Size (in)	Metric Size (mm)	Wall Thickness (in)	Outside Diam. w/ Coating (in)	Inside Diam. (in)	Weight / 100 (lb)	Feet / Bundle
PA0510CT00	½	16	0.104	0.920	0.632	40	1000
PA0710CT00	¾	21	0.107	1.130	0.836	50	900
PA1010CT00	1	27	0.126	1.395	1.063	70	750
PA1210CT00	1¼	35	0.133	1.740	1.394	90	420
PA1510CT00	1½	41	0.138	1.980	1.642	110	380
PA2010CT00	2	53	0.146	2.455	2.083	140	300
PA2510CT00	2½	63	0.193	2.955	2.489	220	170
PA3010CT00	3	78	0.205	3.580	3.090	280	140
PA3510CT00	3½	91	0.215	4.080	3.570	340	110
PA4010CT00	4	103	0.225	4.580	4.050	370	110
PA5010CT00	5	129	0.245	5.643	5.073	490	80
PA6010CT00	6	155	0.266	6.705	6.093	620	50

All dimensions are for informational purposes only *Tolerances +/- 5%





Couplings

Rigid Couplings	16
Aluminum Rigid Couplings	17
Split Couplings	18
Reducing Couplings	19
Aluminum Reducing Couplings	20

Rigid Couplings

Features:

- Exterior PVC coating thickness is a minimum 0.040"
- Interior urethane coating thickness is a minimum 0.002"
- Sealing sleeves on both ends
- All couplings have straight threads (not tapered)
- Galvanized Ridgid Couplings

Standards:

- Ferrous electrical conduit with PVC coating:
UL File # DYJC.E226472



Applications:

Calbond PVC Coated Rigid Couplings are used to couple two lengths of conduit. PVC Coated Rigid Couplings are supplied with PVC sleeves on both ends to ensure corrosion protection for the entire system.

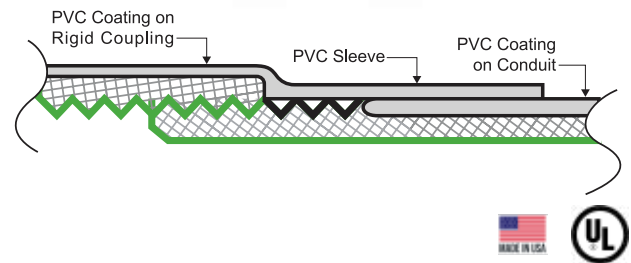

Part Number	Trade Size (in)	Metric Size (mm)	Length of Metal (in)	Threads per Inch	Weight per 100 (lb)	Box Quantity
PV0500CP00	½	16	1.500	14	19	100
PV0700CP00	¾	21	1.532	14	32	90
PV1000CP00	1	27	1.906	11½	40	75
PV1200CP00	1¼	35	1.906	11½	50	42
PV1500CP00	1½	41	1.906	11½	69	38
PV2000CP00	2	53	1.937	11½	93	30
PV2500CP00	2½	63	2.878	8	123	17
PV3000CP00	3	78	3.031	8	217	14
PV3500CP00	3½	91	3.094	8	422	11
PV4000CP00	4	103	3.188	8	391	11
PV5000CP00	5	129	3.374	8	550	8
PV6000CP00	6	155	3.437	8	884	5

All dimensions are for informational purposes only *Tolerances +/- 5%

Couplings

Aluminum Rigid Couplings

Features:

- Exterior PVC coating thickness is a minimum 0.040"
- Interior urethane coating thickness is a minimum 0.002"
- Sealing sleeves on both ends
- All couplings have straight threads (not tapered)
- 6063 T1 Aluminum Rigid Couplings

Standards:

- UL6A Listed File # E230584

Applications:

Calbond PVC Coated Rigid Aluminum Couplings are used to couple two lengths of conduit. PVC Coated Rigid Couplings are supplied with PVC sleeves on both ends to ensure corrosion protection for the entire system.

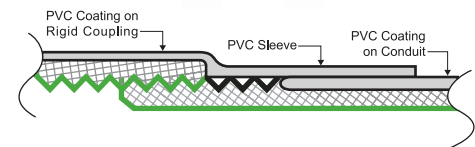

Part Number	Trade Size (in)	Metric Size (mm)	Length of Metal (in)	Threads per Inch	Weight per 100 (lb)	Box Qty
PA0500CP00	½	16	1.500	14	100	100
PA0700CP00	¾	21	1.532	14	90	90
PA1000CP00	1	27	1.906	11½	75	75
PA1200CP00	1¼	35	1.906	11½	42	42
PA1500CP00	1½	41	1.906	11½	38	38
PA2000CP00	2	53	1.937	11½	30	30
PA2500CP00	2½	63	2.878	8	17	17
PA3000CP00	3	78	3.031	8	14	14
PA3500CP00	3½	91	3.094	8	11	11
PA4000CP00	4	103	3.188	8	11	11
PA5000CP00	5	129	3.374	8	8	8
PA6000CP00	6	155	3.437	8	5	5

All dimensions are for informational purposes only *Tolerances +/- 5%



Split Couplings

Features:

- Exterior PVC coating thickness is a minimum 0.040"
- Interior urethane coating thickness is a minimum 0.002"
- Sizes available are ½" to 6"
- The length of the sleeve extension(s) shall be at least equivalent to the nominal conduit size for sizes ½" - 2"
- For sizes 2 ½" - 6", the length of the sleeve extension(s) shall be at least 2"
- Stainless steel hardware included

Standards:

- UL Standard 514B
- CSA Standard: C22.2 No. 18

Applications:

Calbond PVC Coated Split Couplings are used to connect two pieces of conduit where the conduit cannot be turned. Calbond split couplings are PVC coated for corrosion protection.



Part Number	Trade Size (in)	Metric Size (mm)
PV0500TCC1	½	20
PV0700TCC2	¾	30
PV1000TCC3	1	40
PV1200TCC4	1¼	60
PV1500TCC5	1½	70
PV2000TCC6	2	100
PV2500TCC7	2½	230
PV3000TCC8	3	300
PV3500TCC9	3½	380
PV4000TCC10	4	410
PV5000TCC12	5	600
PV6000TCC14	6	860

All dimensions are for informational purposes only *Tolerances +/- 5%

Reducing Couplings

Reducing Coupling

Features:

- Exterior PVC coating thickness is a minimum 0.040"
- Interior urethane coating thickness is a minimum 0.002"
- Steel: Sizes available are ¾" to ½" to 3"
- The length of the sleeve extension(s) shall be at least equivalent to the nominal conduit size for sizes ½"- 2". For sizes 2-½" - 2-½" - 5", the length of the sleeve extension(s) shall be at least 2"
- Sealing sleeves extender 1 pipe diameter or 2 inches, whichever is greater, beyond all female openings

Standards:

- National Electric Code/ CEC
 - REC 21 - 01210
 - Class I, Division 1 & 2, Groups A, B, C, D
 - Class III
- UL Standard: 886
- CSA Standard: C22.2 No. 30



Applications:

Calbond Reducing Couplings are used to join conduit and fittings of different sizes. They are provided with different size sleeves to match the fittings thread sizes.

Part Number	Trade Size (in)	Weight per 100 (Lb)
PV0700REC21	¾ - ½	20
PV1000REC31	1 - ½	70
PV1000REC32	1 - ¾	50
PV1200REC42	1¼ - ¾	100
PV1200REC43	1¼ - 1	80
PV1500REC52	1½ - ¾	140
PV1500REC53	1½ - 1	120
PV1500REC54	1½ - 1¼	130
PV2000REC602	2 - ¾	150
PV2000REC603	2 - 1	230
PV2000REC604	2 - 1¼	260
PV2000REC605	2 - 1½	280
PV2500REC75	2½ - 1½	320
PV3000REC86	3 - 2	370
PV3500REC97	3½ - 2½	460
PV4000REC108	4 - 3	590
PV5000REC01210	5 - 4	740

All dimensions are for informational purposes only *Tolerances +/- 5%

Aluminum Reducing Coupling

Features:

- Exterior PVC coating thickness is a minimum 0.040"
- Interior urethane coating thickness is a minimum 0.002"
- Sizes available are ¾" - 3"
- The length of the sleeve extension(s) shall be at least equivalent to the nominal conduit size for sizes ½" - 2".
- For sizes 2½" to 5", the length of the sleeve extension(s) shall be at least 2"



Standards:

- National Electric Code/ CEC
 - REC 21 - 01210
 - Class I, Division 1 & 2, Groups A, B, C, D
 - Class III
- UL Standard: 886
- CSA Standard: C22.2 No. 30

Applications:

Calbond Aluminum Reducing Couplings are used to join conduit and fittings of different sizes. They are provided with different size sleeves to match the fittings thread sizes.

Part Number	Trade Size (in)
PA0700REC21SA	¾ - ½
PA1000REC31SA	1 - ½
PA1000REC32SA	1 - ¾
PA1200REC42SA	1¼ - ¾
PA1200REC43SA	1¼ - 1
PA1500REC52SA	1½ - ¾
PA1500REC53SA	1½ - 1
PA1500REC54SA	1½ - 1¼
PA2000REC602SA	2 - ¾
PA2000REC603SA	2 - 1
PA2000REC604SA	2 - 1¼
PA2000REC605SA	2 - 1½
PA3000REC86SA	3 - 2

All dimensions are for informational purposes only *Tolerances +/- 5%





Elbows

Standard Elbows	24
Special Radius Elbows	28
Yard Elbows	30

Standard Elbows

Features:

- Exterior PVC coating thickness is a minimum 0.040"
- Interior urethane coating thickness is a minimum 0.002"
- Specialized corrosion resistant coating provided on threads
- Sizes available are ½" to 6"
- Available in 90, 60, 45, and 30 degree bends

Standards:

- UL/CUL listed in accordance to UL6 & ANSI C80.1 Standards
- UL/cUL listed rigid ferrous metal conduit with polyvinyl chloride coating verified for PVC adhesion performance
- Complies with NEMA RN1
- UL File Number E226472 (Steel)
- Alum UL E230584 (Aluminum)

Applications:

Calbond PVC Coated GRC 90° Standard Elbows are available in various degrees as required. All elbows are manufactured from Calbond PVC coated conduit and meet all applicable standards.

Options:

- Available in any degree of bend from 5° to 90°, and special radius

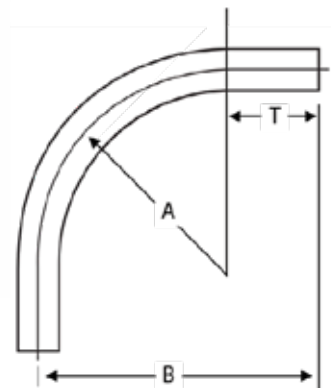

Elbows

Standard Elbows

90° Standard Elbow



Part Number	Trade Size (in)	Metric Size (mm)	A Standard Radius (in)	B Offset (in)	T Tangent (in)	Weight per 100 (lb)
Steel						
PV0590EL00	½	16	4.250	6.000	1.700	70
PV0790EL00	¾	21	4.500	6.700	2.200	100
PV1090EL00	1	27	5.750	8.000	2.400	190
PV1290EL00	1¼	35	7.250	9.600	2.800	310
PV1590EL00	1½	41	8.250	10.600	2.600	400
PV2090EL00	2	53	9.500	12.000	3.500	640
PV2590EL00	2½	63	10.500	14.800	4.700	1,210
PV3090EL00	3	78	13.000	17.000	5.300	1,950
PV3590EL00	3½	91	15.000	20.900	6.100	2,630
PV4090EL00	4	103	16.000	21.000	6.500	3,280
PV5090EL00	5	129	24.000	32.000	11.200	6,750
PV6090EL00	6	155	30.000	41.000	12.100	10,510
Aluminum						
PA0590EL00	½	16	4.25	6.0	1.7	31
PA0790EL00	¾	21	4.50	6.7	2.2	42
PA1090EL00	1	27	5.75	8.0	2.4	76
PA1290EL00	1¼	35	7.25	9.6	2.8	118
PA1590EL00	1½	41	8.25	10.6	2.6	157
PA2090EL00	2	53	9.50	12.0	3.5	238
PA2590EL00	2½	63	10.50	14.8	4.7	449
PA3090EL00	3	78	13.00	17.0	5.3	707
PA3590EL00	3½	91	15.00	20.9	6.1	970
PA4090EL00	4	103	16.00	21.0	6.5	1,114
PA5090EL00	5	129	24.00	32.0	11.2	2,223
PA6090EL00	6	155	30.00	41.0	12.1	3,261

All dimensions are for informational purposes only *Tolerances +/- 5%



Elbows

Standard Elbows

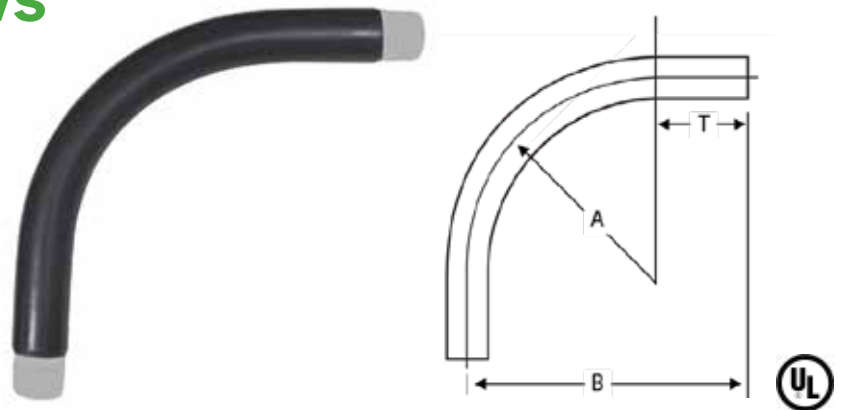

Standard Elbows

Part Number	Trade Size (in)	WEIGHT (lb)	A (in)	B (in)	C (in)	T (in)	Cut Length	Box Qty
45° Rigid Elbows								
PV0545EL00	½	0.7	4.0	7.0	2.9	1.9	8.0	50
PV0745EL00	¾	0.9	4.5	7.4	3.0	2.0	9.0	50
PV1045EL00	1	1.6	5.8	9.5	4.0	2.7	10.0	25
PV1545EL00	1½	3.8	8.3	14.0	5.8	4.3	16.5	15
PV1245EL00	1¼	2.9	7.3	13.1	5.4	4.3	15.5	20
PV2045EL00	2	5.4	9.5	16.1	6.6	5.4	18.5	10
PV2545EL00	2½	10.8	10.5	19.0	7.9	6.8	22.5	50
PV3045EL00	3	14.7	13.0	20.5	8.5	6.7	23.5	35
PV3545EL00	3½	19.5	15.0	22.8	9.5	7.1	26.0	35
PV4045EL00	4	29.3	16.0	29.2	12.1	10.5	33.5	35
PV5045EL00	5	50.2	24.0	36.1	15.0	11.2	43.0	bulk
PV6045EL00	6	77.6	30.0	42.9	17.8	12.8	48.0	bulk
30° Rigid Elbows								
PV1230EL00	1¼	2.5	7.3	12.8	3.50	4.9	13.5	Contact Factory
PV1530EL00	1½	3.3	8.3	12.1	3.25	4.3	15.0	Contact Factory
PV2030EL00	2	5.0	9.5	15.4	4.11	5.7	17.0	Contact Factory
PV2530EL00	2½	9.1	10.5	17.3	4.66	6.4	19.5	Contact Factory
PV3030EL00	3	12.5	13.0	18.8	5.05	6.6	20.0	Contact Factory
PV3530EL00	3½	17.6	15.0	22.5	6.00	8.1	24.0	Contact Factory
PV4030EL00	4	23.2	16.0	25.4	6.75	9.3	27.0	Contact Factory
PV5030EL00	5	42.0	24.0	33.9	9.12	11.7	36.0	Contact Factory
PV6030EL00	6	61.3	30.0	30.0	10.09	12.2	40.0	Contact Factory



Elbows



Part Number	Trade Size (in)	WEIGHT (lb)	A (in)	B (in)	C (in)	T (in)	Cut Length	Box Qty
22½° Rigid Elbows								
PV1222EL00	1¼	2.2	7.3	11.6	2.32	4.6	12.0	Contact Factory
PV1522EL00	1½	3	8.3	13.0	2.95	5.1	13.5	Contact Factory
PV2022EL00	2	4.5	9.5	14.9	2.95	5.9	15.5	Contact Factory
PV2522EL00	2½	6.5	10.5	13.5	2.68	4.9	14.0	Contact Factory
PV3022EL00	3	11.1	13.0	17.2	3.42	6.4	17.8	Contact Factory
PV3522EL00	3½	17.6	15.0	23.2	4.62	9.1	24.0	Contact Factory
PV4022EL00	4	22.1	16.0	24.9	4.96	9.8	25.8	Contact Factory
PV5022EL00	5	38.5	24.0	31.9	6.35	11.8	33.0	Contact Factory
PV6022EL00	6	55.2	30.0	34.8	6.91	12.2	36.0	Contact Factory
15° Rigid Elbows								
PV1215EL00	1¼	2.1	7.3	11.3	1.53	4.8	11.5	Contact Factory
PV1515EL00	1½	2.8	8.3	12.8	1.69	5.4	13.0	Contact Factory
PV2015EL00	2	4.1	9.5	13.8	1.84	5.8	14.0	Contact Factory
PV2515EL00	2½	7.5	10.5	15.8	2.08	6.6	16.0	Contact Factory
PV3015EL00	3	10.2	13.0	16.0	2.14	6.4	16.3	Contact Factory
PV3515EL00	3½	13.9	15.0	18.6	2.49	7.5	19.0	Contact Factory
PV4015EL00	4	19.7	16.0	22.7	3.00	9.4	23.0	Contact Factory
PV5015EL00	5	32.7	24.0	27.6	3.64	10.9	28.0	Contact Factory
PV6015EL00	6	49.1	30.0	31.5	4.16	12.1	32.0	Contact Factory
11-¼° Rigid Elbows								
PV1211EL00	1¼	2.0	7.3	10.9	0.98	4.8	11.0	Contact Factory
PV1511EL00	1½	2.2	8.3	9.9	1.00	4.2	10.0	Contact Factory
PV2011EL00	2	3.8	9.5	12.9	1.29	5.6	12.0	Contact Factory
PV2511EL00	2½	7.2	10.5	15.4	1.56	6.7	15.5	Contact Factory
PV3011EL00	3	10.6	13.0	16.8	1.64	7.2	17.0	Contact Factory
PV3511EL00	3½	15.4	15.0	20.8	2.07	9.0	21.0	Contact Factory
PV4011EL00	4	18.0	16.0	20.8	2.08	8.9	21.0	Contact Factory
PV5011EL00	5	30.7	24.0	26.0	2.56	10.8	26.3	Contact Factory
PV6011EL00	6	46.0	30.0	29.7	2.91	12.1	30.0	Contact Factory

All dimensions are for informational purposes only *Tolerances +/- 5%



Special Radius Elbows

Features:

- Exterior PVC coating thickness is a minimum 0.040"
- Interior Urethane coating thickness is a minimum 0.002"
- Sizes available are ½" to 6"
- Available in 90, 60, 45, and 30 degree bends

Standards:

- UL/CUL listed in accordance to UL6 & ANSI C80.1 Standards
- UL/CUL listed rigid ferrous metal conduit with polyvinyl chloride coating verified for PVC adhesion performance
- Complies with NEMA RN1
- UL File # E226472

Applications:

Calbond Coated Elbows are available in special radius dimensions and in various degrees as required. All elbows are manufactured from Calbond PVC coated conduit and meet all applicable standards.

Options:

- Available in any degree of bend from 5° to 90°, and special radius

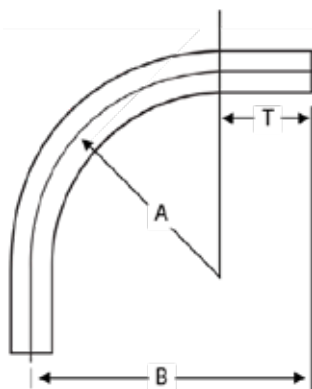

Elbows

Special Radius Elbows



Trade Size (in)	Radius															
	12 (in)				18 (in)				24 (in)				30 (in)			
	Part Number	B (in)	T (in)	Wt (lb)	Part Number	B (in)	T (in)	Wt (lb)	Part Number	B (in)	T (in)	Wt (lb)	Part Number	B (in)	T (in)	Wt (lb)
½	PV0512SW90	21	10	2.60	PV518SW90	28	11	3.6	PV0524SW90	35	11	4.1	PV530SW90	41	11	4.9
¾	PV0712SW90	21	10	3.50	PV0718SW90	28	11	4.7	PV0724SW90	35	11	5.5	PV0730SW90	41	11	6.5
1	PV1012SW90	21	10	5.00	PV1018SW90	28	11	6.0	PV1024SW90	35	11	8.0	PV1030SW90	41	11	9.0
1¼	PV1212SW90	21	10	6.00	PV1218SW90	28	11	9.0	PV1224SW90	35	11	11.0	PV1230SW90	41	11	12.0
1½	PV1512SW90	21	10	8.00	PV1518SW90	28	11	11.4	PV1524SW90	35	11	13.2	PV1530SW90	41	11	15.8
2					PV2018SW90	28	11	15.2	PV2024SW90	35	11	17.5	PV2030SW90	41	11	21.0
2½					PV2518SW90	28	11	24.3	PV2524SW90	35	11	28.0	PV2530SW90	41	11	33.6
3					PV3518SW90	28	11	32.9	PV3024SW90	35	11	38.0	PV3030SW90	41	11	4.9
3½					PV3518SW90	28	11	39.0	PV3524SW90	35	11	45.0	PV3530SW90	41	11	54.0
4									PV4024SW90	35	11	52.5	PV4030SW90	41	11	63.0

All dimensions are for informational purposes only *Tolerances +/- 5%

Trade Size (in)	Radius															
	36 (in)				42 (in)				48 (in)				60 (in)			
	Part Number	B (in)	T (in)	Wt (lb)	Part Number	B (in)	T (in)	Wt (lb)	Part Number	B (in)	T (in)	Wt (lb)	Part Number	B (in)	T (in)	Wt (lb)
½	PV0536SW90	47	11	5.5	PV0542SW90	64	12	6.2	PV0548SW90	60	12	6.9	PV560SW90	72	12	8.3
¾	PV0736SW90	47	11	7.3	PV0742SW90	64	12	8.2	PV0748SW90	60	12	9.1	PV0760SW90	72	12	11.0
1	PV1036SW90	47	11	10.0	PV1042SW90	64	12	12.0	PV1048SW90	60	12	13.0	PV1060SW90	72	12	15.0
1¼	PV1236SW90	47	11	14.0	PV1242SW90	64	12	16.0	PV1248SW90	60	12	18.0	PB1260SW90	72	12	22.0
1½	PV1536SW90	47	11	17.5	PV1542SW90	64	12	19.0	PV1548SW90	60	12	21.9	PV1560SW90	72	12	25.0
2	PV2036SW90	47	11	23.3	PV2042SW90	64	12	26.3	PV2048SW90	60	12	29.2	PV2060SW90	72	12	37.0
2½	PV2536SW90	47	11	37.3	PV542SW90	64	12	42.0	PV2548SW90	60	12	46.7	PV2560SW90	72	12	56.0
3	PV3036SW90	47	11	50.7	PV3042SW90	64	12	57.0	PV3048SW90	60	12	63.3	PV3060SW90	72	12	76.0
3½	PV3536SW90	47	11	60.0					PV3548SW90	60	12	75.0	PV3560SW90	72	12	90.0
4	PV4036SW90	47	11	70.0					PV4048SW90	60	12	87.5	PV4060SW90	72	12	105.0
5	PV5036SW90	47	11	93.3					PV5048SW90	60	12	116.7	PV5060SW90	72	12	140.0
6	PV6036SW90	47	11	123.3					PV6048SW90	60	12	156.0	PV6060SW90	72	12	185.0

All dimensions are for informational purposes only *Tolerances +/- 5%



Yard Elbows

Features:

- Exterior PVC coating thickness is a minimum 0.040"
- Interior Urethane coating thickness is a minimum 0.002"
- NPT thread with end-cap on each end
- Sizes available are ½" to 4"

Standards:

- UL/CUL listed in accordance to UL6A & ANSI C80.5 Standards
- UL/cUL listed rigid ferrous metal conduit with polyvinyl chloride coating verified for PVC adhesion performance
- Complies with NEMA RN1
- UL File # E226472

Applications:

Calbond PVC Coated Yard Elbows are used in stub up applications and feature 40 mil PVC exterior coating with 2 mil urethane coating on the interior.

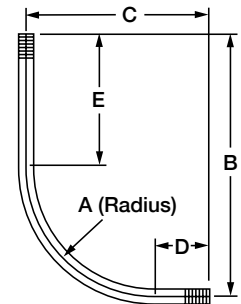

Part Number	Trade Size (in)	Metric Size (mm)	A Standard Radius (in)	B Offset (in)	T Tangent (in)	Weight per 100 (lb)
PV0590YL00	½	4.00	6.19	2.19	14.00	18.00
PV0790YL00	¾	4.50	6.75	2.25	13.50	18.00
PV1090YL00	1	5.75	8.63	2.88	12.25	18.00
PV1290YL00	1¼	7.25	10.25	3.25	12.25	19.25
PV1590YL00	1½	8.25	11.63	3.38	12.25	20.50
PV2090YL00	2	9.50	14.50	5.00	12.00	21.50
PV2590YL00	2½	10.50	16.00	5.50	12.00	22.50
PV3090YL00	3	13.00	19.25	6.25	12.00	25.00
PV3590YL00	3½	15.00	22.75	7.75	12.00	27.00
PV4090YL00	4	16.00	24.00	8.00	12.00	28.00

All dimensions are for informational purposes only *Tolerances +/- 5%





Conduit Body



Conduit Body

Conduit Bodies - Form 8	34
Conduit Bodies - Form 7	38
Conduit Bodies - Mark 9 Aluminum	42
Conduit Bodies - Form 7 Aluminum	46

Conduit Bodies - Form 8

Features:

- Exterior PVC coating thickness is a minimum 0.040"
- Interior urethane coating thickness is a minimum 0.002"
- Specialized corrosion resistant coating provided on threads
- Fittings are supplied with plastic encapsulated stainless steel screws

Standards:

- UL Standard 514B
- UL Listed File # E307133
- CSA Standard: C22.2 No. 18
- Verified NEMA 4X Rated

Applications:

Calbond offers the full line of Form 8 PVC Coated Conduit Bodies. All fittings are supplied with PVC coated cast iron covers. The sleeved threaded ends offer complete protection against corrosion while maintaining full ground continuity throughout the installed system.

C Form 8

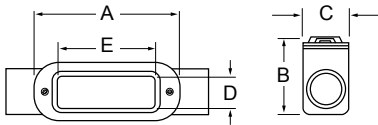

Part Number	Trade Size (in)	Metric Size (mm)	A (in)	B (in)	C (in)	D (in)	E (in)	Weight / 100 (lb)
PV0500C18	½	16	6.69	1.48	1.46	1.00	3.31	200
PV0700C28	¾	21	7.78	1.73	1.27	1.19	3.94	230
PV1000C38	1	27	9.31	1.98	1.83	1.38	4.56	280
PV1200C448	1¼	35	9.94	2.42	2.27	1.75	5.31	450
PV1500C58	1½	41	11.00	2.82	2.83	2.13	6.50	650
PV2000C68	2	53	13.38	3.60	3.83	3.00	8.56	1,030
PV2500C78	2½	63	17.63	4.48	5.08	4.25	10.88	1,800
PV3000C88	3	78	17.63	4.85	5.08	4.25	10.88	2,050
PA3500C989	3½	91	20.75	5.73	6.33	5.44	13.44	1,000
PA4000C1089	4	103	20.75	5.73	6.33	5.44	13.44	1,200

All dimensions are for informational purposes only *Tolerances +/- 5%



Conduit Bodies - Form 8

LB Form 8

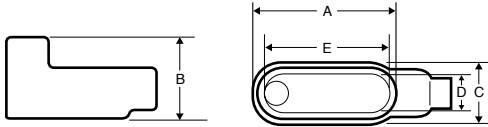

Part Number	Trade Size (in)	Metric Size (mm)	A (in)	B (in)	C (in)	D (in)	E (in)	Weight / 100 (lb)
PV0500LB18	½	16	5.48	2.26	1.42	1.00	3.31	150
PV0700LB28	¾	21	6.35	2.48	1.60	1.19	3.94	200
PV1000LB38	1	27	7.51	2.85	1.79	1.38	4.56	290
PV1200LB48	1¼	35	8.82	3.38	2.23	1.75	5.31	410
PV1500LB58	1½	41	10.67	4.07	2.79	2.13	6.50	650
PV2000LB68	2	53	13.04	4.85	3.79	3.00	8.56	829
PV2500LB78	2½	63	15.98	6.17	5.04	4.25	10.88	1,820
PV3000LB888	3	78	15.98	6.54	5.04	4.25	10.88	2,120
PV3500LB98	3½	91	14.73	7.60	6.29	5.44	13.44	3,120
PV4000LB108	4	103	14.73	7.85	6.29	5.44	13.44	3,200

All dimensions are for informational purposes only *Tolerances +/- 5%



LL Form 8

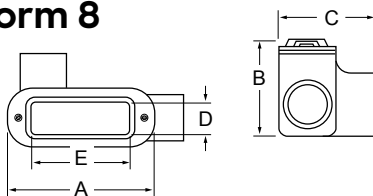

Part Number	Trade Size (in)	Metric Size (mm)	A (in)	B (in)	C (in)	D (in)	E (in)	Weight / 100 (lb)
PV0500LL18	½	16	5.48	1.48	2.20	1.00	3.31	140
PV0700LL28	¾	21	6.35	1.73	2.35	1.19	3.94	210
PV1000LL38	1	27	7.51	1.98	2.67	1.38	4.56	260
PV1200LL48	1¼	35	8.82	2.42	3.20	1.75	5.31	420
PV1500LL58	1½	41	10.67	2.82	4.04	2.13	6.50	620
PV2000LL68	2	53	13.04	3.60	5.04	3.00	8.56	1,050
PV2500LL78	2½	63	15.98	4.48	6.73	4.25	10.88	1,900
PV3000LL88	3	78	15.98	4.85	6.73	4.25	10.88	2,150
PA3500LL989	3½	91	14.73	4.92	6.98	4.50	10.25	2,150
PA4000LL1089	4	103	14.73	5.42	6.98	4.50	10.25	2,450

All dimensions are for informational purposes only *Tolerances +/- 5%



LR Form 8

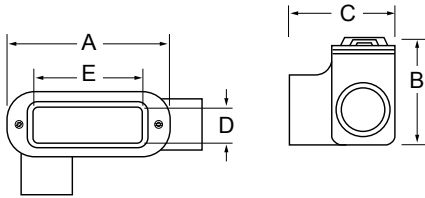

Part Number	Trade Size (in)	Metric Size (mm)	A (in)	B (in)	C (in)	D (in)	E (in)	Weight / 100 (lb)
PV0500LR18	½	16	5.48	1.48	2.20	1.00	3.31	140
PV0700LR28	¾	21	6.35	1.73	2.35	1.19	3.94	210
PV1000LR38	1	27	7.51	1.98	2.67	1.38	4.56	260
PV1200LR48	1¼	35	8.82	2.42	3.20	1.75	5.31	450
PV1500LR58	1½	41	10.67	2.82	4.04	2.13	6.50	620
PV2000LR68	2	53	13.04	3.60	5.04	3.00	8.56	1,070
PV2500LR78	2½	63	15.98	4.48	6.73	4.25	10.88	1,770
PV3000LR88	3	78	15.98	4.85	6.73	4.25	10.88	1,800
PA3500LR989	3½	91	14.73	4.92	6.98	4.50	10.25	2,100
PA4000LR1089	4	103	14.73	5.42	6.98	4.50	10.25	2,400

All dimensions are for informational purposes only *Tolerances +/- 5%

T Form 8

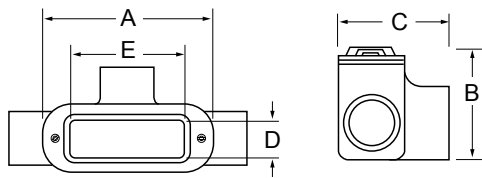

Part Number	Trade Size (in)	Metric Size (mm)	A (in)	B (in)	C (in)	D (in)	E (in)	Weight / 100 (lb)
PV0500T18	½	16	6.69	1.79	2.20	1.00	3.31	180
PV0700T28	¾	21	2.50	2.04	2.35	1.19	3.94	250
PV1000T38	1	27	3.30	2.29	2.67	1.38	4.56	330
PV1200T48	1¼	35	1.90	2.67	3.20	1.75	5.31	490
PV1500T58	1½	41	7.50	2.82	4.04	2.13	6.50	750
PV2000T68	2	53	11.70	3.60	5.04	3.00	8.56	1,170
PV2500T78	2½	63	19.80	4.48	6.73	4.25	10.88	1,980
PV3000T88	3	78	23.10	4.85	6.73	4.25	10.88	2,100
PA3500T989	3½	91	21.00	5.73	8.17	5.44	13.44	2,350
PA4000T1089	4	103	24.00	5.98	8.17	5.44	13.44	2,400

All dimensions are for informational purposes only *Tolerances +/- 5%

Conduit Bodies - Form 8

TB Form 8

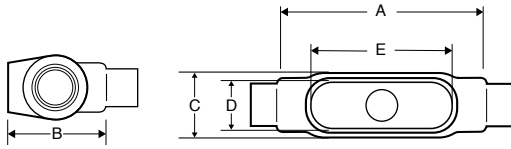

Part Number	Trade Size (in)	Metric Size (mm)	A (in)	B (in)	C (in)	D (in)	E (in)	Weight / 100 (lb)
PV0500TB18	½	16	6.69	3.57	1.46	1.00	3.31	200
PV0700TB28	¾	21	7.78	3.79	1.64	1.19	3.94	230
PV1000TB38	1	27	9.31	4.17	1.83	1.38	4.56	310
PV1200TB48	1¼	35	11.00	4.38	2.27	1.75	5.31	520
PV1500TB58	1½	41	13.38	5.08	2.83	2.13	6.50	700
PV2000TB68	2	53	16.25	5.85	3.83	3.00	8.56	1,100

All dimensions are for informational purposes only *Tolerances +/- 5%



X Form 8

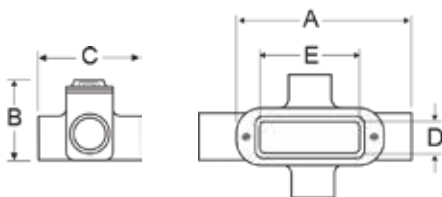

Part Number	Trade Size (in)	Metric Size (mm)	A (in)	B (in)	C (in)	D (in)	E (in)	Weight / 100 (lb)
PV0500X18	½	16	6.69	3.91	1.79	1.00	3.31	200
PV0700X28	¾	21	7.89	4.56	2.04	1.19	3.94	260
PV1000X38	1	27	9.31	5.50	2.29	1.38	4.56	310
PV1200X48	1¼	35	11.00	6.63	2.67	1.75	5.31	520
PV1500X58	1½	41	13.38	8.25	2.51	2.13	6.50	750
PV2000X68	2	53	16.25	10.25	3.60	3.00	8.56	1,170

All dimensions are for informational purposes only *Tolerances +/- 5%



Conduit Bodies - Form 7

Features:

- Exterior PVC coating thickness is a minimum 0.040"
- Interior urethane coating thickness is a minimum 0.002"
- Specialized corrosion resistant coating provided on threads
- Fittings are supplied with plastic encapsulated stainless steel screws

Standards:

- UL Standard 514B
- CSA Standard: C22.2 No. 18

Applications:

Calbond offers the full line of C Form 7 PVC Coated Conduit Bodies. Conduit Bodies are installed in conduit systems to; act as pull outlets for conductors being installed, provide openings for making splices in conductors, and to provide access to conductors for maintenance and future system changes. All fittings are supplied with PVC coated cast iron covers. The sleeved threaded ends offer complete protection against corrosion while maintaining full ground continuity throughout the installed system.

C Form 7

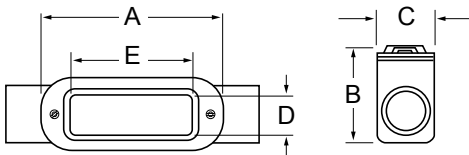

Part Number	Trade Size (in)	Metric Size (mm)	A (in)	B (in)	C (in)	D (in)	E (in)	Weight / 100 (lb)
PV0500C17	½	16	6.38	1.42	1.46	0.94	3.19	100
PV0700C27	¾	21	7.50	1.67	1.64	1.13	3.81	140
PV1000C37	1	27	9.00	1.92	1.83	1.38	4.50	220
PV1200C47	1¼	35	9.94	2.35	2.27	1.75	5.00	270
PV1500C57	1½	41	11.19	2.60	2.52	1.94	5.44	400
PV2000C67	2	53	11.19	3.17	3.08	2.44	6.38	550
PV2500C77	2½	63	14.00	3.67	4.33	3.56	8.38	1,000
PV3000C87	3	78	13.75	4.42	4.33	3.56	8.38	1,180

All dimensions are for informational purposes only *Tolerances +/- 5%



Conduit Bodies - Form 7

LB Form 7

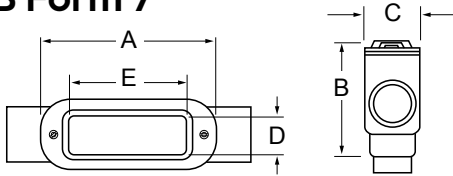

Part Number	Trade Size (in)	Metric Size (mm)	A (in)	B (in)	C (in)	D (in)	E (in)	Weight / 100 (lb)
PV0500LB17	½	16	5.10	2.29	1.42	0.94	3.19	110
PV0700LB27	¾	21	5.98	2.54	1.60	1.13	3.81	170
PV1000LB37	1	27	7.01	2.92	1.79	1.38	4.50	220
PV1200LB47	1¼	35	7.79	3.35	2.23	1.75	5.00	310
PV1500LB57	1½	41	8.67	3.73	2.48	1.94	5.44	380
PV2000LB67	2	53	10.17	4.29	3.04	2.44	6.38	520
PV2500LB777	2½	63	12.54	5.17	4.29	3.56	8.38	1,000
PV3000LB87	3	78	12.54	5.92	4.29	3.56	8.38	1,300
PV3500LB97	3½	91	14.73	6.60	5.29	4.50	10.25	1,900
PV4000LB107	4	103	14.73	7.10	5.29	4.50	10.25	1,850

All dimensions are for informational purposes only *Tolerances +/- 5%



LL Form 7

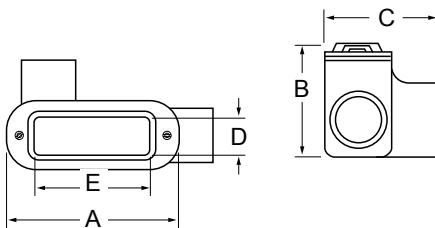

Part Number	Trade Size (in)	Metric Size (mm)	A (in)	B (in)	C (in)	D (in)	E (in)	Weight / 100 (lb)
PV0500LL17	½	16	5.10	1.42	2.29	0.94	3.19	120
PV0700LL27	¾	21	5.98	1.67	2.48	1.13	3.81	160
PV1000LL37	1	27	7.04	1.92	2.49	1.38	4.50	210
PV1200LL47	1¼	35	7.79	2.35	3.23	1.75	5.00	300
PV1500LL57	1½	41	8.67	2.60	3.60	1.94	5.44	410
PV2000LL67	2	53	10.17	3.17	4.17	2.44	6.38	570
PV2500LL777	2½	63	12.54	3.67	5.79	3.56	8.38	1,000
PV3000LL87	3	78	12.54	4.42	5.79	3.56	8.38	1,270
PV3500LL97	3½	91	14.73	4.92	6.98	4.50	10.25	1,900
PV4000LL107	4	103	14.73	5.42	6.98	4.50	10.25	1,900

All dimensions are for informational purposes only *Tolerances +/- 5%



LR Form 7

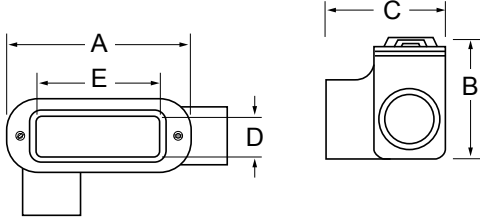

Part Number	Trade Size (in)	Metric Size (mm)	A (in)	B (in)	C (in)	D (in)	E (in)	Weight / 100 (lb)
PV0500LR17	½	16	5.10	1.42	2.29	0.94	3.19	120
PV0700LR27	¾	21	5.98	1.67	2.49	1.13	3.81	160
PV1000LR37	1	27	7.04	1.92	2.79	1.38	4.50	210
PV1200LR47	1¼	35	7.79	2.35	3.23	1.75	5.00	300
PV1500LR57	1½	41	8.67	2.60	3.60	1.94	5.44	410
PV2000LR67	2	53	10.17	3.17	4.17	2.44	6.38	570
PV2500LR777	2½	63	12.54	3.67	5.79	3.56	8.38	1,000
PV3000LR87	3	78	12.54	4.42	5.79	3.56	8.38	1,270
PV3500LR97	3½	91	14.73	4.42	6.98	4.50	10.25	1,900
PV4000LR107	4	103	14.73	5.42	6.98	4.50	10.25	1,900

All dimensions are for informational purposes only *Tolerances +/- 5%



T Form 7

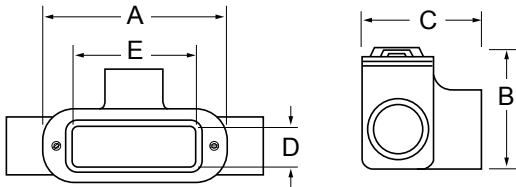

Part Number	Trade Size (in)	Metric Size (mm)	A (in)	B (in)	C (in)	D (in)	E (in)	Weight / 100 (lb)
PV0500T17	½	16	6.63	1.79	2.48	0.94	3.19	150
PV0700T27	¾	21	7.75	2.04	2.67	1.13	3.81	210
PV1000T37	1	27	9.25	2.29	3.04	1.38	4.50	290
PV1200T47	1¼	35	9.94	2.35	3.23	1.75	5.00	360
PV1500T57	1½	41	11.19	2.60	3.60	1.94	5.44	450
PV2000T67	2	53	13.19	3.17	4.17	2.44	6.38	650
PV2500T777	2½	63	16.00	3.67	5.79	3.56	8.38	1,070
PV3000T87	3	78	16.06	4.42	5.79	3.56	8.38	1,540
PV3500T97	3½	91	18.31	4.92	6.98	4.50	10.25	1,900
PV4000T107	4	103	18.31	5.42	6.98	4.50	10.25	2,100

All dimensions are for informational purposes only *Tolerances +/- 5%



Conduit Bodies - Form 7

TB Form 7

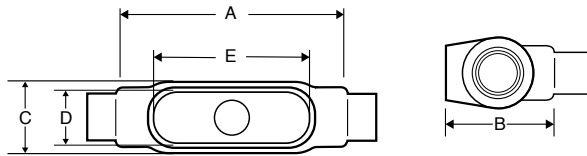

Part Number	Trade Size (in)	Metric Size (mm)	A (in)	B (in)	C (in)	D (in)	E (in)	Weight / 100 (lb)
PV0500TB17	½	16	6.63	2.67	1.64	0.94	3.19	160
PV0700TB27	¾	21	7.75	2.92	1.83	1.13	3.81	210
PV1000TB37	1	27	9.25	3.29	2.08	1.38	4.50	270
PV1200TB47	1¼	35	9.94	3.35	2.27	1.75	5.00	370
PV1500TB57	1½	41	11.19	5.04	2.52	1.94	5.44	470
PV2000TB67	2	53	13.19	6.17	3.08	2.44	6.38	700

All dimensions are for informational purposes only *Tolerances +/- 5%



X Form 7

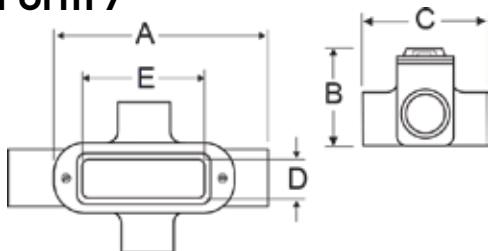

Part Number	Trade Size (in)	Metric Size (mm)	A (in)	B (in)	C (in)	D (in)	E (in)	Weight / 100 (lb)
PV0500X17SA	½	16	6.63	3.35	1.79	0.94	3.19	170
PV0700X27SA	¾	21	7.75	3.54	2.04	1.13	3.81	240
PV1000X37SA	1	27	9.25	4.04	2.29	1.38	4.50	270
PV1200X47SA	1¼	35	9.94	4.17	2.35	1.75	5.00	360
PV1500X57SA	1½	41	11.19	4.67	2.60	1.94	5.44	500
PV2000X67SA	2	53	13.90	5.23	3.17	2.44	6.38	750

All dimensions are for informational purposes only *Tolerances +/- 5%



Conduit Bodies - Mark 9 Aluminum

Mark 9 Aluminum

Features:

- Exterior PVC coating thickness is a minimum 0.040"
- Interior urethane coating thickness is a minimum 0.002"
- Specialized corrosion resistant coating provided on threads
- Fittings are supplied with plastic encapsulated stainless steel screws

Standards:

- UL Standard 514B
- CSA Standard: C22.2 No. 18

Applications:

Calbond offers the full line of Mark 9 PVC Coated Aluminum Conduit Bodies. All fittings are supplied with PVC coated aluminum covers. The sleeved threaded ends offer complete protection against corrosion while maintaining full ground continuity throughout the installed system.

C Mark 9 Aluminum

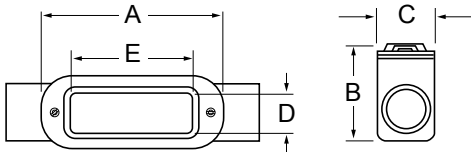

Aluminum Part Number	Trade Size (in)	Metric Size (mm)	A (in)	B (in)	C (in)	D (in)	E (in)
PA0500C19	½	16	6.69	1.48	1.46	1.00	3.31
PA0700C29	¾	21	7.78	1.73	1.27	1.19	3.94
PA1000C39	1	27	9.31	1.98	1.83	1.38	4.56
PA1200C49	1¼	35	11.00	2.42	2.27	1.75	5.31
PA1500C59	1½	41	13.38	2.82	2.83	2.13	6.50
PA2000C69	2	53	14.25	3.60	3.83	3.00	8.56
PA2500C789	2½	63	17.63	4.48	5.08	4.25	10.88
PA3000C889	3	78	17.63	4.85	5.08	4.25	10.88
PA3500C989	3½	91	20.75	5.73	6.33	5.44	13.44
PA4000C1089	4	103	20.75	5.73	6.33	5.44	13.44

All dimensions are for informational purposes only *Tolerances +/- 5%



Conduit Bodies - Mark 9 Aluminum

LB Mark 9 Aluminum

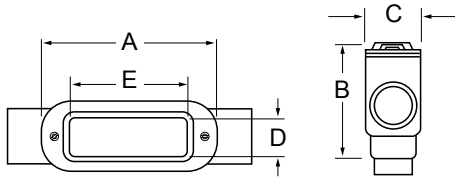

Aluminum Part Number	Trade Size (in)	Metric Size (mm)	A (in)	B (in)	C (in)	D (in)	E (in)
PA0500LB19	½	16	5.48	2.26	1.42	1.00	3.31
PA0700LB29	¾	21	6.35	2.48	1.60	1.19	3.94
PA1000LB39	1	27	7.51	2.85	1.79	1.38	4.56
PA1200LB49	1¼	35	8.82	3.38	2.23	1.75	5.31
PA1500LB59	1½	41	10.67	4.07	2.79	2.13	6.50
PA2000LB69	2	53	13.04	4.85	3.79	3.00	8.56
PA2500LB789	2½	63	15.98	6.17	5.04	4.25	10.88
PA3000LB889	3	78	15.98	6.54	5.04	4.25	10.88
PA3500LB989	3½	91	14.73	7.60	6.29	5.44	13.44
PA4000LB1089	4	103	14.73	7.85	6.29	5.44	13.44



All dimensions are for informational purposes only *Tolerances +/- 5%

LL Mark 9 Aluminum

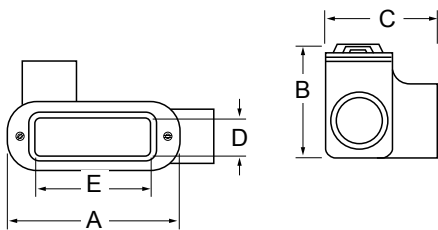

Part Number	Trade Size (in)	Metric Size (mm)	A (in)	B (in)	C (in)	D (in)	E (in)
PA0500LL19	½	16	5.48	1.48	2.20	1.00	3.31
PA0700LL29	¾	21	6.35	1.73	2.35	1.19	3.94
PA1000LL39	1	27	7.51	1.98	2.77	1.38	4.56
PA1200LL49	1¼	35	8.82	2.42	3.20	1.75	5.31
PA1500LL59	1½	41	10.67	2.82	4.04	2.13	6.50
PA2000LL69	2	53	13.04	3.60	5.04	3.00	8.56
PA2500LL789	2½	63	15.98	4.48	6.73	4.25	10.88
PA3000LL889	3	78	15.98	4.85	6.73	4.25	10.88
PA3500LL989	3½	91	14.73	4.92	6.98	4.50	10.25
PA4000LL1089	4	103	14.73	5.42	6.98	4.50	10.25



All dimensions are for informational purposes only *Tolerances +/- 5%

Conduit Bodies - Mark 9 Aluminum

LR Mark 9 Aluminum

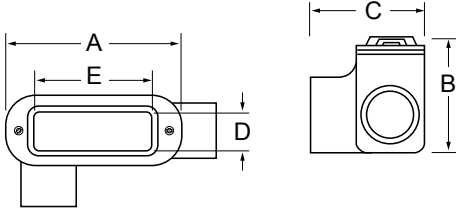

Part Number	Trade Size (in)	Metric Size (mm)	A (in)	B (in)	C (in)	D (in)	E (in)
PA0500LL19	½	16	5.48	1.48	2.20	1.00	3.31
PA0700LL29	¾	21	6.35	1.73	2.35	1.19	3.94
PA1000LL39	1	27	7.51	1.98	2.67	1.38	4.56
PA1200LL49	1¼	35	8.82	2.42	3.20	1.75	5.31
PA1500LL59	1½	41	10.67	2.82	4.04	2.13	6.50
PA2000LL69	2	53	13.04	3.60	5.04	3.00	8.56
PA2500LL789	2½	63	15.98	4.48	6.73	4.25	10.88
PA3000LL889	3	78	15.98	4.85	6.73	4.25	10.88
PA3500LL989	3½	91	14.73	4.92	6.98	4.50	10.25
PA4000LL1089	4	103	14.73	5.42	6.98	4.50	10.25



All dimensions are for informational purposes only *Tolerances +/- 5%

T Mark 9 Aluminum

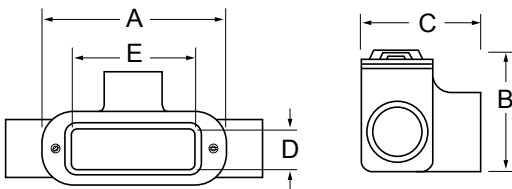

Part Number	Trade Size (in)	Metric Size (mm)	A (in)	B (in)	C (in)	D (in)	E (in)
PA0500T19	½	16	6.69	1.79	2.20	1.00	3.31
PA0700T29	¾	21	2.50	2.04	2.35	1.19	3.94
PA1000T39	1	27	3.30	2.29	2.67	1.38	4.56
PA1200T49	1¼	35	1.90	2.67	3.20	1.75	5.31
PA1500T59	1½	41	7.50	2.82	4.04	2.13	6.50
PA2000T69	2	53	11.70	3.60	5.04	3.00	8.56
PA2500T789	2½	63	19.80	4.48	6.73	4.25	10.88
PA3000T889	3	78	23.10	4.85	6.73	4.25	10.88
PA3500T989	3½	91	21.00	5.73	8.17	5.44	13.44
PA4000T1089	4	103	24.00	5.98	8.17	5.44	13.44



All dimensions are for informational purposes only *Tolerances +/- 5%

Conduit Bodies - Mark 9 Aluminum

TB Mark 9 Aluminum

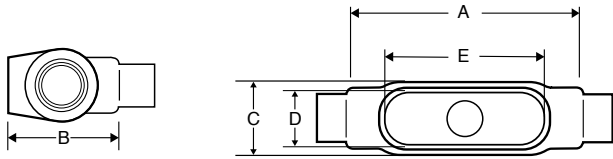

Part Number	Trade Size (in)	Metric Size (mm)	A (in)	B (in)	C (in)	D (in)	E (in)
PA0500TB19	½	16	6.69	1.48	1.46	1.00	3.31
PA0700TB29	¾	21	7.78	1.73	1.27	1.19	3.94
PA1000TB39	1	27	9.31	4.17	1.83	1.38	4.56
PA1200TB49	1¼	35	11.00	4.38	2.27	1.75	5.31
PA1500TB59	1½	41	13.38	5.08	2.83	2.13	6.50
PA2000TB69	2	53	14.25	3.83	3.83	3.00	8.56

All dimensions are for informational purposes only *Tolerances +/- 5%



X Mark 9 Aluminum

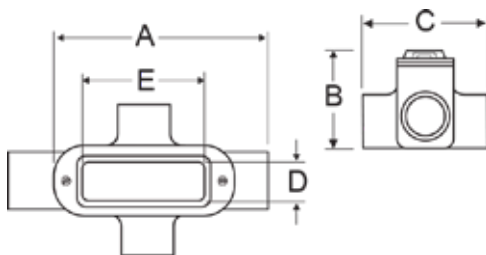

Part Number	Trade Size (in)	Metric Size (mm)	A (in)	B (in)	C (in)	D (in)	E (in)
PA0500X19	½	16	6.69	3.91	1.79	1.00	3.31
PA0700X29	¾	21	7.89	4.56	2.04	1.19	3.94
PA1000X39	1	27	9.31	5.50	2.29	1.38	4.56
PA1200X49	1¼	35	11.00	6.63	2.67	1.75	5.31
PA1500X59	1½	41	13.38	8.25	2.51	2.13	6.50
PA2000X69	2	53	16.25	10.25	3.60	3.00	8.56

All dimensions are for informational purposes only *Tolerances +/- 5%



Conduit Bodies - Form 7 Aluminum

Form 7 Aluminum

Features:

- Exterior PVC coating thickness is a minimum 0.040"
- Interior urethane coating thickness is a minimum 0.002"
- Specialized corrosion resistant coating provided on threads
- Sizes available are ½" to 3"
- Fittings are supplied with plastic encapsulated stainless steel screws

Standards:

- UL Standard 514B
- CSA Standard: C22.2 No. 18

Applications:

Calbond offers the full line of Form 7 PVC Coated Aluminum Conduit Bodies. Conduit Bodies are installed in conduit systems to; act as pull outlets for conductors being installed, provide openings for making splices in conductors, and to provide access to conductors for maintenance and future system changes. All fittings are supplied with PVC coated cast aluminum covers. The sleeved threaded ends offer complete protection against corrosion while maintaining full ground continuity throughout the installed system.

C Form 7 Aluminum

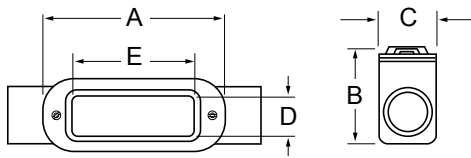

Part Number	Trade Size (in)	Metric Size (mm)	A (in)	B (in)	C (in)	D (in)	E (in)
PA0500C17SA	½	16	6.38	1.42	1.46	0.94	3.19
PA0700C27SA	¾	21	7.50	1.67	1.64	1.13	3.81
PA1000C37SA	1	27	9.00	1.92	1.83	1.38	4.50
PA1200C47SA	1¼	35	9.94	2.35	2.27	1.75	5.00
PA1500C57SA	1½	41	11.19	2.60	2.52	1.94	5.44
PA2000C67SA	2	53	11.19	3.17	3.08	2.44	6.38
PA2500C77SA	2½	63	14.00	3.67	4.33	3.56	8.38
PA3000C87SA	3	78	13.75	4.42	4.33	3.56	8.38

All dimensions are for informational purposes only *Tolerances +/- 5%



Conduit Bodies - Form 7 Aluminum

LL Form 7 Aluminum

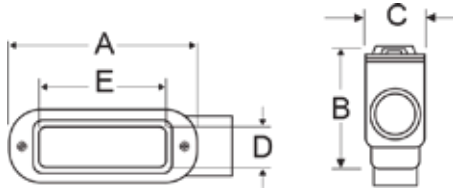

Part Number	Trade Size (in)	Metric Size (mm)	A (in)	B (in)	C (in)	D (in)	E (in)
PA0500LB17SA	½	16	5.10	2.29	1.42	0.94	3.19
PA0700LB27SA	¾	21	5.98	2.54	1.60	1.13	3.81
PA1000LB37SA	1	27	7.01	2.92	1.79	1.38	4.50
PA1200LB47SA	1¼	35	7.79	3.35	2.23	1.75	5.00
PA1500LB57SA	1½	41	8.67	3.73	2.48	1.94	5.44
PA2000LB67SA	2	53	10.17	4.29	3.04	2.44	6.38
PA2500LB77SA	2½	63	12.54	5.17	4.29	3.56	8.38
PA3000LB87SA	3	78	12.54	5.92	4.29	3.56	8.38
PA3500LB97SA	3½	91	14.73	6.60	5.29	4.50	10.25
PA4000LB107SA	4	103	14.73	7.10	5.29	4.50	10.25



All dimensions are for informational purposes only *Tolerances +/- 5%

LL Form 7 Aluminum

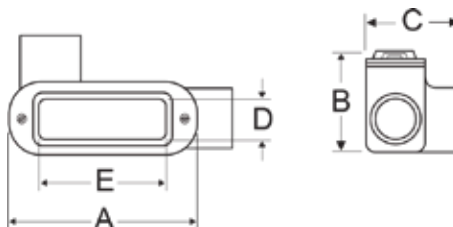

Part Number	Trade Size (in)	Metric Size (mm)	A (in)	B (in)	C (in)	D (in)	E (in)
PA0500LL17SA	½	16	5.10	1.42	2.29	0.94	3.19
PA0700LL27SA	¾	21	5.98	1.67	2.48	1.13	3.81
PA1000LL37SA	1	27	7.04	1.92	2.49	1.38	4.50
PA1200LL47SA	1¼	35	7.79	2.35	3.23	1.75	5.00
PA1500LL57SA	1½	41	8.67	2.60	3.60	1.94	5.44
PA2000LL67SA	2	53	10.17	3.17	4.17	2.44	6.38
PA2500LL77SA	2½	63	12.54	3.67	5.79	3.56	8.38
PA3000LL87SA	3	78	12.54	4.42	5.79	3.56	8.38
PA3500LL97SA	3½	91	14.73	4.92	6.98	4.50	10.25
PA4000LL107SA	4	103	14.73	5.42	6.98	4.50	10.25



All dimensions are for informational purposes only *Tolerances +/- 5%



Conduit Bodies - Form 7 Aluminum

LR Form 7 Aluminum

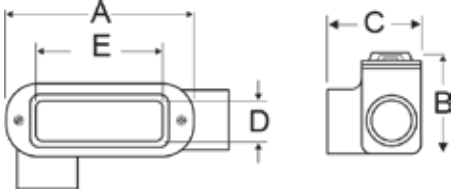

Part Number	Trade Size (in)	Metric Size (mm)	A (in)	B (in)	C (in)	D (in)	E (in)
PA0500LR17SA	½	16	5.10	1.42	2.29	0.94	3.19
PA0700LR27SA	¾	21	5.98	1.67	2.48	1.13	3.81
PA1000LR37SA	1	27	7.04	1.92	2.49	1.38	4.50
PA1200LR47SA	1¼	35	7.79	2.35	3.23	1.75	5.00
PA1500LR57SA	1½	41	8.67	2.60	3.60	1.94	5.44
PA2000LR67SA	2	53	10.17	3.17	4.17	2.44	6.38
PA2500LR77SA	2½	63	12.54	3.67	5.79	3.56	8.38
PA3000LR87SA	3	78	12.54	4.42	5.79	3.56	8.38
PA3500LR97SA	3½	91	14.73	4.92	6.98	4.50	10.25
PA4000LR107SA	4	103	14.73	5.42	6.98	4.50	10.25



All dimensions are for informational purposes only *Tolerances +/- 5%

T Form 7 Aluminum

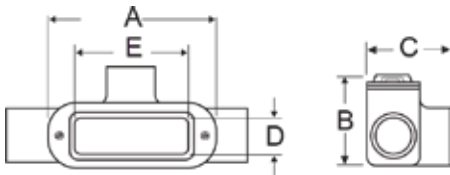

Part Number	Trade Size (in)	Metric Size (mm)	A (in)	B (in)	C (in)	D (in)	E (in)
PA0500T17SA	½	16	6.63	1.79	2.48	0.94	3.19
PA0700T27SA	¾	21	7.75	2.04	2.67	1.13	3.81
PA1000T37SA	1	27	9.25	2.29	3.04	1.38	4.50
PA1200T47SA	1¼	35	9.94	2.35	3.23	1.75	5.00
PA1500T57SA	1½	41	11.19	2.60	3.60	1.94	5.44
PA2000T67SA	2	53	13.19	3.17	4.17	2.44	6.38
PA2500T777SA	2½	63	16.00	3.67	5.79	3.56	8.38
PA3000T87SA	3	78	16.06	4.42	5.79	3.56	8.38
PA3500T97SA	3½	91	18.31	4.92	6.98	4.50	10.25
PA4000T107SA	4	103	18.31	5.42	6.98	4.50	10.25



All dimensions are for informational purposes only *Tolerances +/- 5%

Conduit Bodies - Form 7 Aluminum

TB Form 7 Aluminum

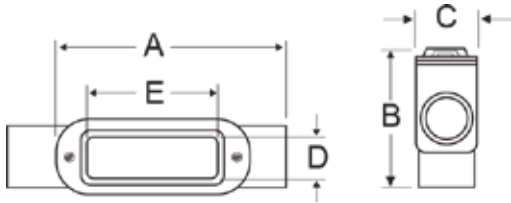

Part Number	Trade Size (in)	Metric Size (mm)	A (in)	B (in)	C (in)	D (in)	E (in)
PA0500TB17SA	½	16	6.63	2.67	1.64	0.94	3.19
PA0700TB27SA	¾	21	7.75	2.92	1.83	1.13	3.81
PA1000TB37SA	1	27	9.25	3.29	2.08	1.38	4.50
PA1200TB47SA	1¼	35	9.94	3.35	2.27	1.75	5.00
PA1500TB57SA	1½	41	11.19	5.04	2.52	1.94	5.44
PA2000TB67SA	2	53	13.19	6.17	3.08	2.44	6.38

All dimensions are for informational purposes only *Tolerances +/- 5%



X Form 7 Aluminum

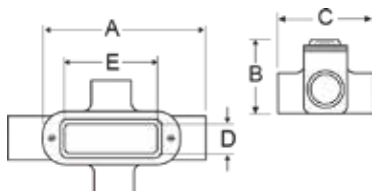

Part Number	Trade Size (in)	Metric Size (mm)	A (in)	B (in)	C (in)	D (in)	E (in)
PA0500X17SA	½	16	6.63	3.35	1.79	0.94	3.19
PA0700X27SA	¾	21	7.75	3.54	2.04	1.13	3.81
PA1000X37SA	1	27	9.25	4.04	2.29	1.38	4.50
PA1200X47SA	1¼	35	9.94	4.17	2.35	1.75	5.00
PA1500X57SA	1½	41	11.19	4.67	2.60	1.94	5.44
PA2000X67SA	2	53	13.19	5.23	3.17	2.44	6.38

All dimensions are for informational purposes only *Tolerances +/- 5%





Conduit Hubs



Conduit Hubs

ST Conduit Hubs	52
ST Aluminum Conduit Hubs	53
STG Conduit Hubs	54
STG Aluminum Conduit Hubs	55
STTB Conduit Hubs	56
STTB Aluminum Conduit Hubs	57
STTTB Conduit Hubs	58
STTTB Aluminum Conduit Hubs	59

ST Conduit Hubs

Features:

- Exterior PVC coating thickness is a minimum 0.040"
- Interior urethane coating thickness is a minimum 0.002"
- ST available in 12 trade sizes from ½" through 6"
- Sealing sleeves on conduit side of hub
- The length of the sleeve extension(s) shall be at least equivalent to the nominal conduit size for sizes ½"- 2"
- For sizes 2½"- 6", the length of the sleeve extension(s) shall be at least 2"



Standards:

- UL Listed File #E308159
- NEC/CEC:
 - Class I, Division 2,
 - Class II, Division 1 & 2
 - Class III, Division 1 & 2
 - Class I, Zone 1, AEx e II
 - Class I, Zone 1, Ex e II
- All Screw-tight Hubs are manufactured in accordance with NEMA type enclosures 2, 3, 3R, 4, 4x, 11 and 12

Applications:

Calbond PVC Conduit Hubs are used to terminate conduit runs into electrical enclosures. PVC coating and internal urethane coating provide for superior corrosion protection. Electrical continuity is maintained across assembled joints.

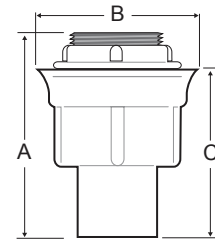

Part Number	Trade Size (in)	A (in)	B (in)	C (in)	Max Wall Thickness (in)	Weight Per 100 (lb)
PV0500ST1	½	1.84	2.00	1.31	0.125	20
PV0700ST2	¾	2.22	2.25	1.66	0.125	30
PV1000ST3	1	2.66	2.50	2.03	0.125	40
PV1200ST4	1¼	2.94	3.25	2.28	0.125	40
PV1500ST5	1½	3.19	3.50	2.53	0.125	60
PV2000ST6	2	3.75	4.25	3.09	0.125	120
PV2500ST7	2½	4.22	4.75	3.28	0.125	150
PV3000ST8	3	4.31	5.25	3.38	0.125	210
PV3500ST9	3½	4.38	5.50	3.44	0.125	300
PV4000ST10	4	4.44	6.25	3.50	0.125	350
PV5000ST11	5	4.94	7.50	4.00	0.125	540
PV6000ST12	6	5.00	8.50	4.00	0.125	690

All dimensions are for informational purposes only *Tolerances +/- 5%

Conduit Hubs

ST Aluminum Conduit Hubs

Features:

- Exterior PVC coating thickness is a minimum 0.040"
- Interior urethane coating thickness is a minimum 0.002"
- ST available in 12 trade sizes from ½" through 6"
- Sealing sleeves on conduit side of hub
- The length of the sleeve extension(s) shall be at least equivalent to the nominal conduit size for sizes ½" - 2"
- For sizes 2 ½" - 6", the length of the sleeve extension(s) shall be at least 2"

Standards:

- NEC/CEC:
 - Class I, Division 2,
 - Class II, Division 1 & 2
- Class III, Division 1 & 2
- Class I, Zone 1, AEx e II
- Class I, Zone 1, Ex e II
- All Screw-tight Hubs are manufactured in accordance with NEMA type enclosures 2, 3, 3R, 4, 4x, 11 and 12



Applications:

Calbond PVC Conduit Hubs are used to terminate conduit runs into electrical enclosures. PVC coating and internal urethane coating provide for superior corrosion protection. Electrical continuity is maintained across assembled joints.

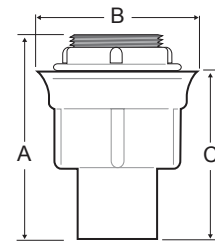

Part Number	Trade Size (in)	A (in)	B (in)	C (in)	Max Wall Thickness (in)
PA0500STA1	½	1.84	2.00	1.31	0.125
PA0700STA2	¾	2.22	2.25	1.66	0.125
PA1000STA3	1	2.66	2.50	2.03	0.125
PA1200STA4	1¼	2.94	3.25	2.28	0.125
PA1500STA5	1½	3.19	3.50	2.53	0.125
PA2000STA6	2	3.75	4.25	3.09	0.125
PA2500STA7	2½	4.22	4.75	3.28	0.125
PA3000STA8	3	4.31	5.25	3.38	0.125
PA3500STA9	3½	4.38	5.50	3.44	0.125
PA4000STA10	4	4.44	6.25	3.50	0.125
PA5000STA11	5	4.94	7.50	4.00	0.125
PA6000STA12	6	5.00	8.50	4.00	0.125

All dimensions are for informational purposes only *Tolerances +/- 5%

STG Conduit Hubs

Features:

- Exterior PVC coating thickness is a minimum 0.040"
- Interior urethane coating thickness is a minimum 0.002"
- STG available in 12 trade sizes from ½" through 6"
- Molded PVC gasket seals flush with enclosure wall
- Neoprene O-ring gasket provides additional seal
- The length of the sleeve extension(s) shall be at least equivalent to the nominal conduit size for sizes ½"- 2"
- For sizes 2 ½"- 6", the length of the sleeve extension(s) shall be at least 2"

Standards:

- UL File#E352416
- NEC/CEC:
 - Class I, Division 2,
 - Class II, Division 1 & 2
 - Class III, Division 1 & 2
 - Class I, Zone 1, AEx e II
 - Class I, Zone 1, Ex e II
- All Screw-tight Hubs are manufactured in accordance with NEMA type enclosures 2, 3, 3R, 4, 4x, 11 and 12
- Grounding and Bonding Hubs are manufactured in accordance with NEMA Enclosures 2, 3, 3R, 4 and 12

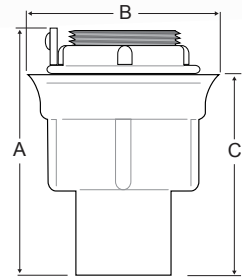

Applications:

Calbond PVC STG Conduit Hubs are used to terminate conduit runs into electrical enclosures. STG Conduit hubs feature a grounding lug on the locknut. PVC coating and internal urethane coating provide for superior corrosion protection. Electrical continuity is maintained across assembled joints.



Part Number	Trade Size (in)	A (in)	B (in)	C (in)	Max Wall Thickness (in)	Weight Per 100 (lb)
PV0500STG1	½	1.84	2.00	1.31	0.125	20
PV0700STG2	¾	2.22	2.25	1.66	0.125	30
PV1000STG3	1	2.66	2.50	2.03	0.125	40
PV1200STG4	1¼	2.94	3.25	2.28	0.125	40
PV1500STG5	1½	3.19	3.50	2.53	0.125	60
PV2000STG6	2	3.75	4.25	3.09	0.125	120
PV2500STG7	2½	4.22	4.75	3.28	0.125	150
PV3000STG8	3	4.31	5.25	3.38	0.125	210
PV3500STG9	3½	4.38	5.50	3.44	0.125	300
PV4000STG10	4	4.44	6.25	3.50	0.125	350
PV5000STG11	5	4.94	7.50	4.00	0.125	540
PV6000STG12	6	5.00	8.50	4.00	0.125	690

All dimensions are for informational purposes only *Tolerances +/- 5%

Conduit Hubs

STG Aluminum Conduit Hubs

Features:

- Exterior PVC coating thickness is a minimum 0.040"
- Interior urethane coating thickness is a minimum 0.002"
- STG available in 12 trade sizes from ½" through 6"
- Molded PVC gasket seals flush with enclosure wall
- Neoprene O-ring gasket provides additional seal
- The length of the sleeve extension(s) shall be at least equivalent to the nominal conduit size for sizes ½"- 2"
- For sizes 2 ½"- 6", the length of the sleeve extension(s) shall be at least 2"

Standards:

- NEC/CEC:
 - Class I, Division 2,
 - Class II, Division 1 & 2
 - Class III, Division 1 & 2
 - Class I, Zone 1, AEx e II
 - Class I, Zone 1, Ex e II
- All Screw-tight Hubs are manufactured in accordance with NEMA type enclosures 2, 3, 3R, 4, 4x, 11 and 12
- Grounding and Bonding Hubs are manufactured in accordance with NEMA Enclosures 2, 3, 3R, 4 and 12

Applications:

Calbond PVC Conduit Hubs are used to terminate conduit runs into electrical enclosures. STG Conduit hubs feature a grounding lug on the locknut. PVC coating and internal urethane coating provide for superior corrosion protection. Electrical continuity is maintained across assembled joints.

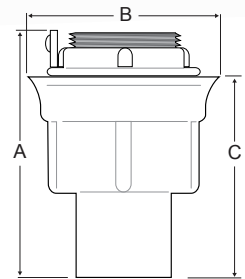

Part Number	Trade Size (in)	A (in)	B (in)	C (in)	Max Wall Thickness (in)
PA0500STAG1	½	1.84	2.00	1.31	0.125
PA0700STAG2	¾	2.22	2.25	1.66	0.125
PA1000STAG3	1	2.66	2.50	2.03	0.125
PA1200STAG4	1¼	2.94	3.25	2.28	0.125
PA1500STAG5	1½	3.19	3.50	2.53	0.125
PA2000STAG6	2	3.75	4.25	3.09	0.125
PA2500STAG7	2½	4.22	4.75	3.28	0.125
PA3000STAG8	3	4.31	5.25	3.38	0.125
PA3500STAG9	3½	4.38	5.50	3.44	0.125
PA4000STAG10	4	4.44	6.25	3.50	0.125
PA5000STAG11	5	4.94	7.50	4.00	0.125
PA6000STAG12	6	5.00	8.50	4.00	0.125

All dimensions are for informational purposes only *Tolerances +/- 5%

STTB Conduit Hubs

Features:

- Exterior PVC coating thickness is a minimum 0.040"
- Interior urethane coating thickness is a minimum 0.002"
- STTB available in 10 trade sizes from ½" through 4"
- Sealing sleeves on conduit side of hub
- Molded PVC gasket seals flush with enclosure wall
- Neoprene O-ring gasket provides additional seal
- The length of the sleeve extension(s) shall be at least equivalent to the nominal conduit size for sizes ½" - 2"
- For sizes 2½" - 4", the length of the sleeve extension(s) shall be at least 2"

Standards:

- UL 514B
- NEC/CEC:
 - Class I, Division 2,
 - Class II, Division 1 & 2
 - Class III, Division 1 & 2
 - Class I, Zone 1, AEx e II
 - Class I, Zone 1, Ex e II
- All Screw-tight Hubs are manufactured in accordance with NEMA type enclosures 2, 3, 3R, 4, 4x, 11 and 12

Applications:

Calbond PVC STTB style hubs are used to terminate conduit runs through the wall of a sheet metal electrical enclosure.. STTB style hubs are 'Through-Bulkhead' fittings used to pass conduit runs through firewalls or bulkheads up to ⅛" thick.

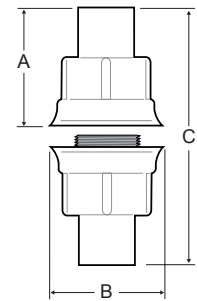

Part Number	Trade Size (in)	A (in)	B (in)	C (in)	Max Wall Thickness (in)
PV0500STTB1	½	1.84	2.00	1.31	0.190
PV0700STTB2	¾	2.22	2.25	1.66	0.190
PV1000STTB3	1	2.66	2.50	2.03	0.250
PV1200STTB4	1¼	2.94	3.25	2.28	0.250
PV1500STTB5	1½	3.19	3.50	2.53	0.250
PV2000STTB6	2	3.75	4.25	3.09	0.250
PV2500STTB7	2½	4.22	4.75	3.28	0.250
PV3000STTB8	3	4.31	5.25	3.38	0.250
PV3500STTB9	3½	4.38	5.50	3.44	0.250
PV4000STTB10	4	4.44	6.25	3.50	0.250

All dimensions are for informational purposes only *Tolerances +/- 5%

Conduit Hubs

STTB Aluminum Conduit Hubs

Features:

- Exterior PVC coating thickness is a minimum 0.040"
- Interior urethane coating thickness is a minimum 0.002"
- STTB available in 10 trade sizes from ½" through 4"
- Sealing sleeves on conduit side of hub
- Molded PVC gasket seals flush with enclosure wall
- Neoprene O-ring gasket provides additional seal
- The length of the sleeve extension(s) shall be at least equivalent to the nominal conduit size for sizes ½" - 2"
- For sizes 2½" - 4", the length of the sleeve extension(s) shall be at least 2"

Standards:

- NEC/CEC:
 - Class I, Division 2,
 - Class II, Division 1 & 2
 - Class III, Division 1 & 2
 - Class I, Zone 1, AEx e II
 - Class I, Zone 1, Ex e II
- All Screw-tight Hubs are manufactured in accordance with NEMA type enclosures 2, 3, 3R, 4, 4x, 11 and 12

Applications:

Calbond PVC Aluminum STTB style hubs are used to terminate conduit runs through the wall of a sheet metal electrical enclosure. STTB style hubs are 'Through-Bulkhead' fittings used to pass conduit runs through firewalls or bulkheads up to ⅛" thick.

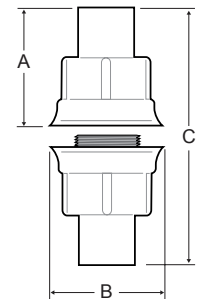

Part Number	Trade Size (in)	A (in)	B (in)	C (in)	Max Wall Thickness (in)
PA0500STTB A1	½	1.84	2.00	3.68	0.190
PA0700STTB A2	¾	2.22	2.25	4.44	0.190
PA1000STTB A3	1	2.66	2.50	5.32	0.250
PA1200STTB A4	1¼	2.94	3.25	5.88	0.250
PA1500STTB A5	1½	3.19	3.50	6.38	0.250
PA2000STTB A6	2	3.75	4.25	7.50	0.250
PA2500STTB A7	2½	4.22	4.75	8.44	0.250
PA3000STTB A8	3	4.31	5.25	8.62	0.250
PA3500STTB A9	3½	4.38	5.50	8.76	0.250
PA4000STTB A10	4	4.44	6.25	8.88	0.250

All dimensions are for informational purposes only *Tolerances +/- 5%

STTTB Conduit Hubs

Features:

- Exterior PVC coating thickness is a minimum 0.040"
- Interior urethane coating thickness is a minimum 0.002"
- STTTB available in 6 trade sizes from ½" through 2"
- Sealing sleeves on conduit side of hub
- Molded PVC gasket seals flush with enclosure wall
- Neoprene O-ring gasket provides additional seal
- The length of the sleeve extension(s) shall be at least equivalent to the nominal conduit size for sizes ½"- 2"



Standards:

- UL 514B
- NEC/CEC:
 - Class I, Division 2,
 - Class II, Division 1 & 2
 - Class III, Division 1 & 2
 - Class I, Zone 1, AEx e II
 - Class I, Zone 1, Ex e II
- All Screw-tight Hubs are manufactured in accordance with NEMA type enclosures 2, 3, 3R, 4, 4x, 11 and 12

Applications:

Calbond PVC STTTB Style Hubs are used to terminate conduit runs through the wall of a sheet metal electrical enclosure.. STTTB style hubs are "Through-Bulkhead" fittings used to pass conduit runs through firewalls with unlimited wall thickness. (furnished without nipples)

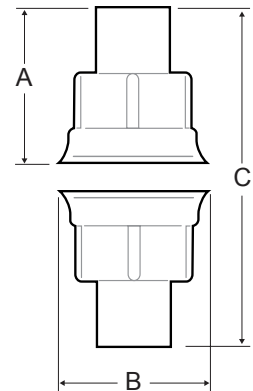

Part Number	Trade Size (in)	A (in)	B (in)	C (in)
PV0500STTTB1	½	1.84	2.00	3.68
PV0700STTTB2	¾	2.22	2.25	4.44
PV1000STTTB3	1	2.66	2.50	5.32
PV1200STTTB4	1¼	2.94	3.25	5.88
PV1500STTTB5	1½	3.19	3.50	6.38
PV2000STTTB6	2	3.75	4.25	7.50

All dimensions are for informational purposes only *Tolerances +/- 5%

Conduit Hubs

STTTB Aluminum Conduit Hubs

Features:

- Exterior PVC coating thickness is a minimum 0.040"
- Interior urethane coating thickness is a minimum 0.002"
- STTTB available in 6 trade sizes from ½" through 2"
- Sealing sleeves on conduit side of hub
- Molded PVC gasket seals flush with enclosure wall
- Neoprene O-ring gasket provides additional seal
- The length of the sleeve extension(s) shall be at least equivalent to the nominal conduit size for sizes ½" - 2"



Standards:

- NEC/CEC:
 - Class I, Division 2,
 - Class II, Division 1 & 2
 - Class III, Division 1 & 2
 - Class I, Zone 1, AEx e II
 - Class I, Zone 1, Ex e II
- All Screw-tight Hubs are manufactured in accordance with NEMA type enclosures 2, 3, 3R, 4, 4x, 11 and 12

Applications:

Calbond PVC Aluminum STTTB Style Hubs are used to terminate conduit runs through the wall of a sheet metal electrical enclosure.. STTTB style hubs are "Through-Bulkhead" fittings used to pass conduit runs through firewalls with unlimited wall thickness. (furnished without nipples)

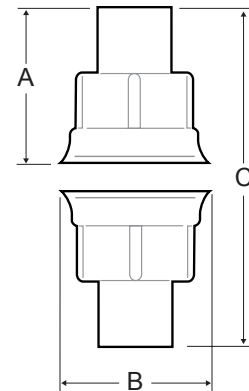

Part Number	Trade Size (in)	A (in)	B (in)	C (in)	Weight per 100 (lb)
PA0500STTTB1	½	1.84	2.00	3.68	100
PA0700STTTB2	¾	2.22	2.25	4.44	100
PA1000STTTB3	1	2.66	2.50	5.32	140
PA1200STTTB4	1¼	2.94	3.25	5.88	200
PA1500STTTB5	1½	3.19	3.50	6.38	240
PA2000STTTB6	2	3.75	4.25	7.50	340

All dimensions are for informational purposes only *Tolerances +/- 5%



Device Boxes



Device Boxes

FD Device Boxes	62
FDC Device Boxes	63
FDCT Device Boxes	64
FS Device Boxes	65
FSC Device Boxes	66
FSCC Device Boxes	67
Single Gang Box Covers	68
Double Gang Box Covers	69

FD Device Boxes

Features:

- Exterior PVC coating thickness is a minimum 0.040"
- Interior urethane coating thickness is a minimum 0.002"
- Sizes available are ½" to 1"
- Sealing sleeves on all conduit openings
- Modified boxes are available upon request
- All available covers are supplied with PVC coating

Standards:

- UL Listed Standard 514B File #E307133
- CSA Standard: C22.2 No. 18

Applications:

Calbond Type FD PVC Coated Device Boxes offer corrosion protection to conduit systems and accommodates wiring devices and access for taps and splices. Covers are available separately. Electrical continuity of the conduit system is maintained across assembled system.



Part Number	Trade Size (in)	Weight per 100 (lb)	A (in)	B (in)	C (in)	D (in)	Aluminum Item Number
Single Gang							
PV0500FD1	½	2.70	1.380	1.920	2.690	0.670	PA0500FD1SA
PV0700FD2	¾	2.80	1.630	1.920	2.690	0.790	PA0700FD2SA
PV1000FD3	1	3.10	2.000	1.920	2.690	0.920	PA1000FD3SA

All dimensions are for informational purposes only *Tolerances +/- 5%

Device Boxes

FDC Device Boxes

Features:

- Exterior PVC coating thickness is a minimum 0.040"
- Interior urethane coating thickness is a minimum 0.002"
- Sizes available are ½" to 1"
- Sealing sleeves on all conduit openings
- Modified boxes are available upon request
- All available covers are supplied with PVC coating

Standards:

- UL Listed Standard 514B, File # 307133
- CSA Standard: C22.2 No. 18

Applications:

Calbond Type FS & FD PVC Coated Device Boxes and Covers offer corrosion protection to conduit systems and accommodates wiring devices and access for taps and splices. Covers are available separately. Electrical continuity of the conduit system is maintained across assembled system.



Part Number	Trade Size (in)	Weight per 100 (lb)	A (in)	B (in)	C (in)	D (in)	Aluminum Item Number
PV0500FDC1	½	270	1.380	1.920	2.690	0.670	PA0500FDC1SA
PV0700FDC2	¾	280	1.630	1.920	2.690	0.790	PA0700FDC2SA
PV1000FDC3	1	310	2.000	1.920	2.690	0.920	PA1000FDC3SA

All dimensions are for informational purposes only *Tolerances +/- 5%

FDCT Device Boxes

Features:

- Exterior PVC coating thickness is a minimum 0.040"
- Interior urethane coating thickness is a minimum 0.002"
- Sizes available are ½" to 1"
- Sealing sleeves on all conduit openings
- Modified boxes are available upon request
- All available covers are supplied with PVC coating

Standards:

- UL Listed Standard 514B File #E307133
- CSA Standard: C22.2 No. 18

Applications:

Calbond Type FDCT PVC Coated Device Boxes offer corrosion protection to conduit systems and accommodates wiring devices and access for taps and splices. Covers are available separately. Electrical continuity of the conduit system is maintained across assembled system.



Part Number	Trade Size (in)	Weight per 100 (lb)	A (in)	B (in)	C (in)	D (in)
PV0500FDCT1	½	310	1.380	1.920	2.690	0.670
PV0700FDCT2	¾	340	1.630	1.920	2.690	0.790
PV1000FDCT3	1	390	2.000	1.920	2.690	0.920

All dimensions are for informational purposes only *Tolerances +/- 5%

Device Boxes

FS Device Boxes

Features:

- Exterior PVC coating thickness is a minimum 0.040"
- Interior urethane coating thickness is a minimum 0.002"
- Sizes available are ½" to 1"
- Sealing sleeves on all conduit openings
- Modified boxes are available upon request
- All available covers are supplied with PVC coating

Standards:

- UL Listed Standard 514B File #E307133
- CSA Standard: C22.2 No. 18

Applications:

Calbond Type FS PVC Coated Device Boxes offer corrosion protection to conduit systems and accommodates wiring devices and access for taps and splices. Covers are available separately. Electrical continuity of the conduit system is maintained across assembled system.



Part Number	Trade Size (in)	Weight per 100 (lb)	A (in)	B (in)	C (in)	D (in)	Aluminum Item Number
Single Gang							
PV0500FS1	½	3.20	1.380	1.920	1.690	0.670	PA0500FS1SA
PV0700FS2	¾	3.30	1.630	1.920	1.690	0.790	PA0700FS2SA
PV1000FS3	1	3.50	2.000	1.920	1.690	0.920	
Double Gang							
PV0500FS12	½	3.30	1.380	1.920	1.690	0.670	PA0500FS12SA
PV0700FS22	¾	3.40	1.630	1.920	1.690	0.790	PA0700FS22SA
PV1000FS32	1	3.60	2.000	1.920	1.690	0.920	

All dimensions are for informational purposes only *Tolerances +/- 5%

FSC Device Boxes

Features:

- Exterior PVC coating thickness is a minimum 0.040"
- Interior urethane coating thickness is a minimum 0.002"
- Sizes available are ½" to 1"
- Sealing sleeves on all conduit openings
- Modified boxes are available upon request
- All available covers are supplied with PVC coating

Standards:

- UL Listed Standard 514B File #E307133
- CSA Standard: C22.2 No. 18

Applications:

Calbond Type FSC PVC Coated Device Boxes offer corrosion protection to conduit systems and accommodates wiring devices and access for taps and splices. Covers are available separately. Electrical continuity of the conduit system is maintained across assembled system.



Part Number	Trade Size (in)	Weight per 100 (lb)	A (in)	B (in)	C (in)	D (in)	Aluminum Item Number
Single Gang							
PV0500FSC1	½	2.20	1.380	1.920	1.690	0.670	PA0500FSC1SA
PV0700FSC2	¾	2.40	1.630	1.920	1.690	0.790	PA0700FSC2SA
PV1000FSC3	1	2.70	2.000	1.920	1.690	0.920	
Double Gang							
PV0500FSC12	½	3.30	1.380	1.920	1.690	0.670	
PV0700FSC222	¾	3.60	1.630	1.920	1.690	0.790	
PV1000FSC32	1	4.00	2.000	1.920	1.690	0.920	

All dimensions are for informational purposes only *Tolerances +/- 5%

Device Boxes

FSCC Device Boxes

Features:

- Exterior PVC coating thickness is a minimum 0.040"
- Interior urethane coating thickness is a minimum 0.002"
- Sizes available are ½" to ¾"
- Sealing sleeves on all conduit openings
- Modified boxes are available upon request
- All available covers are supplied with PVC coating

Standards:

- UL Listed Standard 514B File #E307133
- CSA Standard: C22.2 No. 18

Applications:

Calbond Type FSCC PVC Coated Device Boxes and Covers offer corrosion protection to conduit systems and accommodates wiring devices and access for taps and splices. Covers are available separately. Electrical continuity of the conduit system is maintained across assembled system.



Part Number	Trade Size (in)	Weight per 100 (lb)	A (in)	B (in)	C (in)	D (in)
PV0500FSCC1	½	2.50	1.380	1.920	1.690	0.670
PV0700FSCC2	¾	3.50	1.630	1.920	1.690	0.790

All dimensions are for informational purposes only *Tolerances +/- 5%

PVC Coated Device Box Single Gang Covers



DS100



DS100G

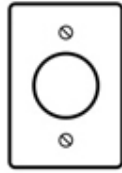

DS21



DS21G

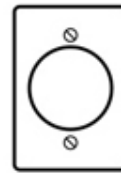

DS35

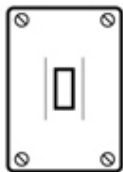

DS32G



DS23



DS128



WLRS1



WLDR1



DS23GFI

Part Number	Part Description	Weight per 100lbs
Ferrous Covers		
PV0000DS21	3P 2W Grounding Round Flush Receptacles (S)	30
PV0000DS21G	3P 2W Grounding Round Flush Receptacles (S, F)	30
PV0000DS23	Duplex Convenience Receptacle (S)	30
PV0000DS23GFI	For GFI Receptacle	40
PV0000DS32G	Square Handle Snap or Toggle (S, F)	40
PV0000DS35	Plug Receptacle 1 5/8" Diameter (S)	40
Aluminum Covers		
PA0000DS100	Blank Cover (S)	10
PA0000DS128	1 Gang Cover-Snap Switch	50
PA0000DS100G	Blank w/Gasket Blank Cover CAST (S, F)	30
PA0000WLRS1	Single Spring Door Single Cover 1 3/8" (F)	30
PA0000WLDR1	Single Spring Door Single Cover 1 3/8" (F)	30

Device Box Covers

PVC Coated Device Box Double Gang Covers

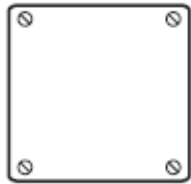

S1002

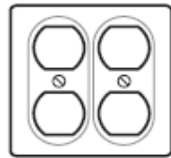

S232

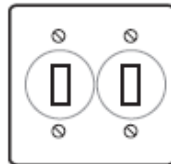

S322

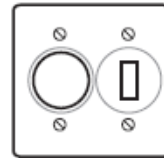

S32212

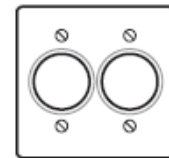

S212

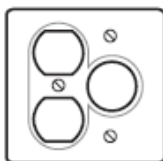

S21232

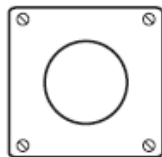

S612

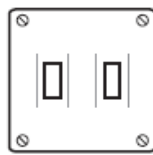

S322G

Part Number	Part Discription	Nominal Weight
Ferrous Covers		
PV0000S1002	Blank Cover Sheet Steel (S)	1.0
PV0000S1002G	Blank Cover Iron Alloy (S, F)	1.0
PV0000S21232	Round Recptacle - Duplex Convenience	1.2
PV0000S232	Duplex Conenience (S)	1.2
PV0000S322	Surface Flush - Snap Switch (S)	1.0
PA0000S32212	Sheet Steel - Round Receptacle + Snap Switch (S)	1.2
PA0000S212	Sheet Steel - Round Flush - Two Round Receptacles (S)	2.0
PA0000S612	Sheet Steel - 2 Pole Surface - 20 AMP, 250 V Receptacles	1.2
PA0000S322G	Surface or Flush - Snap Switches Iron Alloy (S, F)	1.2



GUA Junction Boxes



GUA Junction Boxes

GUAB Junction Boxes	73
GUAC Junction Boxes	74
GUAD Junction Boxes	75
GUAL Junction Boxes	76
GUAN Junction Boxes	77
GUAT Junction Boxes	78
GUAW Junction Boxes	79
GUAX Junction Boxes	80



GUA Junction Boxes

Features:

- Exterior PVC coating thickness is a minimum 0.040"
- Interior Urethane coating thickness is a minimum 0.002"

Standards:

- National Electric Code:
Class I, Division 1 & 2, Groups C, D, Class III
- UL Standard 886
- ANSI Standard C-33.27
- CSA Standard: C22.2 No. 30
- NEMA/EEMAC 3, 4

Applications:

Calbond GUA Style Fittings are available in a variety of shapes and dimensions. GUA Aluminum style boxes are used in hazardous locations. All GUA Aluminum style boxes are supplied PVC coated with PVC coated covers and a seal between the coating of the boxes and the coating of the covers.

GUA Junction Boxes

GUAB Junction Boxes



Part Number	Trade Size (in)	Cover Opening (in)	A (in)	B (in)	C (in)	D (in)	Weight per 100 (lb)
Steel							
PV0500GUAB16	½	3	3.58	2.04	1.88	0.67	320
PV0500GUAB14	½	2	2.58	2.29	2.38	0.67	200
PV0700GUAB26	¾	3	2.58	2.04	1.88	0.79	330
PV0700GUAB24	¾	2	2.58	2.54	2.44	0.79	220
PV1000GUAB36	1	3	3.58	2.35	2.19	0.92	380
PV1200GUAB47	1¼	3½	4.33	2.73	2.75	1.13	500
PV1500GUAB59	1½	5	5.83	3.85	3.75	1.32	810
PV2000GUAB69	2	5	5.83	4.10	4.00	1.60	910
Aluminum							
PA0700GUAB26SA	¾	3	2.58	2.04	1.88	0.79	Contact Factory
PA0500GUAB16SA	½	3	3.58	2.04	1.88	0.67	Contact Factory
PA1000GUAB36SA	1	3	3.58	2.35	2.19	0.92	Contact Factory
PA1200GUAB47SA	1¼	3½	4.33	2.73	2.75	1.13	Contact Factory
PA1500GUAB59SA	1½	5	5.83	3.85	3.75	1.32	Contact Factory
PA2000GUAB69SA	2	5	5.83	4.10	4.00	1.60	Contact Factory

All dimensions are for informational purposes only *Tolerances +/- 5%

GUAC Junction Boxes



Part Number	Trade Size (in)	Cover Opening (in)	A (in)	B (in)	C (in)	D (in)	Weight per 100 (lb)
Steel							
PV0500GUAC14	½	2	2.58	2.29	2.19	0.67	350
PV0500GUAC16	½	3	3.58	2.04	1.88	0.67	200
PV0700GUAC24	¾	2	2.58	2.04	2.00	0.79	350
PV0700GUAC26	¾	3	3.58	2.04	1.88	0.79	200
PV1000GUAC36	1	3	3.58	2.35	2.19	0.92	390
PV1200GUAC47	1¼	3⅝	4.33	2.73	2.75	1.13	520
PV1200GUAC49	1¼	5	5.83	3.85	3.75	1.32	950
PV1500GUAC59	1½	5	5.83	3.85	3.75	1.32	1,100
PV2000GUAC69	2	5	5.83	4.10	4.00	1.60	1,100
Aluminum							
PA0500GUAC16SA	½	3	3.58	2.04	1.88	0.67	Contact Factory
PA0700GUAC26SA	¾	3	3.58	2.04	1.88	0.79	Contact Factory
PA1000GUAC36SA	1	3	3.58	2.35	2.19	0.92	Contact Factory
PA1200GUAC47SA	1¼	3⅝	4.33	2.73	2.75	1.13	Contact Factory
PA1500GUAC59SA	1½	5	5.83	3.85	3.75	1.32	Contact Factory
PA2000GUAC69SA	2	5	5.83	4.10	4.00	1.60	Contact Factory

All dimensions are for informational purposes only *Tolerances +/- 5%

GUA Junction Boxes

GUAD Junction Boxes



Part Number	Trade Size (in)	Cover Opening (in)	A (in)	B (in)	C (in)	D (in)	Weight per 100 (lb)
Steel							
PV0500GUAD14	½	2	2.58	1.85	1.75	0.67	200
PV0500GUAD14	½	2	2.58	1.85	1.75	0.67	200
PV0500GUAD16	½	3	3.58	2.04	1.88	0.79	320
PV0500GUAD16	½	3	3.58	2.04	1.88	0.79	320
PV0700GUAD24	¾	2	2.58	2.04	2.00	0.79	350
PV0700GUAD24	¾	2	2.58	2.04	2.00	0.79	350
PV0700GUAD26	¾	3	2.58	2.04	1.88	0.79	380
PV0700GUAD26	¾	3	2.58	2.04	1.88	0.79	380
PV1000GUAD36	1	3	3.58	2.35	2.19	0.92	380
PV1000GUAD36	1	3	3.58	2.35	2.19	0.92	380
PV1200GUAD47	1 ¼	5	5.83	3.85	3.75	1.13	1,090
PV1200GUAD47	1 ¼	5	5.83	3.85	3.75	1.13	1,090

All dimensions are for informational purposes only *Tolerances +/- 5%

GUAL Junction Boxes



Part Number	Trade Size (in)	Cover Opening (in)	A (in)	B (in)	C (in)	D (in)	Weight per 100 (lb)
Steel							
PV0500GUAL14	½	2	2.58	2.29	2.19	0.67	200
PV0500GUAL16	½	3	3.58	2.04	1.88	0.67	210
PV0700GUAL24	¾	2	2.58	2.54	2.44	0.79	320
PV0700GUAL26	¾	3	3.58	2.04	1.88	0.79	250
PV1000GUAL36	1	3	3.58	2.35	2.19	0.92	370
PV1200GUAL47	1¼	3⅝	4.33	2.73	2.75	1.13	520
PV1200GUAL49	1¼	5	5.83	3.85	3.75	1.20	850
PV1500GUAL59	1½	5	5.83	3.85	3.75	1.32	1,200
PV2000GUAL69	2	5	5.83	4.10	4.00	1.60	1,250
Aluminum							
PA0700GUAL26SA	¾	3	3.58	2.04	1.88	0.79	Contact Factory
PA0500GUAL16SA	½	3	3.58	2.04	1.88	0.67	Contact Factory
PA1000GUAL36SA	1	3	3.58	2.35	2.19	0.92	Contact Factory
PA1200GUAL47SA	1¼	3⅝	4.33	2.73	2.75	1.13	Contact Factory
PA1500GUAL59SA	1½	5	5.83	3.85	3.75	1.32	Contact Factory
PA2000GUAL69SA	2	5	5.83	4.10	4.00	1.60	Contact Factory

All dimensions are for informational purposes only *Tolerances +/- 5%

GUA Junction Boxes

GUAN Junction Boxes



Part Number	Trade Size (in)	Cover Opening (in)	A (in)	B (in)	C (in)	D (in)	Weight per 100 (lb)
Steel							
PV0500GUAN14	1/2	2	2.58	2.17	2.06	0.67	200
PV0500GUAN16	1/2	3	3.58	2.04	1.88	0.79	380
PV0700GUAN24	3/4	2	2.58	2.35	2.25	0.79	250
PV0700GUAN26	3/4	3	2.58	2.04	1.88	0.79	350
PV1000GUAN36	1	3	3.58	2.35	2.38	0.92	300
PV1200GUAN47	1 1/4	3 5/8	4.33	2.73	2.75	1.13	520
PV1500GUAN59	1 1/2	5	5.83	4.10	4.00	1.32	950
PV2000GUAN69	2	5	5.83	4.10	4.00	1.60	1,200

All dimensions are for informational purposes only *Tolerances +/- 5%

GUAT Junction Boxes



Part Number	Trade Size (in)	Cover Opening (in)	A (in)	B (in)	C (in)	D (in)	Weight per 100 (lb)
Steel							
PV0500GUAT14	½	2	2.58	2.29	2.19	0.67	200
PV0500GUAT16	½	3	3.58	2.04	1.88	0.67	280
PV0700GUAT24	¾	2	2.58	2.04	2.00	0.79	220
PV0700GUAT26	¾	3	3.58	2.04	1.88	0.79	350
PV1000GUAT36	1	3	3.58	2.35	2.19	0.92	320
PV1200GUAT47	1¼	3⅞	4.33	2.73	2.75	1.13	570
PV1500GUAT59	1½	5	5.83	3.85	3.75	1.32	910
PV2000GUAT69	2	5	5.83	4.10	4.00	1.60	1,000
Aluminum							
PA0500GUAT16SA	½	3	3.58	2.04	1.88	0.67	Contact Factory
PA0700GUAT26SA	¾	3	3.58	2.04	1.88	0.79	Contact Factory
PA1000GUAT36SA	1	3	3.58	2.35	2.19	0.92	Contact Factory
PA1200GUAT47SA	1¼	3⅞	4.33	2.73	2.75	1.13	Contact Factory
PA1500GUAT59SA	1½	5	5.83	3.85	3.75	1.32	Contact Factory
PA2000GUAT69SA	2	5	5.83	4.10	4.00	1.60	Contact Factory

All dimensions are for informational purposes only *Tolerances +/- 5%

GUA Junction Boxes

GUAW Junction Boxes



Part Number	Trade Size (in)	Cover Opening (in)	A (in)	B (in)	C (in)	D (in)	Weight per 100 (lb)
Steel							
PV0500GUAW14	½	2	2.58	1.85	1.75	0.67	200
PV0500GUAW16	½	3	3.58	2.04	1.88	0.67	200
PV0700GUAW24	¾	2	2.58	2.04	2.00	0.79	300
PV0700GUAW26	¾	3	2.58	2.04	1.88	0.79	300

All dimensions are for informational purposes only *Tolerances +/- 5%

GUAX Junction Boxes



Part Number	Trade Size (in)	Cover Opening (in)	A (in)	B (in)	C (in)	D (in)	Weight per 100 (lb)
Steel							
PV0500GUAX14	½	2	2.58	1.85	1.75	0.67	200
PV0500GUAX16	½	3	3.58	2.04	1.88	0.67	380
PV0700GUAX24	¾	2	2.58	2.04	2.00	0.79	250
PV0700GUAX26	¾	3	3.58	2.04	1.88	0.79	280
PV1000GUAX36	1	3	3.58	2.35	2.19	0.92	420
PV1200GUAX47	1¼	3½	4.33	2.73	2.75	1.13	480
PV1500GUAX59	1½	5	5.83	3.85	3.75	1.32	1170
PV2000GUAX69	2	5	5.83	4.10	4.00	1.60	1250
Aluminum							
PA0500GUAX16SA	½	3	3.58	2.04	1.88	0.67	Contact Factory
PA0700GUAX26SA	¾	3	3.58	2.04	1.88	0.79	Contact Factory
PA1000GUAX36SA	1	3	3.58	2.35	2.19	0.92	Contact Factory
PA1200GUAX47SA	1¼	3½	4.33	2.73	2.75	1.13	Contact Factory
PA1500GUAX59SA	1½	5	5.83	3.85	3.75	1.32	Contact Factory

All dimensions are for informational purposes only *Tolerances +/- 5%



Unions



Unions

UNF Unions

84

UNY Unions

85

UNF Unions

Features:

- Exterior PVC coating thickness is a minimum 0.040"
- Interior Urethane coating thickness is a minimum 0.002"
- Sizes available are ½" to 6"
- The length of the sleeve extension(s) shall be at least equivalent to the nominal conduit size for sizes ½"- 2". For sizes 2½"- 6", the length of the sleeve extension(s) shall be at least 2".
- A sealing form is provided between the mating surfaces of the unions



Applications:

Calbond PVC Unions are used in conduit connections when the conduit cannot be turned. Calbond unions are provided with two sealing sleeves and a sealing form in the mating joint. For Calbond UNY, Calbond provides a UNF with a close nipple.

Standards:

- NEC/CEC:
 - UNF 105-305 Class I, Division 1 & 2, Groups A, B, C, D Class III
 - UNF 905-1005 Class I, Division 1 & 2, Groups B, C, D Class III
 - UNF All Sizes Class I, Division 1 & 2, Groups C, D Class III
- UL Standard: 1203
- CSA Standard: C22.2 NO. 30

Part Number	Trade Size (in)	Weight per 100 (lb)	Length (in)	Max Diameter (in)
PV0500UNF105	½	30	2.81	1.58
PV0700UNF205	¾	50	3.25	1.89
PV0700UNF215	¾-½	60	3.00	1.89
PV1000UNF305	1	70	4.00	1.96
PV1200UNF405	1 ¼	150	4.75	2.83
PV1500UNF505	1 ½	230	5.63	3.14
PV2000UNF605	2	360	6.56	3.89
PV2500UNF705	2 ½	500	7.19	4.39
PV3000UNF805	3	650	7.44	5.14
PV3500UNF905	3 ½	820	8.13	5.77
PV4000UNF1005	4	1,000	8.13	6.27
PV5000UNF012	5	1,250	7.81	8.27
PV6000UNF014	6	1,480	7.81	9.39

UNY Unions

Features:

- Exterior PVC coating thickness is a minimum 0.040"
- Interior Urethane coating thickness is a minimum 0.002"
- Sizes available are ½" to 6"
- The length of the sleeve extension(s) shall be at least equivalent to the nominal conduit size for sizes ½"- 2". For sizes 2 ½"- 6", the length of the sleeve extension(s) shall be at least 2".
- A sealing form is provided between the mating surfaces of the unions



Applications:

Calbond PVC Unions are used in conduit connections when the conduit cannot be turned. Calbond unions are provided with two sealing sleeves and a sealing form in the mating joint. For Calbond UNY, Calbond provides a UNF with a close nipple.

Standards:

- NEC/CEC:
 - UNF 105-305 Class I, Division 1 & 2, Groups A, B, C, D Class III
- UNY 905-1005 Class I, Division 1 & 2, Groups B, C, D Class III
- UNY All Sizes Class I, Division 1 & 2, Groups C, D Class III
- UL Standard: 1203
- CSA Standard: C22.2 NO. 30

Part Number	Trade Size (in)	Weight per 100 (lb)	Length (in)	Max Diameter (in)
PV0500UNY105	½	40	3.38	1.58
PV0700UNY205	¾	70	3.94	1.89
PV0700UNY215	¾-½	80	3.69	1.89
PV1000UNY305	1	130	4.75	1.96
PV1200UNY405	1 ¼	260	5.69	2.83
PV1500UNY505	1 ½	390	6.56	3.14
PV2000UNY605	2	420	7.75	3.89
PV2500UNY705	2 ½	550	8.63	4.39
PV3000UNY805	3	750	9.00	5.14
PV3500UNY905	3 ½	840	9.50	5.77
PV4000UNY1005	4	1,050	9.63	6.27
PV5000UNY012	5	1,200	9.25	8.27
PV6000UNY014	6	1,490	9.38	9.39



Sealing Fittings



Sealing Fittings

EYD Female Hubs	88
EYD Male - Female Hubs	90
EYS Female Hubs	92
Aluminum EYS Female Hubs	94
EYS Male - Female Hubs	95
Aluminum EYS Male - Female Hubs	97
EZD Female Hubs	98
EZS Female Hubs	99
EZS Male - Female Hubs	100

EYD Female Hubs

Features:

- Exterior PVC coating thickness is a minimum 0.040"
- Interior Urethane coating thickness is a minimum 0.002"
- Sizes available are ½" to 4 "
- The length of the sleeve extension(s) shall be at least equivalent to the nominal conduit size for sizes ½"- 2"
- For sizes 2½"- 4", the length of the sleeve extension(s) shall be at least 2".
- Sealing sleeve is provided on plug hub (patching compound recommended on top of plug)
- Mating sealing forms are provided on all caps
- Sealing sleeves on all conduit openings



Standards:

- NEC/CEC:
 - EYD-11-101, 116-1016 Class I, Division 1 & 2, Groups B, C, D Class III
- EYD1-10, 16-106 Class I, Division 1 & 2, Groups C, D Class III
- EYD10-60, 111-611 Class I, Division 1 & 2, Groups C, D Class III
- UL Standard: 1203
- CSA Standard: C22.2

Applications:

Calbond PVC Coated Sealing Fittings are used in hazardous locations to prevent flame and gas from continuing to travel through the conduit system. PVC coating provides corrosion protection. A sealing compound should be used on the interior after wiring. Compound supplied by the original fitting manufacturer.

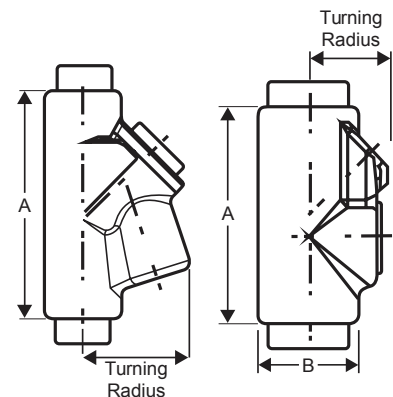

Sealing Fittings

EYD Female Hubs

Part Number	Trade Size (in)	Weight per 100 (lb)	A (in)	B (in)	Turning Radius
For Sealing in Vertical or Horizontal Positions					
PV0500EYD1	½	140	3.28	1.33	1.63
PV0700EYD2	¾	170	3.69	1.58	1.91
PV1000EYD3	1	230	4.31	2.27	2.38
PV1200EYD4	1 ¼	250	5.06	2.27	1.84
PV1500EYD5	1 ½	400	5.50	2.52	2.06
PV2000EYD6	2	470	6.25	3.08	2.31
PV2500EYD7	2 ½	900	7.50	3.58	2.69
PV3000EYD8	3	1,020	8.5	4.33	3.31
PV3500EYD9	3 ½	1,050	9.19	4.83	3.44
PV4000EYD10	4	400	9.75	5.33	3.5
PV0500EYD11	½	140	3.28	1.33	1.63
PV0700EYD21	¾	170	3.69	1.58	1.91
PV1000EYD31	1	230	4.31	2.27	2.38
PV1200EYD41	1 ¼	250	5.06	2.27	1.84
PV1500EYD51	1 ½	400	5.50	2.52	2.06
PV2000EYD61	2	470	6.25	3.08	2.31
PV2500EYD71	2 ½	900	7.50	3.58	2.69
PV3000EYD81	3	1020	8.50	4.33	3.31
PV3500EYD91	3 ½	1050	9.19	4.83	3.44
PV4000EYD101	4	400	9.75	5.33	3.50

Aluminum EYD Female Hubs

Aluminum Part Number	Trade Size (in)	A (in)	B (in)	Turning Radius
For Sealing in Vertical or Horizontal Positions				
PA0500EYD1SA	½	3.28	1.33	1.63
PA0700EYD2SA	¾	3.69	1.58	1.91
PA1000EYD3SA	1	4.31	2.27	2.38
PA1200EYD4SA	1¼	5.06	2.27	1.84
PA1500EYD5SA	1½	5.50	2.52	2.06
PA2000EYD6SA	2	6.25	3.08	2.31
PA2500EYD7SA	2½	7.50	3.58	2.69
PA3000EYD8SA	3	8.50	4.33	3.31
PA3500EYD9SA	3½	9.19	4.83	3.44
PA4000EYD10SA	4	9.75	5.33	3.50

EYD Male - Female Hubs

Features:

- Exterior PVC coating thickness is a minimum 0.040"
- Interior Urethane coating thickness is a minimum 0.002"
- Sizes available are ½" to 4"
- The length of the sleeve extension(s) shall be at least equivalent to the nominal conduit size for sizes ½" - 2"
- For sizes 2½" - 4", the length of the sleeve extension(s) shall be at least 2".
- Sealing sleeve is provided on plug hub (patching compound recommended on top of plug)
- Mating sealing forms are provided on all caps
- Sealing sleeves on all conduit openings



Standards:

- NEC/CEC:
 - EYD-11-101, 116-1016
Class I, Division 1 & 2,
Groups B, C, D Class III
- EYD1-10, 16-106
Class I, Division 1 & 2,
Groups C, D Class III
- EYD10-60, 111-611
Class I, Division 1 & 2,
Groups C, D Class III
- UL Standard: 1203
- CSA Standard: C22.2

Applications:

Calbond PVC Coated Sealing Fittings are used in hazardous locations to prevent flame and gas from continuing to travel through the conduit system. PVC coating provides corrosion protection. A sealing compound should be used on the interior after wiring. Compound supplied by the original fitting manufacturer.

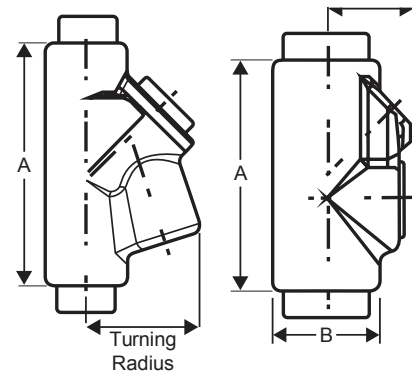

Sealing Fittings

EYD Male - Female Hubs

Part Number	Trade Size (in)	Weight per 100 (lb)	A (in)	B (in)	Turning Radius
For Sealing in Vertical or Horizontal Positions					
PV0500EYD16	½	270	3.28	1.33	1.63
PV0700EYD26	¾	280	3.69	1.58	1.91
PV1000EYD36	1	290	4.31	2.27	2.38
PV1200EYD46	1¼	260	5.06	2.27	1.84
PV1500EYD56	1½	370	5.50	2.52	2.06
PV2000EYD66	2	520	6.25	3.08	2.31
PV2500EYD76	2½	950	7.50	3.58	2.69
PV3000EYD86	3	1,130	8.50	4.33	3.31
PV3500EYD96	3½	1,250	9.19	4.83	3.44
PV4000EYD106	4	1,670	9.75	5.33	3.50

Aluminum EYD Male - Female Hubs

Aluminum Part Number	Trade Size (in)	A (in)	B (in)	Turning Radius
For Sealing in Vertical or Horizontal Positions				
PA0500EYD16SA	½	3.28	1.33	1.63
PA0700EYD26SA	¾	3.69	1.58	1.91
PA1000EYD36SA	1	4.31	2.27	2.38
PA1200EYD46SA	1¼	5.06	2.27	1.84
PA1500EYD56SA	1½	5.50	2.52	2.06
PA2000EYD66SA	2	6.25	3.08	2.31
PA2500EYD76SA	2½	7.50	3.58	2.69
PA3000EYD86SA	3	8.50	4.33	3.31
PA3500EYD96SA	3½	9.19	4.83	3.44
PA4000EYD106SA	4	9.75	5.33	3.50

EYS Female Hubs

Features:

- Exterior PVC coating thickness is a minimum 0.040"
- Interior Urethane coating thickness is a minimum 0.002"
- Sizes available are ½" to 4 "
- The length of the sleeve extension(s) shall be at least equivalent to the nominal conduit size for sizes ½"- 2"
- For sizes 2 ½"- 4", the length of the sleeve extension(s) shall be at least 2".
- Sealing sleeve is provided on plug hub (patching compound recommended on top of plug)
- Mating sealing forms are provided on all caps
- Sealing sleeves on all conduit openings



Standards:

- NEC/CEC:
 - EYD-11-101, 116-1016 Class I, Division 1 & 2, Groups B, C, D Class III
 - EYD1-10, 16-106 Class I, Division 1 & 2, Groups C, D Class III
 - EZD10-60, 111-611 Class I, Division 1 & 2, Groups C, D Class III
- UL Standard: 1203
- CSA Standard: C22.2

Applications:

Calbond PVC Coated Sealing Fittings are used in hazardous locations to prevent flame and gas from continuing to travel through the conduit system. PVC coating provides corrosion protection. A sealing compound should be used on the interior after wiring. Compound supplied by the original fitting manufacturer.



Sealing Fittings

EYS Female Hubs

Part Number	Trade Size (in)	Weight per 100 (lb)	A (in)	B (in)	Turning Radius
For Sealing in Vertical Positions ONLY					
PV0500EYS1	½	100	3.28	1.33	1.63
PV0700EYS2	¾	150	3.75	1.58	1.91
PV1000EYS3	1	210	4.31	1.83	2.38
For Sealing in Vertical or Horizontal Positions					
PV1200EYS4	1 ¼	270	5.06	2.27	1.72
PV1500EYS5	1 ½	370	5.50	2.52	2.06
PV2000EYS6	2	470	6.25	3.08	2.31
PV2500EYS7	2 ½	1,000	7.50	3.58	2.69
PV3000EYS8	3	1,120	8.50	4.33	3.31
PV3500EYS9	3 ½	1,450	9.19	4.83	3.44
PV4000EYS10	4	1,600	9.75	5.33	3.69
PV5000EYS012	5		11.06	6.50	4.59
PV6000EYS014	6		12.13	7.625	5.34

Part Number	Trade Size (in)	Weight per 100 (lb)	A (in)	B (in)	Turning Radius
For Sealing in Vertical or Horizontal Positions					
PV0500EYS11	½	130	3.69	1.33	1.16
PV0700EYS21	¾	110	3.69	1.58	1.25
PV1000EYS31	1	220	4.31	1.83	1.38
PV1200EYS41	1 ¼	300	5.06	2.27	1.72
PV1500EYS51	1 ½	380	5.50	2.52	2.06
PV2000EYS61	2	550	6.25	3.08	2.31
PV2500EYS71	2 ½		7.50	3.50	2.69
PV3000EYS81	3		8.50	4.25	3.31
PV3500EYS91	3 ½		9.19	4.75	3.44
PV4000EYS101	4		9.75	5.25	3.69

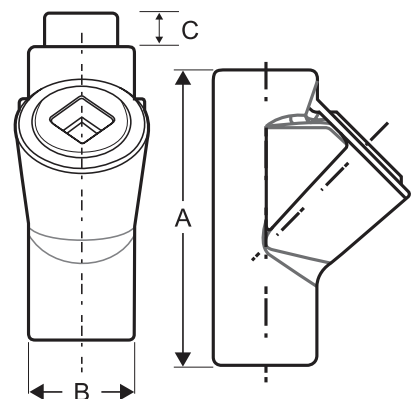

Aluminum EYS Female Hubs

Features:

- Exterior PVC coating thickness is a minimum 0.040"
- Interior Urethane coating thickness is a minimum 0.002"
- Sizes available are ½" to 4"
- The length of the sleeve extension(s) shall be at least equivalent to the nominal conduit size for sizes ½"- 2"
- For sizes 2½"- 4", the length of the sleeve extension(s) shall be at least 2".
- Sealing sleeve is provided on plug hub (patching compound recommended on top of plug)
- Mating sealing forms are provided on all caps
- Sealing sleeves on all conduit openings

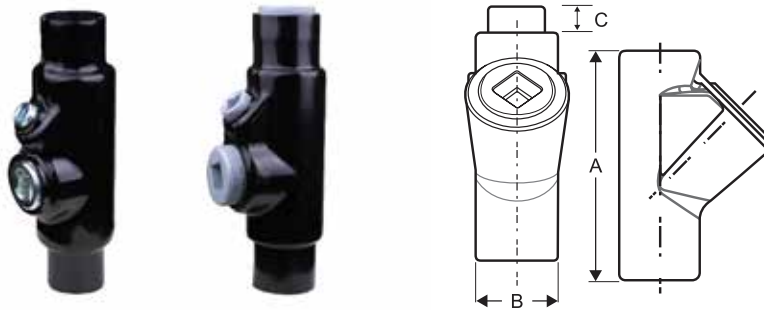

Aluminum Part Number	Trade Size (in)	Weight per 100 (lb)	A (in)	B (in)	Turning Radius
For Sealing in Vertical Positions ONLY					
PA0500EYS1SA	½	3.28	1.33	1.63	1.63
PA0700EYS2SA	¾	3.75	1.58	1.91	1.91
PA1000EYS3SA	1	4.31	1.83	2.38	2.38
For Sealing in Vertical or Horizontal Positions					
PA1200EYS4SA	1 ¼	5.06	2.27	1.72	1.72
PA1500EYS5SA	1 ½	5.50	2.52	2.06	2.06
PA2000EYS6SA	2	6.25	3.08	2.31	2.31
PA2500EYS7SA	2 ½	7.50	3.58	2.69	2.69
PA3000EYS8SA	3	8.50	4.33	3.31	3.31
PA3500EYS9SA	3 ½	9.19	4.83	3.44	3.44
PA4000EYS10SA	4	9.75	5.33	3.69	3.69
Aluminum Part Number	Trade Size (in)	Weight per 100 (lb)	A (in)	B (in)	Turning Radius
For Sealing in Vertical or Horizontal Positions					
PA0500EYS11SA	½	130	3.69	1.33	1.16
PA0700EYS21SA	¾	110	3.69	1.58	1.25
PA1000EYS31SA	1	220	4.31	1.83	1.38

Sealing Fittings

EYS Male - Female Hubs

Features:

- Exterior PVC coating thickness is a minimum 0.040"
- Interior Urethane coating thickness is a minimum 0.002"
- Sizes available are ½" to 4"
- The length of the sleeve extension(s) shall be at least equivalent to the nominal conduit size for sizes ½"- 2"
- For sizes 2 ½"- 4", the length of the sleeve extension(s) shall be at least 2".
- Sealing sleeve is provided on plug hub (patching compound recommended on top of plug)
- Mating sealing forms are provided on all caps
- Sealing sleeves on all conduit openings



Standards:

- NEC/CEC:
 - EYS1-3, 11-31, 16-36, 116-316 Class I, Division 1 & 2, Groups A, B, C, D Class III
 - EYS41-101, 416-1016 Class I, Division 1 & 2, Groups B, C, D Class III
 - EYS29, 4-014, 46-0146 EZS1-8, 16-86 Class I, Division 1 & 2, Groups C, D Class III
- UL Standard: 1203
- CSA Standard: C22.2

Applications:

Calbond PVC Coated Sealing Fittings are used in hazardous locations to prevent flame and gas from continuing to travel through the conduit system. PVC coating provides corrosion protection. A sealing compound should be used on the interior after wiring. Compound supplied by the original fitting manufacturer.

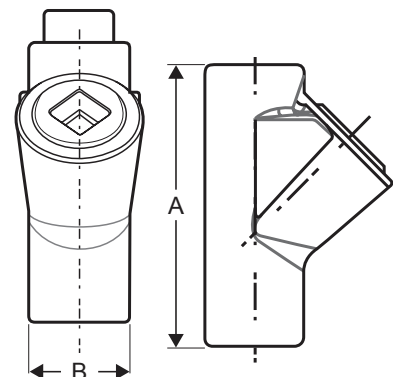

EYS Male - Female Hubs

Item Number	Trade Size (in)	Weight per 100 (lb)	A (in)	B (in)	Turning Radius (in)
For Sealing in Vertical Positions ONLY					
PV0500EYS16	½	150	3.28	1.33	1.63
PV0700EYS26	¾	150	3.75	1.58	1.91
PV1000EYS36	1	230	4.31	1.83	2.38
For Sealing in Vertical or Horizontal Positions					
PV1200EYS46	1 ¼	280	5.06	2.27	1.72
PV1500EYS56	1 ½	370	5.50	2.52	2.06
PV2000EYS66	2	560	6.25	3.08	2.31
PV2500EYS76	2 ½	1,320	7.50	3.58	2.69
PV3000EYS86	3	1,120	8.50	4.33	3.31
PV3500EYS96	3 ½	1,450	9.19	4.83	3.44
PV4000EYS106	4	150	9.75	5.33	3.69
PV5000EYS0126	5		11.06	6.50	4.59
PV6000EYS0146	6		12.13	7.625	5.34

Item Number	Trade Size (in)	Weight per 100 (lb)	A (in)	B (in)	Turning Radius (in)
For Sealing in Vertical or Horizontal Positions					
PV0500EYS116	½	100	3.69	1.33	1.16
PV0700EYS216	¾	120	3.69	1.58	1.25
PV1000EYS316	1	260	4.31	1.83	1.38
PV1200EYS416	1 ¼	300	5.06	2.27	1.72
PV1500EYS516	1 ½	380	5.50	2.52	2.06
PV2000EYS616	2	550	6.25	3.08	2.31
PV2500EYS716	2 ½		7.50	3.50	2.69
PV3000EYS816	3		8.50	4.25	3.31
PV3500EYS916	3 ½		9.19	4.75	3.44
PV4000EYS1016	4		9.75	5.25	3.69

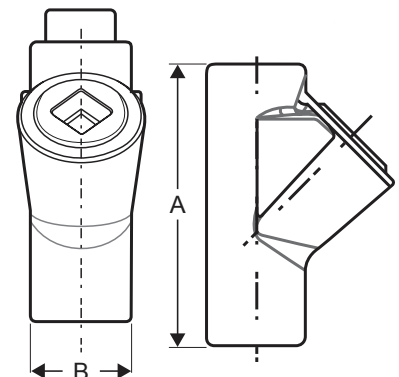

Sealing Fittings

Aluminum EYS Male - Female Hubs

Item Number	Trade Size (in)	Weight per 100 (lb)	A (in)	B (in)	Turning Radius (in)
For Sealing in Vertical Positions ONLY					
PA0500EYS16SA	½	150	3.28	1.33	1.63
PA0700EYS26SA	¾	150	3.75	1.58	1.91
PA1000EYS36SA	1	230	4.31	1.83	2.38
For Sealing in Vertical or Horizontal Positions					
PA1200EYS46SA	1 ¼	280	5.06	2.27	1.72
PA1500EYS56SA	1 ½	370	5.50	2.52	2.06
PA2000EYS66SA	2	560	6.25	3.08	2.31
PA2500EYS76SA	2 ½	1,320	7.50	3.58	2.69
PA3000EYS86SA	3	1,120	8.50	4.33	3.31
PA3500EYS96SA	3 ½	1,450	9.19	4.83	3.44
PA4000EYS106SA	4	150	9.75	5.33	3.69

Item Number	Trade Size (in)	Weight per 100 (lb)	A (in)	B (in)	Turning Radius (in)
For Sealing in Vertical or Horizontal Positions					
PA0500EYS116SA	½	100	3.69	1.33	1.16
PA0700EYS216SA	¾	120	3.69	1.58	1.25
PA1000EYS316SA	1	260	4.31	1.83	1.38
PA1200EYS416SA	1 ¼	300	5.06	2.27	1.72

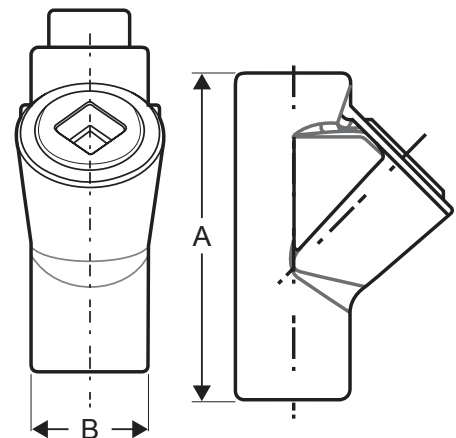

EZD Female Hubs

Features:

- Exterior PVC coating thickness is a minimum 0.040"
- Interior Urethane coating thickness is a minimum 0.002"
- Sizes available are ½" to 2"
- The length of the sleeve extension(s) shall be at least equivalent to the nominal conduit size for sizes ½"- 2"
- Mating sealing forms are provided on all caps

Standards:

- NEC/CEC:
EZD 111-611
Class I, Division 1 & 2,
Groups C, D Class III
- UL Standard: 1203
- CSA Standard: C22.2

Applications:

Calbond PVC Coated Sealing Fittings are used in hazardous locations to prevent flame and gas from continuing to travel through the conduit system. PVC coating provides corrosion protection. A sealing compound should be used on the interior after wiring. Compound supplied by the original fitting manufacturer.

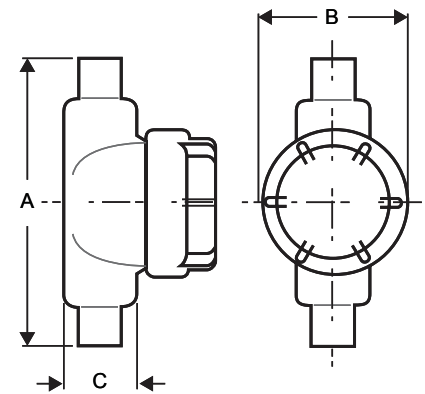

Item Number	Trade Size (in)	Weight per 100 (lb)	A (in)	B (in)	Turning Radius (in)
For Sealing in Any Position					
PV0500EZD111	½	4.19	3.08	3.46	2.06
PV0700EZD211	¾	4.19	3.08	3.71	2.19
PV1000EZD311	1	4.94	3.58	3.96	2.44
PV1200EZD411	1¼	4.94	3.58	4.39	2.63
PV1500EZD511	1½	5.19	3.58	4.64	2.69
PV2000EZD611	2	7.13	5.64	5.33	3.69

Sealing Fittings

EZS Female Hubs

Features:

- Exterior PVC coating thickness is a minimum 0.040"
- Interior Urethane coating thickness is a minimum 0.002"
- Sizes available are ½" to 3"
- The length of the sleeve extension(s) shall be at least equivalent to the nominal conduit size for sizes ½" - 2"
- For sizes 2 ½" - 3", the length of the sleeve extension(s) shall be at least 2"
- Mating sealing forms are provided on all caps



Standards:

- NEC/CEC:
EZD 111-611
Class I, Division 1 & 2,
Groups C, D Class III
- UL Standard: 1203
- CSA Standard: C22.2

Applications:

Calbond PVC Coated Sealing Fittings are used in hazardous locations to prevent flame and gas from continuing to travel through the conduit system. PVC coating provides corrosion protection. A sealing compound should be used on the interior after wiring. Compound supplied by the original fitting manufacturer.

Item Number	Trade Size (in)	Weight per 100 (lb)	A (in)	B (in)	Turning Radius (in)
For Sealing in Any Position					
PV0500EZS1	½	200	4.19	3.71	1.88
PV0700EZS2	¾	230	4.19	3.71	1.88
PV1000EZS3	1	270	4.94	4.05	2.13
PV1200EZS4	1¼	350	5.06	4.49	2.31
PV1500EZS5	1 ½	400	5.19	4.64	2.34
PV2000EZS6	2	820	7.06	5.49	3.28
PV2500EZS7	2½	850	7.94	5.92	3.38
PV3000EZS8	3	900	8.63	6.58	3.88

EZS Male-Female Hubs

Features:

- Exterior PVC coating thickness is a minimum 0.040"
- Interior Urethane coating thickness is a minimum 0.002"
- Sizes available are ½" to 3"
- The length of the sleeve extension(s) shall be at least equivalent to the nominal conduit size for sizes ½"- 2"
- For sizes 2 ½"- 3", the length of the sleeve extension(s) shall be at least 2"
- Mating sealing forms are provided on all caps
- Sealing sleeves on all conduit openings



Standards:

- NEC/CEC:
EZD 111-611
Class I, Division 1 & 2,
Groups C, D Class III
- UL Standard: 1203
- CSA Standard: C22.2

Applications:

Calbond PVC Coated Sealing Fittings are used in hazardous locations to prevent flame and gas from continuing to travel through the conduit system. PVC coating provides corrosion protection. A sealing compound should be used on the interior after wiring. Compound supplied by the original fitting manufacturer.

Item Number	Trade Size (in)	Weight per 100 (lb)	A (in)	B (in)	Turning Radius (in)
For Sealing in Any Position					
PV0500EZS16	½	200	4.19	2.58	1.88
PV0700EZS26	¾	240	4.19	2.58	1.88
PV1000EZS36	1	300	4.94	3.08	2.13
PV1200EZS46	1¼	400	5.06	3.08	2.31
PV1500EZS56	1½	460	5.19	3.33	3.34
PV2000EZS66	2	690	7.06	5.27	3.28
PV2500EZS76	2½	920	7.94	5.27	3.38
PV3000EZS86	3	870	8.63	5.96	3.88



Expansion Fittings



Expansion Fittings

XD Expansion/ Deflection Fitting	104
XJG Expansion Joints	105
XJGD Expansion Joints	106

XD Expansion/ Deflection Fitting

Features:

- Axial expansion or contraction up to ¾"
- Angular misalignment in any direction to 30°
- 40 mil carbon gray PVC exterior coating
- 2 mil light gray urethane interior coating
- XD in 10 trade sizes from 1" through 5"
- Sealing sleeves

Applications:

Calbond XD Expansion/Deflection Couplings are used with PVC coated rigid conduit to accommodate axial expansion, angular misalignment and parallel misalignment. They feature an internal bonding jumper. PVC coating and internal urethane coating provide for superior corrosion protection. Electrical continuity is maintained across assembled joints.



Galvanized Part Number	Trade Size (in)	A (in)	B (in)
PV1000XD3	1	7.000	3.94
PV1200XD4	1¼	7.375	4.25
PV1500XD5	1½	7.250	4.50
PV2000XD6	2	7.250	4.94
PV2500XD7	2½	7.500	5.31
PV3000XD8	3	7.625	5.94
PV3500XD9	3½	7.750	6.50
PV4000XD10	4	7.875	6.94
PV5000XD12	5	7.750	8.00

All dimensions are for informational purposes only *Tolerances +/- 5%

Expansion Joints

XJG Expansion Joint

Features:

- 40 mil PVC black coating
- 2 mil urethane interior coating
- Available in 9 trade sizes from ¾" through 4"
- Sealing sleeves

Standards:

- XJG EXPANSION JOINTS - 4" TRAVEL: Product Dimensions

Applications:

Calbond XJG Expansion Joints features an internal bonding jumper and facilitates horizontal movement of the conduit system of up to 4". PVC coating and internal urethane coating provide for superior corrosion protection. Electrical continuity is maintained across assembled joints.



Galvanized Part Number	Trade Size (in)	A (in)	B (in)	Nominal Weight (Galv.) (lb)
PV0700XJG24	¾	2.20	8.25	2.9
PV1000XJG34	1	2.51	9.25	3.6
PV1200XJG44	1¼	3.27	10.06	3.8
PV1500XJG54	1½	3.76	10.87	6.2
PV2000XJG64	2	4.83	12.25	7.3
PV2500XJG74	2½	4.95	13.31	9.8
PV3000XJG84	3	5.45	14.00	13.6
PV3500XJG94	3½	6.70	13.81	16.1
PV4000XJG104	4	6.70	13.81	22.5

All dimensions are for informational purposes only *Tolerances +/- 5%

XJGD Expansion Joints

Features:

- 40 mil carbon gray PVC exterior coating
- 2 mil light gray urethane interior coating
- XJGD in 8 trade sizes from 1" through 4"
- Sealing sleeves

Applications:

Calbond XJGD Expansion/Deflection Fittings are used with PVC coated rigid conduit to accommodate axial expansion, angular misalignment and parallel misalignment. They feature an internal bonding jumper. PVC coating and internal urethane coating provide for superior corrosion protection. Electrical continuity is maintained across assembled joints.



Galvanized Part Number	Trade Size (in)	A (in)	B (in)
PV1000XJGD34	1	3.94	18.25
PV1200XJGD44	1¼	4.25	19.44
PV1500XJGD54	1½	4.50	20.00
PV2000XJGD64	2	4.94	21.50
PV2500XJGD74	2½	5.31	22.80
PV3000XJGD84	3	5.94	23.60
PV3500XJGD94	3½	6.50	23.60
PV4000XJGD104	4	8.00	23.70

All dimensions are for informational purposes only *Tolerances +/- 5%



Pulling Elbows



Pulling Elbows

LBD Style Pulling Elbows

110

LBD Style Pulling Elbows

Features:

- Exterior PVC coating thickness is a minimum 0.040"
- Interior Urethane coating thickness is a minimum 0.002"
- Sizes available are ½" to 4"
- The length of the sleeve extension(s) shall be at least equivalent to the nominal conduit size for sizes ½"- 2"
- For sizes 2 ½"- 4", the length of the sleeve extension(s) shall be at least 2"
- PVC seal between fitting and cover



Standards:

- UL 514 B
- CSA C22.2 No. 18

Applications:

Calbond PVC Coated Aluminum Mogul Style Conduit Bodies are used to; act as pull outlets for conductors being installed, provide openings for making splices in conductors, and to provide access to conductors for maintenance and future system changes where an extra larger wiring space is required. They are available in all styles. Sealing mating between cover and fittings are provided.

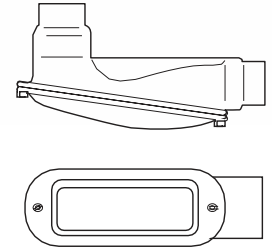

LBD Style Pulling Elbows

Part Number	Trade Size (in)
PV0500LBD1100	½
PV0700LBD2200	¾
PV1000LBD3300	1
PV1200LBD4400	1 ¼
PV1500LBD5500	1 ½
PV2000LBD6600	2
PV2500LBD7700	2 ½
PV3000LBD8800	3
PV3500LBD9900	3 ½
PV4000LBD10900	4

Aluminum LBD Style Pulling Elbows

Aluminum Part Number	Trade Size (in)	Weight per 100 (lb)
PA0500LBD1100SA	½	120
PA0700LBD2200SA	¾	200
PA1000LBD3300SA	1	250
PA1200LBD4400SA	1 ¼	600
PA1500LBD5500SA	1 ½	1,150
PA2000LBD6600SA	2	1,800
PA2500LBD7700SA	2 ½	2,200
PA3000LBD8800SA	3	3,500
PA3500LBD9900SA	3 ½	6,000
PA4000LBD10900SA	4	7,000



Mogul Fittings



Mogul Fittings

BC Mogul Fitting	114
BLB Mogul Fitting	115
BT Mogul Fitting	116
BUB Mogul Fitting	117
Mogul Fitting Covers	124

BC Mogul Fittings

Features:

- Exterior PVC coating thickness is a minimum 0.040"
- Interior Urethane coating thickness is a minimum 0.002"
- Sizes available are 1" to 4"
- Sealing sleeves on all hubs

Standards:

- UL Standard 514B
- CSA Standard: C22.2 No. 18



Applications:

Calbond PVC Coated Mogul Style Conduit Bodies are used to; act as pull outlets for conductors being installed, provide openings for making splices in conductors, and to provide access to conductors for maintenance and future system changes where an extra larger wiring space is required. They are available in all styles. Sealing mating between cover and fittings are provided.

BC

Part Number	Trade Size (in)	A (in)	B (in)	C (in)	D (in)	E (in)	Weight per 100 (lb)
PV1000BC3	1	7.31	1.92	2.27	1.88	6	3.2
PV1200BC4	1¼	8.50	2.35	2.27	1.88	6	4.0
PV1500BC5	1½	10.38	2.60	3.08	2.63	10	5.9
PV2000BC6	2	12.25	3.17	3.08	2.63	10	7.8
PV2500BC7	2½	15.63	3.67	4.33	3.81	15	12.5
PV3000BC8	3	15.63	4.42	4.33	3.81	15	17.0
PV3500BC9	3½	18.75	4.92	5.33	4.75	20	25.0
PV4000BC10	4	18.75	5.42	5.33	4.75	20	28.0

BC Aluminum Mogul Fittings

BC ALUMINUM

Part Number	Trade Size (in)	A (in)	B (in)	C (in)	D (in)	E (in)	Weight per 100 (lb)
PA1000BC3SA	1	7.31	1.92	2.27	1.88	6	3.2
PA1200BC4SA	1¼	8.50	2.35	2.27	1.88	6	4.0
PA1500BC5SA	1½	10.38	2.60	3.08	2.63	10	5.9
PA2000BC6SA	2	12.25	3.17	3.08	2.63	10	7.8
PA2500BC7SA	2½	15.63	3.67	4.33	3.81	15	12.5
PA3000BC8SA	3	15.63	4.42	4.33	3.81	15	17.0
PA3500BC9SA	3½	18.75	4.92	5.33	4.75	20	25.0
PA4000BC10SA	4	18.75	5.42	5.33	4.75	20	28.0

Mogul Fittings

BLB Mogul Fittings

Features:

- Exterior PVC coating thickness is a minimum 0.040"
- Interior Urethane coating thickness is a minimum 0.002"
- Sizes available are 1" to 4"
- Sealing sleeves on all hubs

Standards:

- UL Standard 514B
- CSA Standard: C22.2 No. 18



Applications:

Calbond PVC Coated Mogul Style Conduit Bodies are used to; act as pull outlets for conductors being installed, provide openings for making splices in conductors, and to provide access to conductors for maintenance and future system changes where an extra larger wiring space is required. They are available in all styles. Sealing mating between cover and fittings are provided.

BLB

Part Number	Trade Size (in)	A (in)	B (in)	C (in)	D (in)	E (in)	Weight per 100 (lb)
PV1000BLB3	1	9.63	2.88	2.27	1.88	6	3.2
PV1200BLB4	1¼	9.88	3.32	2.27	1.88	6	4.2
PV1500BLB5	1½	14.23	3.67	3.08	2.63	10	6.0
PV2000BLB6	2	14.73	4.23	3.08	2.63	10	7.0
PV2500BLB7	2½	18.95	5.13	4.33	3.81	15	13.8
PV3000BLB8	3	18.95	5.88	4.33	3.81	15	17.5
PV3500BLB9	3½	24.17	6.54	5.33	4.75	20	25.0
PV4000BLB10	4	24.17	7.04	5.33	4.75	20	28.0

BLB Aluminum Mogul Fittings

BLB ALUMINUM

Part Number	Trade Size (in)	A (in)	B (in)	C (in)	D (in)	E (in)	Weight per 100 (lb)
PA1000BLB3SA	1	9.63	2.88	2.27	1.88	6	3.2
PA1200BLB4SA	1¼	9.88	3.32	2.27	1.88	6	4.2
PA1500BLB5SA	1½	14.23	3.67	3.08	2.63	10	6.0
PA2000BLB6SA	2	14.73	4.23	3.08	2.63	10	7.0
PA2500BLB7SA	2½	18.95	5.13	4.33	3.81	15	13.8
PA3500BLB9SA	3	24.17	6.54	5.33	4.75	20	25.0
PA4000BLB10SA	3½	24.17	7.04	5.33	4.75	20	28.0
PV4000BLB10SA	4	24.17	7.04	5.33	4.75	20	28.0

BT Mogul Fittings

Features:

- Exterior PVC coating thickness is a minimum 0.040"
- Interior Urethane coating thickness is a minimum 0.002"
- Sizes available are 1" to 4"
- Sealing sleeves on all hubs

Standards:

- UL Standard 514B
- CSA Standard: C22.2 No. 18



Applications:

Calbond PVC Coated Mogul Style Conduit Bodies are used to; act as pull outlets for conductors being installed, provide openings for making splices in conductors, and to provide access to conductors for maintenance and future system changes where an extra larger wiring space is required. They are available in all styles. Sealing mating between cover and fittings are provided.

BT

Part Number	Trade Size (in)	A (in)	B (in)	C (in)	D (in)	E (in)	Weight per 100 (lb)
PV1000BT3	1	11.56	1.92	4.20	1.88	6	3.2
PV1200BT4	1¼	12.06	2.35	4.45	1.88	6	3.6
PV1500BT5	1½	16.75	2.60	5.60	2.63	10	7.5
PV2000BT6	2	17.75	3.17	6.10	2.63	10	9.0
PV2500BT7	2½	22.38	3.67	7.63	3.81	15	15.0
PV3000BT8	3	22.38	4.42	7.76	3.81	15	19.0
PV3500BT9	3½	27.75	4.92	8.92	4.75	20	29.0
PV4000BT10	4	27.75	5.42	8.92	4.75	20	32.0

BT Aluminum Mogul Fittings

BT ALUMINUM

Part Number	Trade Size (in)	A (in)	B (in)	C (in)	D (in)	E (in)	Weight per 100 (lb)
PA1000BT3SA	1	11.56	1.92	4.20	1.88	6	3.2
PA1200BT4SA	1¼	12.06	2.35	4.45	1.88	6	3.6
PA1500BT5SA	1½	16.75	2.60	5.60	2.63	10	7.5
PA2000BT6SA	2	17.75	3.17	6.10	2.63	10	9.0
PA2500BT7SA	2½	22.38	3.67	7.63	3.81	15	15.0
PA3000BT8SA	3	22.38	4.42	7.76	3.81	15	19.0
PA3500BT9SA	3½	27.75	4.92	8.92	4.75	20	29.0
PA4000BT10SA	4	27.75	5.42	8.92	4.75	20	32.0

Mogul Fittings

BUB Mogul Fittings

Features:

- Exterior PVC coating thickness is a minimum 0.040"
- Interior Urethane coating thickness is a minimum 0.002"
- Sizes available are 1" to 4"
- Sealing sleeves on all hubs

Standards:

- UL Standard 514B
- CSA Standard: C22.2 No. 18



Applications:

Calbond PVC Coated Mogul Style Conduit Bodies are used to; act as pull outlets for conductors being installed, provide openings for making splices in conductors, and to provide access to conductors for maintenance and future system changes where an extra larger wiring space is required. They are available in all styles. Sealing mating between cover and fittings are provided.

BUB

Part Number	Trade Size (in)	A (in)	B (in)	C (in)	D (in)	E (in)	Weight per 100 (lb)
PV1000BUB3	1	10.19	2.73	2.27	1.88	6	3.2
PV1200BUB4	1¼	11.06	3.23	2.27	1.88	6	4.0
PV1500BUB5	1½	15.00	3.54	3.08	2.63	10	5.9
PV2000BUB6	2	15.50	4.17	3.08	2.63	10	7.8
PV2500BUB7	2½	19.75	4.85	4.33	3.81	15	12.5
PV3000BUB8	3	19.88	6.57	4.33	3.81	15	17.0
PV3500BUB9	3½	25.38	6.42	5.33	4.75	20	25.0
PV4000BUB10	4	25.25	6.85	5.33	4.75	20	28.0

BUB Aluminum Mogul Fittings

BUB ALUMINUM

Part Number	Trade Size (in)	A (in)	B (in)	C (in)	D (in)	E (in)	Weight per 100 (lb)
PA1000BUB3SA	1	10.19	2.73	2.27	1.88	6	3.2
PA1200BUB4SA	1¼	11.06	3.23	2.27	1.88	6	4.0
PA1500BUB5SA	1½	15.00	3.54	3.08	2.63	10	5.9
PA2000BUB6SA	2	15.50	4.17	3.08	2.63	10	7.8
PA2500BUB7SA	2½	19.75	4.85	4.33	3.81	15	12.5
PA3000BUB8SA	3	19.88	6.57	4.33	3.81	15	17.0
PA3500BUB9SA	3½	25.38	6.42	5.33	4.75	20	25.0
PA4000BUB10SA	4	25.25	6.85	5.33	4.75	20	28.0

Mogul Fittings Covers

Features:

- Exterior PVC coating thickness is a minimum 0.040"
- Interior Urethane coating thickness is a minimum 0.002"
- Sizes available are 1" to 4"
- Sealing sleeves on all hubs

Standards:

- UL Standard 514B
- CSA Standard: C22.2 No. 18



Applications:

Calbond PVC Coated Mogul Style Conduit Bodies are used to; act as pull outlets for conductors being installed, provide openings for making splices in conductors, and to provide access to conductors for maintenance and future system changes where an extra larger wiring space is required. They are available in all styles. Sealing mating between cover and fittings are provided.

Fittings Covers

Part Number	Trade Size (in)	Weight per 100 (lb)
PV1012BG48	1 - 1¼	250
PV1520BG68	1½ - 2	320
PV2530BG88	2½ - 3	640
PV3540BG98	3½ - 4	980

Aluminum Mogul Fittings Covers

Fittings Cover Aluminum

Aluminum Part Number	Trade Size (in)
PA1012BG48SA	1 - 1¼
PA1520BG68SA	1½ - 2
PA2530BG88SA	2½ - 3
PA3540BG98SA	3½ - 4



Malleable Fittings



Malleable Fittings

90° Female-Female Malleable Fittings	122
90° Male-Female Malleable Fittings	123
90° Male-Male Malleable Fittings	124

90° Female - Female Malleable Fittings

Features:

- Exterior PVC coating thickness is a minimum 0.040"
- Interior urethane coating thickness is a minimum 0.002"
- Sizes available are ½" to 2½"



Standards:

- NEC/CEC EL 19-39 Class I, Division 1 & 2, Groups A, B, C, D Class III, EL 49-79 Class I, Division 1 & 2, Groups C, D Class III
- UL Standard: 886
- CSA Standard: C22.2 No. 30

Applications:

Calbond PVC EL Style Elbows are used where a very tight radius elbow is required. They are available with female & male threaded connections. Female threaded hubs are supplied with a sealing sleeve. Male ends are supplied with a sealing form.

Part Number	Trade Size (in)	A (in)	Weight per 100 (lb)
PV0500EL19	½	2.03	70
PV0700EL29	¾	2.50	90
PV1000EL39	1	3.00	120
PV1200EL49	1¼	3.50	240
PV1500EL59	1½	5.50	300
PV2000EL69	2	7.00	600
PV2500EL79	2½	8.44	790

90° Female - Female Aluminum Malleable Fittings

Part Number	Trade Size (in)	A (in)
PA0500EL19SA	½	2.03
PA0700EL29SA	¾	2.50
PA1000EL39SA	1	3.00
PA1200EL49SA	1¼	3.50
PA1500EL59SA	1½	5.50
PA2000EL69SA	2	7.00
PA2500EL79SA	2½	8.44

Malleable Fittings

90° Male - Female Malleable Fittings

Features:

- Exterior PVC coating thickness is a minimum 0.040"
- Interior urethane coating thickness is a minimum 0.002"
- Sizes available are ½" to 1"



Standards:

- NEC/CEC EL 196-396 Class I, Division 1 & 2, Groups A, B, C, D Class III
- UL Standard: 886
- CSA Standard: C22.2 No. 30

Applications:

Calbond PVC EL Style Elbows are used where a very tight radius elbow is required. They are available with female & male threaded connections. Female threaded hubs are supplied with a sealing sleeve. Male ends are supplied with a sealing form.

Part Number	Trade Size (in)	A (in)
PV0500EL196	½	2.03
PV0700EL296	¾	2.38
PV1000EL396	1	2.38

90° Male - Female Aluminum Malleable Fittings

Part Number	Trade Size (in)	A (in)	Weight per 100 (lb)
PA0500EL196SA	½	2.03	30
PA0700EL296SA	¾	2.38	50
PA1000EL396SA	1	2.88	120

90° Male - Male Malleable Fittings

Features:

- Exterior PVC coating thickness is a minimum 0.040"
- Interior urethane coating thickness is a minimum 0.002"
- Sizes available are ½" to 1"



Standards:

- NEC/CEC EL 19-39 Class I, Division 1 & 2, Groups A, B, C, D Class III, EL 49-79 Class I, Division 1 & 2, Groups C, D Class III
- UL Standard: 886
- CSA Standard: C22.2 No. 30

Applications:

Calbond PVC EL Style Elbows are used where a very tight radius elbow is required. They are available with female & male threaded connections. Female threaded hubs are supplied with a sealing sleeve. Male ends are supplied with a sealing form.

Part Number	Trade Size (in)	A (in)	Weight Per 100 (lb)
PV0500EL195	½	1.44	30
PV0700EL295	¾	1.63	50
PV1000EL395	1	1.88	70



Liquidtight Connectors



Liquidtight Connectors

Straight Liquidtight Connectors	128
45 Degree Liquidtight Connectors	132
90 Degree Liquidtight Connectors	134
Liquidtight to Rigid Connectors	138

PVC Coated Liquidtight Connectors - Straight

Features:

- Exterior PVC coating thickness is a minimum 0.040"
- Sizes available are 3/8" to 4"
- The length of the sleeve extension(s) shall be at least equivalent to the nominal conduit size for sizes 1/2" - 2"
- For sizes 2 1/2" - 4", the length of the sleeve extension(s) shall be at least 2"
- Available in straight, 45 degree or 90 degree body configurations

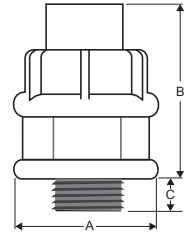

Standards:

- UL Standard 514B
- CSA Standard: C22.2 No. 18

Applications:

Calbond PVC Coated Liquidtight Connectors are used with Liquidtight Conduit to terminate the conduit run. The sleeve on the liquidtight connector is sized specifically to tighten around PVC conduit. Pulling compound is recommended for ease of installation. Fittings are provided with a flexible sleeve on the conduit side and a sealing form on both the box side and the mating part of the gland.

Straight

Part Number	Trade Size (in)	A (in)	B (in)	C (in)	Weight per 100 (lb)
PV0300LT38	3/8	1.24	1.88	0.56	20
PV0500LT50	1/2	1.46	2.06	0.56	20
PV0700LT75	3/4	1.74	2.38	0.56	30
PV1000LT100	1	1.96	3.06	0.75	40
PV1200LT125	1 1/4	2.36	3.75	0.81	80
PV1500LT150	1 1/2	2.80	4.19	0.81	90
PV2000LT200	2	3.33	5.06	0.88	170
PV2500LT250	2 1/2	3.83	6.13	1.00	300
PV3000LT300	3	4.58	6.25	1.00	420
PV4000LT400	4	5.58	6.50	1.13	620

All dimensions are for informational purposes only *Tolerances +/- 5%

Liquidtight Connectors

PVC Coated Liquidtight Connectors - Straight with Ground

Features:

- Exterior PVC coating thickness is a minimum 0.040"
- Sizes available are 3/8" to 4"
- The length of the sleeve extension(s) shall be at least equivalent to the nominal conduit size for sizes 1/2" - 2"
- For sizes 2 1/2" - 4", the length of the sleeve extension(s) shall be at least 2"
- Available in straight, 45 degree or 90 degree body configurations



Standards:

- UL Standard 514B
- CSA Standard: C22.2 No. 18

Applications:

Calbond PVC Coated Liquidtight Connectors are used with Liquidtight Conduit to terminate the conduit run. The sleeve on the liquidtight connector is sized specifically to tighten around PVC conduit. Pulling compound is recommended for ease of installation. Fittings are provided with a flexible sleeve on the conduit side and a sealing form on both the box side and the mating part of the gland.

ST w/Ground

Part Number	Trade Size (in)	A (in)	B (in)	C (in)	Ground Wire	Weight per 100 (lb)
PV0300LT38G	3/8	1.24	1.88	0.56	14-8	20
PV0500LT50G	1/2	1.46	2.06	0.56	14-8	20
PV0700LT75G	3/4	1.74	2.38	0.56	14-4	30
PV1000LT100G	1	1.96	3.06	0.75	14-4	40
PV1200LT125G	1 1/4	2.33	3.75	0.81	14-4	80
PV1500LT150G	1 1/2	3.33	4.19	0.81	14-4	90
PV2000LT200G	2	3.89	5.06	0.88	14-4	170
PV2500LT250G	2 1/2	4.52	6.13	1.00	1/0-8	300
PV3000LT300G	3	5.27	6.25	1.00	1/0-8	420
PV4000LT400G	4	6.21	6.50	1.13	3/0-6	620

All dimensions are for informational purposes only *Tolerances +/- 5%

PVC Coated Aluminum Liquidtight Connectors - Straight

Features:

- Exterior PVC coating thickness is a minimum 0.040"
- Sizes available are ½" to 4"
- The length of the sleeve extension(s) shall be at least equivalent to the nominal conduit size for sizes ½"- 2"
- For sizes 2 ½"- 4", the length of the sleeve extension(s) shall be at least 2"
- Available in straight, 45 degree or 90 degree body configurations

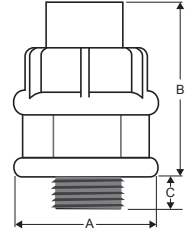

Standards:

- UL Standard 514B
- CSA Standard: C22.2 No. 18

Applications:

Calbond PVC coated aluminum liquidtight connectors are used with Aluminum Liquidtight Conduit to terminate the conduit run. The sleeve on the aluminum liquidtight connector is sized specifically to tighten around PVC conduit. Pulling compound is recommended for ease of installation. Fittings are provided with a flexible sleeve on the conduit side and a sealing form on both the box side and the mating part of the gland.

Aluminum - Straight

Part Number	Trade Size (in)	A (in)	B (in)	C (in)	Weight per 100 (lb)
PA0500LT50SA	½	1.46	2.06	0.56	20
PA0700LT75SA	¾	1.74	2.38	0.56	30
PA1000LT100SA	1	1.96	3.06	0.75	40
PA1200LT125SA	1¼	2.36	3.75	0.81	80
PA1500LT150SA	1½	2.80	4.19	0.81	90
PA2000LT200SA	2	3.33	5.06	0.88	170
PA2500LT250SA	2½	3.83	6.13	1.00	300
PA3000LT300SA	3	4.58	6.25	1.00	420
PA4000LT400SA	4	5.58	6.50	1.13	620

All dimensions are for informational purposes only *Tolerances +/- 5%

Liquidtight Connectors

PVC Coated Aluminum Liquidtight Connectors - Straight with Ground

Features:

- Exterior PVC coating thickness is a minimum 0.040"
- Sizes available are ½" to 4"
- The length of the sleeve extension(s) shall be at least equivalent to the nominal conduit size for sizes ½"- 2"
- For sizes 2 ½"- 4", the length of the sleeve extension(s) shall be at least 2"
- Available in straight, 45 degree or 90 degree body configurations



Standards:

- UL Standard 514B
- CSA Standard: C22.2 No. 18

Applications:

Calbond PVC coated aluminum liquidtight connectors are used with Aluminum Liquidtight Conduit to terminate the conduit run. The sleeve on the aluminum liquidtight connector is sized specifically to tighten around PVC conduit. Pulling compound is recommended for ease of installation. Fittings are provided with a flexible sleeve on the conduit side and a sealing form on both the box side and the mating part of the gland.

Aluminum - ST w/Ground

Part Number	Trade Size (in)	A (in)	B (in)	C (in)	Ground Wire	Weight per 100 (lb)
PA0500LT50GSA	½	1.46	2.06	0.56	14-8	20
PA0700LT75GSA	¾	1.74	2.38	0.56	14-4	30
PA1000LT100GSA	1	1.96	3.06	0.75	14-4	40
PA1200LT125GSA	1¼	2.33	3.75	0.81	14-4	80
PA1500LT150GSA	1½	3.33	4.19	0.81	14-4	90
PA2000LT200GSA	2	3.89	5.06	0.88	14-4	170
PA2500LT250GSA	2½	4.52	6.13	1.00	1/0-8	300
PA3000LT300GSA	3	5.27	6.25	1.00	1/0-8	420
PA4000LT400GSA	4	6.21	6.50	1.13	3/0-6	620

All dimensions are for informational purposes only *Tolerances +/- 5%

PVC Coated Liquidtight Connectors - 45°

Features:

- Exterior PVC coating thickness is a minimum 0.040"
- Sizes available are ½" to 4"
- The length of the sleeve extension(s) shall be at least equivalent to the nominal conduit size for sizes ½" - 2"
- For sizes 2½" - 4", the length of the sleeve extension(s) shall be at least 2"
- Available in straight, 45 degree or 90 degree body configurations

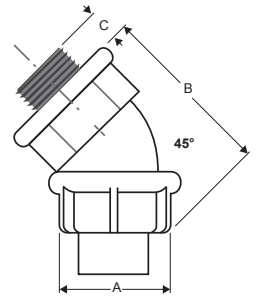

Standards:

- UL Standard 514B
- CSA Standard: C22.2 No. 18

Applications:

Calbond PVC Coated Liquidtight Connectors are used with Liquidtight Conduit to terminate the conduit run. The sleeve on the liquidtight connector is sized specifically to tighten around PVC conduit. Pulling compound is recommended for ease of installation. Fittings are provided with a flexible sleeve on the conduit side and a sealing form on both the box side and the mating part of the gland.

45°

Part Number	Trade Size (in)	A (in)	B (in)	C (in)	Weight per 100 (lb)
PV0300LT3845	⅜	1.24	1.94	0.56	30
PV0500LT5045	½	1.46	2.38	0.56	30
PV0700LT7545	¾	1.74	2.88	0.56	40
PV1000LT10045	1	1.96	3.25	0.75	50
PV1200LT12545	1¼	2.36	4.00	0.81	150
PV1500LT15045	1½	2.80	4.88	0.81	120
PV2000LT20045	2	3.33	5.88	0.88	200
PV2500LT25045	2½	3.83	6.25	1.00	300
PV3000LT30045	3	4.58	6.25	1.00	420
PV4000LT40045	4	5.58	6.63	1.13	620

All dimensions are for informational purposes only *Tolerances +/- 5%

Liquidtight Connectors

PVC Coated Liquidtight Connectors - 45° with Ground

Features:

- Exterior PVC coating thickness is a minimum 0.040"
- Sizes available are ½" to 4"
- The length of the sleeve extension(s) shall be at least equivalent to the nominal conduit size for sizes ½"- 2"
- For sizes 2½"- 4", the length of the sleeve extension(s) shall be at least 2"
- Available in straight, 45 degree or 90 degree body configurations

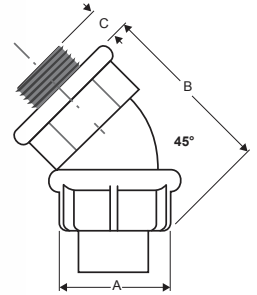

Standards:

- UL Standard 514B
- CSA Standard: C22.2 No. 18

Applications:

Calbond PVC Coated Liquidtight Connectors are used with Liquidtight Conduit to terminate the conduit run. The sleeve on the liquidtight connector is sized specifically to tighten around PVC conduit. Pulling compound is recommended for ease of installation. Fittings are provided with a flexible sleeve on the conduit side and a sealing form on both the box side and the mating part of the gland.

45° w/Ground

Part Number	Trade Size (in)	A (in)	B (in)	C (in)	Ground Wire	Weight per 100 (lb)
PV0300LT3845G	⅜	1.24	1.94	0.56	14-8	30
PV0500LT5045G	½	1.46	2.38	0.56	14-8	30
PV0700LT7545G	¾	1.74	2.88	0.56	14-4	40
PV1000LT10045G	1	1.96	3.25	0.75	14-4	50
PV1200LT12545G	1¼	3.33	4.00	0.81	14-4	150
PV1500LT15045G	1½	3.33	4.88	0.81	14-4	120
PV2000LT20045G	2	3.89	5.88	0.88	14-4	200
PV2500LT25045G	2½	4.52	6.25	1.00	1/0-8	300
PV3000LT30045G	3	5.27	6.25	1.00	1/0-8	420
PV4000LT40045G	4	6.21	6.63	1.13	3/0-6	620

All dimensions are for informational purposes only *Tolerances +/- 5%

PVC Coated Liquidtight Connectors - 90°

Features:

- Exterior PVC coating thickness is a minimum 0.040"
- Sizes available are ½" to 4"
- The length of the sleeve extension(s) shall be at least equivalent to the nominal conduit size for sizes ½"- 2"
- For sizes 2½"- 4", the length of the sleeve extension(s) shall be at least 2"
- Available in straight, 45 degree or 90 degree body configurations

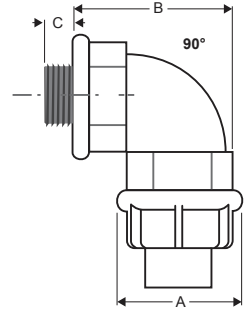

Standards:

- UL Standard 514B
- CSA Standard: C22.2 No. 18

Applications:

Calbond PVC Coated Liquidtight Connectors are used with Liquidtight Conduit to terminate the conduit run. The sleeve on the liquidtight connector is sized specifically to tighten around PVC conduit. Pulling compound is recommended for ease of installation. Fittings are provided with a flexible sleeve on the conduit side and a sealing form on both the box side and the mating part of the gland.

90°

Part Number	Trade Size (in)	A (in)	B (in)	C (in)	Weight per 100 (lb)
PV0300LT3890	⅜	1.24	1.80	0.56	30
PV0500LT5090	½	1.46	2.10	0.56	30
PV0700LT7590	¾	1.74	2.54	0.56	40
PV1000LT10090	1	1.96	3.23	0.75	50
PV1200LT12590	1¼	2.36	4.04	0.81	150
PV1500LT15090	1½	2.80	4.48	0.81	120
PV2000LT20090	2	3.33	5.48	0.88	200
PV2500LT25090	2½	3.83	10.92	1.00	300
PV3000LT30090	3	4.58	12.3	1.00	420
PV4000LT40090	4	5.58	14.7	1.13	620

All dimensions are for informational purposes only *Tolerances +/- 5%

Liquidtight Connectors

PVC Coated Liquidtight Connectors - 90° with Ground

Features:

- Exterior PVC coating thickness is a minimum 0.040"
- Sizes available are ½" to 4"
- The length of the sleeve extension(s) shall be at least equivalent to the nominal conduit size for sizes ½" - 2"
- For sizes 2½" - 4", the length of the sleeve extension(s) shall be at least 2"
- Available in straight, 45 degree or 90 degree body configurations

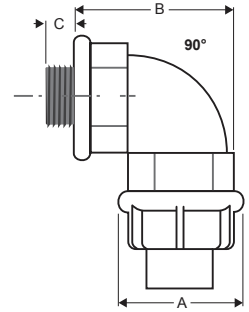

Standards:

- UL Standard 514B
- CSA Standard: C22.2 No. 18

Applications:

Calbond PVC Coated Liquidtight Connectors are used with Liquidtight Conduit to terminate the conduit run. The sleeve on the liquidtight connector is sized specifically to tighten around PVC conduit. Pulling compound is recommended for ease of installation. Fittings are provided with a flexible sleeve on the conduit side and a sealing form on both the box side and the mating part of the gland.

90° w/Ground

Part Number	Trade Size (in)	A (in)	B (in)	C (in)	Ground Wire	Weight per 100 (lb)
PV0300LT3890G	⅜	1.24	1.80	0.56	14-8	30
PV0500LT5090G	½	1.46	2.10	0.56	14-8	30
PV0700LT7590G	¾	1.74	2.54	0.56	14-4	40
PV1000LT10090G	1	1.96	3.23	0.75	14-4	50
PV1200LT12590G	1¼	2.36	4.04	0.81	14-4	150
PV1500LT15090G	1½	2.80	4.48	0.81	14-4	120
PV2000LT20090G	2	3.33	5.48	0.88	14-4	200
PV2500LT25090G	2½	3.83	10.92	1.00	1/0-8	300
PV3000LT30090G	3	4.58	12.3	1.00	1/0-8	420
PV4000LT40090G	4	5.58	14.7	1.13	3/0-6	620

All dimensions are for informational purposes only *Tolerances +/- 5%

PVC Coated Aluminum Liquidtight Connectors - 90°

Features:

- Exterior PVC coating thickness is a minimum 0.040"
- Sizes available are ½" to 4"
- The length of the sleeve extension(s) shall be at least equivalent to the nominal conduit size for sizes ½"- 2"
- For sizes 2½"- 4", the length of the sleeve extension(s) shall be at least 2"
- Available in straight, 45 degree or 90 degree body configurations

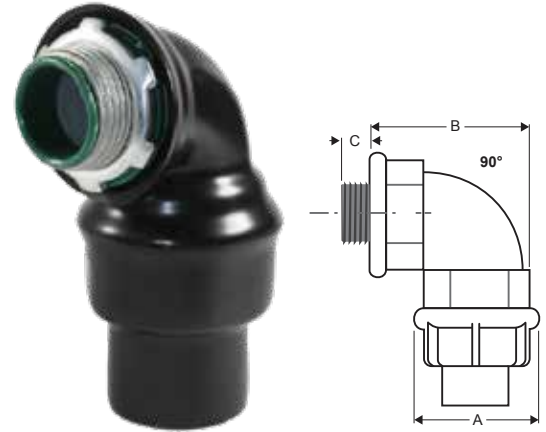

Standards:

- UL Standard 514B
- CSA Standard: C22.2 No. 18

Applications:

Calbond PVC Coated Liquidtight Connectors are used with Liquidtight Conduit to terminate the conduit run. The sleeve on the liquidtight connector is sized specifically to tighten around PVC conduit. Pulling compound is recommended for ease of installation. Fittings are provided with a flexible sleeve on the conduit side and a sealing form on both the box side and the mating part of the gland.

Aluminum - 90°

Part Number	Trade Size (in)	A (in)	B (in)	C (in)
PA0500LT5090SA	½	1.46	2.10	0.56
PA0700LT7590SA	¾	1.74	2.54	0.56
PA1000LT10090SA	1	1.96	3.23	0.75
PA1200LT12590SA	1 ¼	2.36	4.04	0.81
PA1500LT15090SA	1 ½	2.80	4.48	0.81
PA2000LT20090SA	2	3.33	5.48	0.88
PA0500LT5090GSA	½	1.46	1.98	0.56
PA0700LT7590GSA	¾	1.96	2.85	0.75
PA1000LT10090GSA	1	1.96	3.10	0.75

All dimensions are for informational purposes only *Tolerances +/- 5%

Liquidtight Connectors

PVC Coated Aluminum Liquidtight Connectors - 90° with Ground

Features:

- Exterior PVC coating thickness is a minimum 0.040"
- Sizes available are 1¼" to 4"
- The length of the sleeve extension(s) shall be at least equivalent to the nominal conduit size for sizes ½" - 2"
- For sizes 2½" - 4", the length of the sleeve extension(s) shall be at least 2"
- Available in straight, 45 degree or 90 degree body configurations

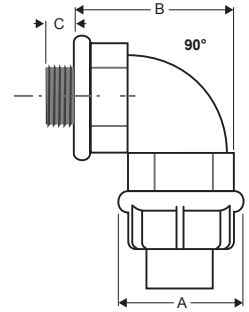

Standards:

- UL Standard 514B
- CSA Standard: C22.2 No. 18

Applications:

Calbond PVC Coated Liquidtight Connectors are used with Liquidtight Conduit to terminate the conduit run. The sleeve on the liquidtight connector is sized specifically to tighten around PVC conduit. Pulling compound is recommended for ease of installation. Fittings are provided with a flexible sleeve on the conduit side and a sealing form on both the box side and the mating part of the gland.

Aluminum - 90° w/Ground

Part Number	Trade Size (in)	A (in)	B (in)	C (in)
PA1200LT12590GSA	1 ¼	2.33	3.79	0.81
PA1500LT15090GSA	1 ½	3.33	4.48	0.81
PA2000LT20090GSA	2	3.89	5.48	0.88

All dimensions are for informational purposes only *Tolerances +/- 5%

PVC Coated Liquidtight to Rigid Coupling

Features:

- Exterior PVC coating thickness is a minimum 0.040”
- Sizes available are 3/8” to 2”
- The length of the sleeve extension(s) shall be at least equivalent to the nominal conduit size for sizes 1/2” - 2”

Standards:

- UL Standard 514B
- CSA Standard: C22.2 No. 18

Applications:

Calbond PVC coated liquidtight connectors are used with Liquidtight Conduit. The sleeve on the liquidtight connector is sized specifically to tighten around PVC conduit. Pulling compound is recommended for ease of installation. Fittings are provided with a flexible sleeve on the conduit side and a sealing form on both the box side and the mating part of the gland.

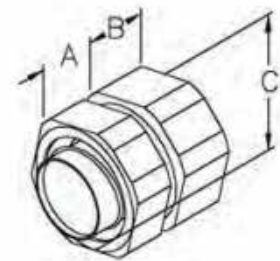

Part Number	Trade Size (in)	A (in)	B (in)	C (in)	Weight per 100 (lb)
PV0300LTR38	3/8	1.24	1.88	0.56	20
PV0500LTR50	1/2	1.46	2.06	0.56	20
PV0700LTR75	3/4	1.74	2.38	0.56	30
PV1000LTR100	1	1.96	3.06	0.75	40
PV1200LTR125	1 1/4	2.36	3.75	0.81	80
PV1500LTR150	1 1/2	2.80	4.19	0.81	90
PV2000LTR200	2	3.33	5.06	0.88	170

All dimensions are for informational purposes only *Tolerances +/- 5%



TECK Connectors



TECK Connectors

TECK Connectors

142

TECK Connectors

Features:

- Manufactured in aluminum for increased corrosion resistance
- One piece compact design
- Unique Grounding Seal for superior connectivity
- No Disassembly required for easy & fast installations
- Neoprene bushing provides pull out and sealing protection

Standards:

- NEMA 4, IP65
- Body - Aluminum

Applications:

Calbond PVC Coated Aluminum TECK Connectors are designed to form a watertight seal around the jacketed metal cable and at the enclosure entry. Rated NEMA 4 and IP 65, these connectors are in-stock in ½" to 4" hub sizes.



Part Number	Trade Size (in)	Exposed Armor Length (in)	Cable Range Over Jacket		Cable Range Over Armor		Dimension A (in)	Dimension B (in)
			Min (in)	Max (in)	Min (in)	Max (in)		
PA0500RTK-1	½	⅞	0.525	0.650	0.415	0.570	2.10	1.53
PA0500RTK-2	½	⅞	0.650	0.776	0.540	0.695	2.10	1.53
PA0500RTK-3	½	⅞	0.750	0.875	0.640	0.795	2.10	1.53
PA0500RTK-4	½	⅞	0.860	0.985	0.750	0.905	2.10	1.53
PA0700RTK-5	¾	1	0.955	1.080	0.845	1.000	2.45	2.20
PA0700RTK-6	¾	1	1.080	1.205	0.970	1.125	2.45	2.20
PA1000RTK-7	1	1	1.205	1.350	1.095	1.270	2.45	2.47
PA1200RTK-8	1 ¼	1¼	1.350	1.475	1.240	1.395	3.35	2.97
PA1200RTK-9	1 ¼	1¼	1.475	1.600	1.365	1.520	3.35	2.97
PA1200RTK-10	1 ¼	1¼	1.600	1.725	1.490	1.645	3.35	2.97
PA1500RTK-11	1 ½	1½	1.725	1.850	1.615	1.770	3.70	3.50
PA1500RTK-12	1 ½	1½	1.850	1.975	1.740	1.895	3.70	3.50
PA1500RTK-13	1 ½	1½	1.975	2.100	2.020	2.020	3.70	3.50
PA2000RTK-14	2	1¾	2.100	2.225	1.990	2.145	4.05	4.15
PA2000RTK-15	2	1¾	2.225	2.350	2.115	2.270	4.05	4.15
PA2000RTK-16	2	1¾	2.350	2.475	2.240	2.395	4.05	4.15
PA2000RTK-17	2	1¾	2.475	2.600	2.365	2.520	4.05	4.15
PA2000RTK-18	2	1¾	2.600	2.700	2.490	2.645	4.05	4.15
PA2500RTK-19	2 ½	1¾	2.700	2.850	2.560	2.760	4.10	4.60
PA2500RTK-20	2 ½	1¾	2.850	3.000	2.710	2.910	4.10	4.60
PA3000RTK-21	3	1¾	3.000	3.150	2.860	3.060	4.50	5.68
PA3000RTK-22	3	1¾	3.150	3.300	3.010	3.210	4.50	5.68
PA3000RTK-23	3	1¾	3.300	3.450	3.160	3.360	4.50	5.68
PA3500RTK-24	3 ½	1¾	3.450	3.600	3.300	3.500	4.60	6.02
PA3500RTK-25	3 ½	1¾	3.600	3.750	3.450	3.650	4.60	6.02
PA3500RTK-26	3 ½	1¾	3.750	3.900	3.600	3.800	4.60	6.02
PA4000RTK-27	4	1¾	3.900	4.050	3.750	3.940	4.75	6.52
PA4000RTK-28	4	1¾	4.050	4.200	3.900	4.090	4.75	6.52
PA4000RTK-29	4	1¾	4.200	4.350	4.050	4.240	4.75	6.52

All dimensions are for informational purposes only *Tolerances +/- 5%

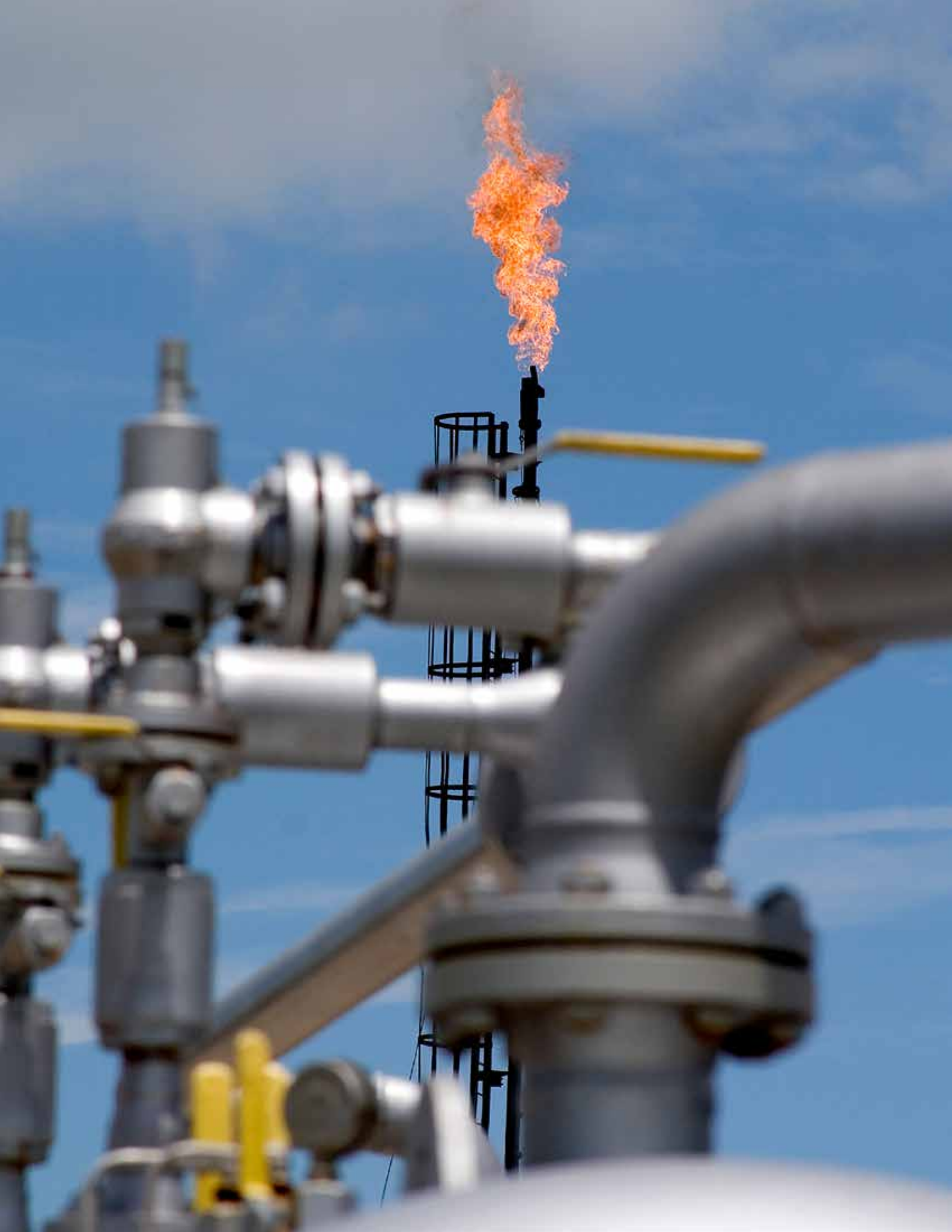

Strut & Strut Straps



Strut & Strut Straps

PVC Coated Strut
Strut Straps

146
147

PVC Coated Struts

Features:

- Exterior PVC coating thickness is a minimum 0.02"
- 3 trade sizes and 5 standard styles

Applications:

Calbond PVC Coated Strut is a versatile system of structural elements that can be used to build supports for a variety of applications used in mechanical and electrical installations. Calbond offers 5 standard styles of strut: Standard, Back to Back, Slotted Standard, Shallow and Slotted Shallow.



Standard



Back to Back



Slotted Standard

Item Number	Trade Size (in)	Gauge Metal	Weight per 100 (lb)	Standard Pack
PV0000B22	1 5/8 x 1 5/8	Standard	12 ga.	200
PV0000B22A	1 5/8 x 3 1/4	Back to Back	12 ga.	380
PV0000B22SH	1 5/8 x 1 5/8	Slotted Standard	12 ga.	185
PV0000B52	1 5/8 x 7/8	Shallow	12 ga.	135
PV0000B52SH	1 5/8 x 7/8	Slotted Shallow	12 ga.	130

Strut & Strut Straps

PVC Coated Strut Straps

Features:

- 20 mil black PVC exterior coating
- 11 Trade sizes ½" to 5"

Applications:

Calbond PVC Coated Strut Straps are used with coated strut to support conduit installations in a variety of configurations. Straps may be used in either vertical or horizontal positions to support conduit. Straps provided with stainless steel hardware. Conduit spacing may be as close together as allowed by the couplings.



Item Number	Trade Size (in)	Style	Strut Thickness (in)	Weight per 100 (lb)
PV0500B2008	½	14	13.0	100
PV0700B2009	¾	14	15.0	100
PV1000B2010	1	14	17.0	100
PV1200B2011	1¼	12	19.5	100
PV1500B2012	1½	12	28.0	100
PV2000B2013	2	12	31.0	50
PV2500B2014	2½	12	36.0	50
PV3000B2015	3	12	42.0	50
PV3500B2016	3½	11	56.0	25
PV4000B2017	4	11	64.0	25
PV5000B2019	5	10	76.0	25



Strut Accessories



Strut Accessories & Beam Clamps

Grounding Bushings	156
U-Bolts	151
Mini Hangers	152
J-Hanger Pipe Straps	153
2-Hole Straps	154
1-Hole Malleable Straps	154
Clamp Back Spacers	154

Grounding Bushings

Features:

- Exterior PVC coating - 0.020" (20 mil)
- 10 trade sizes available are ½" to 6"

Standards:

- UL Standard 467
- CSA Standard: C22.2 No. 41



Applications:

Calbond PVC Coated Grounding Bushings feature 20 mil PVC coating provides corrosion protection from harsh environments. Electrical continuity of the conduit system is maintained across assembled joints. Includes grounding lug.

Item Number	Trade Size (in)	Weight / 100 (lb)
PV0500GLL1	½	10
PV0700GLL2	¾	10
PV1000GLL3	1	10
PV1200GLL4	1¼	20
PV1500GLL5	1½	20
PV2000GLL6	2	30
PV2500GLL7	2½	50
PV3000GLL8	3	70
PV3500GLL9	3½	100
PV4000GLL10	4	100
PV5000GLL11	5	1.4
PV6000GLL12	6	1.6

All dimensions are for informational purposes only *Tolerances +/- 5%

Strut Accessories

U-Bolts

Features:

- 20 mil black PVC exterior coating
- 12 trade sizes ½" to 6"
- Specifically sized to fit Calbond

Standards:

- UL Standard 467
- CSA Standard: C22.2 No. 41

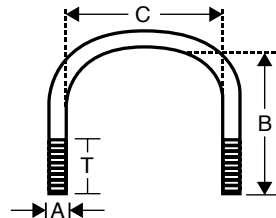

Applications:

Calbond U-Bolts are used to secure conduit or cables in corrosive environments. Constructed of galvanized steel and coated with 20 mils of PVC to protect from corrosion.

Part Number	Trade Size (in)	A (in)	B (in)	C (in)	T (in)	Weight / 100 (lb)
PV0500UB00	½	5/16	2.54	0.93	1.70	0.17
PV0700UB00	¾	5/16	2.80	1.14	1.70	0.18
PV1000UB00	1	5/16	2.96	1.36	1.70	0.20
PV1200UB00	1¼	5/16	2.95	1.51	1.70	0.20
PV1500UB00	1½	¾	2.95	1.93	1.70	0.31
PV2000UB00	2	¾	4.32	2.45	2.30	0.34
PV2500UB00	2½	¾	4.68	2.95	2.30	0.39
PV3000UB00	3	¾	5.24	3.58	2.30	0.44
PV3500UB00	3½	¾	5.75	4.10	2.30	0.45
PV4000UB00	4	¾	6.81	4.61	2.30	0.49
PV5000UB00	5	¾	7.95	5.56	3.00	1.00
PV6000UB00	6	¾	8.05	6.86	2.00	1.30

All dimensions are for informational purposes only *Tolerances +/- 5%

Mini Hangers

Features:

- 20 mil black PVC exterior coating
- 10 trade sizes ½" to 4"
- Specifically sized to fit PVC Coated Conduit
- Includes stainless steel carriage bolt

Applications:

Calbond Mini Hangers are used to hang conduit or cables in corrosive environments. Constructed of galvanized steel and coated with 20 mils of PVC to protect from corrosion.



Part Number	Trade Size (in)	Weight / 100 (lb)
PV0500MH00	½	0.10
PV0700MH00	¾	0.10
PV1000MH00	1	0.10
PV1200MH00	1¼	0.10
PV1500MH00	1½	0.20
PV2000MH00	2	0.30
PV2500MH00	2½	0.40
PV3000MH00	3	0.50
PV3500MH00	3½	0.60
PV4000MH00	4	0.70

All dimensions are for informational purposes only *Tolerances +/- 5%

Strut Accessories

J-Hanger Pipe Straps

Features:

- Exterior PVC coating thickness is a minimum 0.020"
- Sizes available are ½" to 6"

Applications:

Calbond PVC Coated J-Hanger Pipe Straps are used for suspending pipe or conduit. Side hole allows for secure mounting.



Part Number	Trade Size (in)	Weight / 100 (lb)
PV0500B3690-½	½	18
PV0700B3690-¾	¾	21
PV1000B3690-1	1	22
PV1200B3690-1¼	1¼	25
PV1500B3690-1½	1½	27
PV2000B3690-2	2	29
PV2500B3690-2½	2½	64
PV3000B3690-3	3	72
PV3500B3690-3½	3½	84
PV4000B3690-4	4	138
PV5000B3690-5	5	162
PV5000B3690-6	6	249

All dimensions are for informational purposes only *Tolerances +/- 5%

Pipe Straps & Clamp Back Spacers

Features:

- Exterior PVC coating thickness is a minimum 0.020"
- Sizes available are ½" to 4"

Applications:

Calbond PVC Coated Pipe Straps are used to securely mount conduit to a wall or other structure for support. They are available in two styles: one-hole malleable iron strap or two-hole stamped steel strap. Clamp backs are used to space the conduit from a wall or structure.



1 HOLE MALLEABLE STRAPS

2 HOLE STRAPS

CLAMP BACK

Part Number	Trade Size (in)	Weight / 100 (lb)	Part Number	Trade Size (in)	Weight / 100 (lb)	Part Number	Trade Size (in)	Weight / 100 (lb)
PV05001S00	½	110	PV05002S00	½	200	PV0500CB1	½	10
PV07001S00	¾	140	PV07002S00	¾	300	PV0700CB2	¾	10
PV10001S00	1	120	PV10002S00	1	400	PV1000CB3	1	10
PV12001S00	1¼	250	PV12002S00	1¼	450	PV1200CB4	1¼	20
PV15001S00	1½	360	PV15002S00	1½	500	PV1500CB5	1½	20
PV20001S00	2	710	PV20002S00	2	1,000	PV2000CB6	2	30
PV25001S00	2½	1,110	PV25002S00	2½	1,300	PV2500CB7	2½	100
PV30001S00	3	1,340	PV30002S00	3	1,700	PV3000CB8	3	170
PV35001S00	3½	1,660	PV35002S00	3½	2,000	PV3500CB9	3½	190
PV40001S00	4	2,560	PV40002S00	4	2,500	PV4000CB10	4	200

All dimensions are for informational purposes only *Tolerances +/- 5%



Beam Clamps

Beam Clamps

Right Angle, Parallel & Edge Clamps 158

Right Angle, Parallel & Edge Clamps

Features:

- Exterior PVC coating thickness is a minimum 0.040"
- Right angle clamps are supplied with an adjusted size U-bolt and encapsulated nuts
- Beam clamps are specifically sized to fit Calbond PVC coated conduit
- Right angle clamps available in sizes ½" to 4"
- Parallel clamps available in sizes ½" to 4"
- Edge clamps available in sizes ½" to 1"

Applications:

- PVC Coated Beam Clamps are used to securely support conduit runs by attaching them to beams, angles, trusses and other structural members. They are available in three different styles:
 - Right Angle: attaches the conduit run at a 90 degree angle to a beam or structural member
 - Parallel: attaches the conduit run parallel to a beam or structural member
 - Edge: attaches the conduit run at a 90 degree angle perpendicular to a beam or structural member



PVC COATED
RIGHT ANGLE CLAMPS



PVC COATED
PARALLEL CLAMPS



PVC COATED
EDGE CLAMPS

Part Number	Trade Size (in)	Weight / 100 (lb)	Part Number	Trade Size (in)	Weight / 100 (lb)	Part Number	Trade Size (in)	Weight / 100 (lb)
PV0500RAC50HD	½	110	PV0500PARC50HD	½	200	PV0500ETC50HD	½	10
PV0700RAC75HD	¾	140	PV0700PARC75HD	¾	300	PV0700ETC75HD	¾	10
PV1000RAC100HD	1	120	PV1000PARC100HD	1	400	PV1000ETC100HD	1	10
PV1200RAC125HD	1¼	250	PV1200PARC125HD	1¼	450			
PV1500RAC150HD	1½	360	PV1500PARC150HD	1½	500			
PV2000RAC200HD	2	710	PV2000PARC200HD	2	1,000			
PV2500RAC250HD	2½	1,110	PV2500PARC250HD	2½	1,300			
PV3000RAC300HD	3	1,340	PV3000PARC300HD	3	1,700			
PV3500RAC350HD	3½	1,660	PV3500PARC350HD	3½	2,000			
PV4000RAC400HD	4	2,560	PV4000PARC400HD	4	2,500			

All dimensions are for informational purposes only *Tolerances +/- 5%





Nipples

Nipples

162

Aluminum Nipples

164

Nipples

Features:

- Exterior PVC coating thickness is a minimum 0.040"
- Interior Urethane coating thickness is a minimum 0.002"
- Sizes available are ½" to 6"
- Color coded threaded protectors for easy identification of conduit size

Standards:

- UL/CUL listed in accordance to UL6 & ANSI C80.1 Standards
- UL/CUL listed rigid ferrous metal conduit with polyvinyl chloride coating verified for PVC adhesion performance
- Complies with NEMA RN1
- UL File # E226472 & E230584

Applications:

Calbond PVC Coated Nipples are available in all lengths and diameters. All nipples are manufactured from Calbond PVC coated conduit.



Part Number	Trade Size (in)	Length (in)	Weight each (lb)
PV05CLCN00	½ x cl	1 ⅞	0.11
PV0520CN00	½ x 2	2	0.14
PV0525CN00	½ x 2 ½	2 ½	0.18
PV0530CN00	½ x 3	3	0.21
PV0535CN00	½ x 3 ½	3 ½	0.26
PV0540CN00	½ x 4	4	0.28
PV0550CN00	½ x 5	5	0.35
PV0560CN00	½ x 6	6	0.42
PV0580CN00	½ x 8	8	0.56
PV0510CN00	½ x 10	10	0.60
PV0512CN00	½ x 12	12	0.84
<hr/>			
PV07CLCN00	¾ x cl	1 ⅜	0.11
PV0720CN00	¾ x 2	2	0.20
PV0725CN00	¾ x 2 ½	2 ½	0.24
PV0730CN00	¾ x 3	3	0.29
PV0735CN00	¾ x 3 ½	3 ½	0.35
PV0740CN00	¾ x 4	4	0.39
PV0750CN00	¾ x 5	5	0.49
PV0760CN00	¾ x 6	6	0.50
PV0780CN00	¾ x 8	8	0.78
PV0710CN00	¾ x 10	10	0.97
PV0712CN00	¾ x 12	12	1.12

Part Number	Trade Size (in)	Length (in)	Weight each (lb)
PV10CLCN00	1 X CL	1 ½	0.11
PV1020CN00	1 X 2	2	0.28
PV1025CN00	1 X 2 ½	2 ½	0.35
PV1030CN00	1 X 3	3	0.42
PV1035CN00	1 X 3 ½	3 ½	0.56
PV1040CN00	1 X 4	4	0.56
PV1050CN00	1 X 5	5	0.70
PV1060CN00	1 X 6	6	0.84
PV1080CN00	1 X 8	8	1.12
PV1010CN00	1 X 10	10	1.45
PV1012CN00	1 X 12	12	1.68
<hr/>			
PV12CLCN00	1 ¼ X CL	1 ⅝	0.27
PV1220CN00	1 ¼ X 2	2	0.45
PV1225CN00	1 ¼ X 2 ½	2 ½	0.36
PV1230CN00	1 ¼ X 3	3	0.54
PV1235CN00	1 ¼ X 3 ½	3 ½	0.63
PV1240CN00	1 ¼ X 4	4	0.99
PV1250CN00	1 ¼ X 5	5	1.20
PV1260CN00	1 ¼ X 6	6	1.08
PV1280CN00	1 ¼ X 8	8	1.35
PV1210CN00	1 ¼ X 10	10	1.80
PV1212CN00	1 ¼ X 12	12	2.16

Nipples

Nipples continued

Part Number	Trade Size (in)	Length (in)	Weight each (lb)
PV15CLCN00	½ x CL	1 ⅞	0.33
PV1520CN00	½ x 2	2	0.44
PV1525CN00	½ x 2 ½	2 ½	0.55
PV1530CN00	½ x 3	3	0.60
PV1535CN00	½ x 3 ½	3 ½	0.82
PV1540CN00	½ x 4	4	0.88
PV1550CN00	½ x 5	5	1.10
PV1560CN00	½ x 6	6	1.44
PV1580CN00	½ x 8	8	1.76
PV1510CN00	½ x 10	10	2.20
PV1512CN00	½ x 12	12	2.64
<hr/>			
PV20CLCN00	2 x CL	2	0.45
PV2025CN00	2 x 2 ½	2 ½	0.75
PV2030CN00	2 x 3	3	0.90
PV2035CN00	2 x 3 ½	3 ½	1.05
PV2040CN00	2 x 4	4	1.20
PV2050CN00	2 x 5	5	1.50
PV2060CN00	2 x 6	6	1.80
PV02080CN00	2 x 8	8	2.40
PV2010CN00	2 x 10	10	3.00
PV2012CN00	2 x 12	12	3.60
<hr/>			
PV25CLCN00	2 ½ x CL	2 ½	0.68
PV2535CN00	2 ½ x 3 ½	3 ½	1.58
PV2540CN00	2 ½ x 4	4	1.88
PV2550CN00	2 ½ x 5	5	2.25
PV2560CN00	2 ½ x 6	6	2.70
PV2580CN00	2 ½ x 8	8	3.20
PV2510CN00	2 ½ x 10	10	4.50
PV2512CN00	2 ½ x 12	12	5.40
<hr/>			
PV30CLCN00	3 x CL	2 ⅞	0.89
PV3035CN00	3 x 3 ½	3 ½	2.07
PV3040CN00	3 x 4	4	2.36
PV3050CN00	3 x 5	5	2.95
PV3060CN00	3 x 6	6	3.54
PV3080CN00	3 x 8	8	4.72
PV3010CN00	3 x 10	10	5.90
PV3012CN00	3 x 12	12	7.08



Part Number	Trade Size (in)	Length (in)	Weight each (lb)
PV35CLCN00	3 ½ x CL	2 ¾	1.02
PV3540CN00	3 ½ x 4	4	3.00
PV3550CN00	3 ½ x 5	5	3.55
PV3560CN00	3 ½ x 6	6	4.88
PV3580CN00	3 ½ x 8	8	5.68
PV3510CN00	3 ½ x 10	10	7.10
PV3512CN00	3 ½ x 12	12	8.52
<hr/>			
PV40CLCN00	4 x CL	2 ¾	1.50
PV4040CN00	4 x 4	4	4.00
PV4050CN00	4 x 5	5	5.00
PV4060CN00	4 x 6	6	6.00
PV4080CN00	4 x 8	8	8.00
PV4010CN00	4 x 10	10	10.00
PV4012CN00	4 x 12	12	12.00
<hr/>			
PV50CLCN00	5 x CL	3	1.82
PV5050CN00	5 x 5	5	6.30
PV5060CN00	5 x 6	6	8.60
PV5080CN00	5 x 8	8	10.80
PV5010CN00	5 x 10	10	12.50
PV5012CN00	5 x 12	12	15.12
<hr/>			
PV60CLCN00	6 x CL	3 ⅞	2.10
PV6050CN00	6 x 5	5	7.10
PV6060CN00	6 x 6	6	9.20
PV6080CN00	6 x 8	8	11.30
PV6010CN00	6 x 10	10	13.90
PV6012CN00	6 x 12	12	16.80

Aluminum Nipples

Features:

- Exterior PVC coating thickness is a minimum 0.040"
- Interior Urethane coating thickness is a minimum 0.002"
- Sizes available are ½" to 6"
- Color coded threaded protectors for easy identification of conduit size

Standards:

- UL/CUL listed in accordance to UL6 & ANSI C80.1 Standards
- UL/CUL listed rigid ferrous metal conduit with polyvinyl chloride coating verified for PVC adhesion performance
- Complies with NEMA RN1
- UL File Number E230584

Applications:

Calbond PVC Coated Aluminum Nipples are available in all lengths and diameters. All nipples are manufactured from Calbond PVC coated conduit.

Part Number	Trade Size (in)	Length (in)	Weight each (lbs)
PA05CLCN00	½ X CL	1 ⅛	0.11
PA0520CN00	½ X 2	2	0.14
PA0525CN00	½ X 2 ½	2 ½	0.18
PA0530CN00	½ X 3	3	0.21
PA0535CN00	½ X 3 ½	3 ½	0.26
PA0540CN00	½ X 4	4	0.28
PA0550CN00	½ X 5	5	0.35
PA0560CN00	½ X 6	6	0.42
PA0580CN00	½ X 8	8	0.56
PA0510CN00	½ X 10	10	0.60
PA0512CN00	½ X 12	12	0.84
<hr/>			
PA07CLCN00	¾ X CL	1 ⅜	0.11
PA0720CN00	¾ X 2	2	0.20
PA0725CN00	¾ X 2 ½	2 ½	0.24
PA0730CN00	¾ X 3	3	0.29
PA0735CN00	¾ X 3 ½	3 ½	0.35
PA0740CN00	¾ X 4	4	0.39
PA0750CN00	¾ X 5	5	0.49
PA0760CN00	¾ X 6	6	0.50
PA0780CN00	¾ X 8	8	0.78
PA0710CN00	¾ X 10	10	0.97
PA0712CN00	¾ X 12	12	1.12

Part Number	Trade Size (in)	Length (in)	Weight each (lbs)
PA10CLCN00	1 X CL	1 ½	0.11
PA1020CN00	1 X 2	2	0.28
PA1025CN00	1 X 2 ½	2 ½	0.35
PA1030CN00	1 X 3	3	0.42
PA1035CN00	1 X 3 ½	3 ½	0.56
PA1040CN00	1 X 4	4	0.56
PA1050CN00	1 X 5	5	0.70
PA1060CN00	1 X 6	6	0.84
PA1080CN00	1 X 8	8	1.12
PA1010CN00	1 X 10	10	1.45
PA1012CN00	1 X 12	12	1.68
<hr/>			
PA12CLCN00	1¼ X CL	1 ⅝	0.27
PA1220CN00	1¼ X 2	2	0.45
PA1225CN00	1¼ X 2 ½	2 ½	0.36
PA1230CN00	1¼ X 3	3	0.54
PA1235CN00	1¼ X 3 ½	3 ½	0.63
PA1240CN00	1¼ X 4	4	0.99
PA1250CN00	1¼ X 5	5	1.20
PA1260CN00	1¼ X 6	6	1.08
PA1280CN00	1¼ X 8	8	1.35
PA1210CN00	1¼ X 10	10	1.80
PA1212CN00	1¼ X 12	12	2.16

Aluminum Nipples

Part Number	Trade Size (in)	Length (in)	Weight each (lbs)
PA15CLCN00	½ X CL	1 ½	0.33
PA1520CN00	½ X 2	2	0.44
PA1525CN00	½ X 2 ½	2 ½	0.55
PA1530CN00	½ X 3	3	0.60
PA1535CN00	½ X 3 ½	3 ½	0.82
PA1540CN00	½ X 4	4	0.88
PA1550CN00	½ X 5	5	1.10
PA1560CN00	½ X 6	6	1.44
PA1580CN00	½ X 8	8	1.76
PA1510CN00	½ X 10	10	2.20
PA1512CN00	½ X 12	12	2.64
<hr/>			
PA20CLCN00	2 X CL	2	0.45
PA2025CN00	2 X 2 ½	2 ½	0.75
PA2030CN00	2 X 3	3	0.90
PA2035CN00	2 X 3 ½	3 ½	1.05
PA2040CN00	2 X 4	4	1.20
PA2050CN00	2 X 5	5	1.50
PA2060CN00	2 X 6	6	1.80
PA02080CN00	2 X 8	8	2.40
PA2010CN00	2 X 10	10	3.00
PA2012CN00	2 X 12	12	3.60
<hr/>			
PA25CLCN00	2 ½ x CL	2 ½	0.68
PA2535CN00	2 ½ X 3 ½	3 ½	1.58
PA2540CN00	2 ½ X 4	4	1.88
PA2550CN00	2 ½ X 5	5	2.25
PA2560CN00	2 ½ X 6	6	2.70
PA2580CN00	2 ½ X 8	8	3.20
PA2510CN00	2 ½ X 10	10	4.50
PA2512CN00	2 ½ X 12	12	5.40
<hr/>			
PA30CLCN00	3 x CL	2 ¾	0.89
PA3035CN00	3 X 3 ½	3 ½	2.07
PA3040CN00	3 X 4	4	2.36
PA3050CN00	3 X 5	5	2.95
PA3060CN00	3 X 6	6	3.54
PA3080CN00	3 X 8	8	4.72
PA3010CN00	3 X 10	10	5.90
PA3012CN00	3 X 12	12	7.08



Part Number	Trade Size (in)	Length (in)	Weight each (lbs)
PA35CLCN00	3 ½ X CL	2 ¾	1.02
PA3540CN00	3 ½ X 4	4	3.00
PA3550CN00	3 ½ X 5	5	3.55
PA3560CN00	3 ½ X 6	6	4.88
PA3580CN00	3 ½ X 8	8	5.68
PA3510CN00	3 ½ X 10	10	7.10
PA3512CN00	3 ½ X 12	12	8.52
<hr/>			
PA40CLCN00	4 X CL	2 ¾	1.50
PA4040CN00	4 X 4	4	4.00
PA4050CN00	4 X 5	5	5.00
PA4060CN00	4 X 6	6	6.00
PA4080CN00	4 X 8	8	8.00
PA4010CN00	4 X 10	10	10.00
PA4012CN00	4 X 12	12	12.00
<hr/>			
PA50CLCN00	5 X CL	3	1.82
PA5050CN00	5 X 5	5	6.30
PA5060CN00	5 X 6	6	8.60
PA5080CN00	5 X 8	8	10.80
PA5010CN00	5 X 10	10	12.50
PA5012CN00	5 X 12	12	15.12
<hr/>			
PA60CLCN00	6 X CL	3 ¾	2.10
PA6050CN00	6 X 5	5	7.10
PA6060CN00	6 X 6	6	9.20
PA6080CN00	6 X 8	8	11.30
PA6010CN00	6 X 10	10	13.90
PA6012CN00	6 X 12	12	16.80



Accessories and Tools

Accessories and Tools

Touch Up Compound	168
Aluminum Wrench	168
Half Shell Conduit Clamp	169

Touch Up Compound



Part Number	Description	Size
PV-Touchup_Black_PT	Black Touch-Up Compound with Brush Top	1 Pint
PV-Touchup_Spray	12 oz. Spray Exterior Black Touch-Up Compound	12 oz.
PV-Thread-Compound	Conductive Compound with Brush Top	1 Pint

Aluminum Wrench



Part Number	Description
PV000070159C	10" Pipe Wrench
PV000070160C	14" Pipe Wrench
PV000070161C	18" Pipe Wrench
PV000070162C	24" Pipe Wrench

Accessories and Tools

Half Shell Conduit Clamp



Part Number	Description
PV0500HS-CLP1/2	1/2" Half Shell Clamp
PV0700HS-CLP3/4	3/4" Half Shell Clamp
PV1000HS-CLP1	1" Half Shell Clamp
PV1200HS-CLP1-1/4	1 1/4" Half Shell Clamp
PV1500HSCLP1-1/2	1 1/2" Half Shell Clamp
PV2000HS-CLP2	2" Half Shell Clamp
PV2500HS-CLP2-1/2	2 1/2" Half Shell Clamp
PV3000HS-CLP3	3" Half Shell Clamp
PV3500HS-CLP3-1/2	3 1/2" Half Shell Clamp
PV4000HS-CLP4	4" Half Shell Clamp
PV5000HS-CLP5	5" Half Shell Clamp
PV6000HS-CLP6	6" Half Shell Clamp
PV0520HS-CLPSET	1/2-2" Half Shell Clamp Set



CERTIFIED INSTALLER PROGRAM

Course Overview

The Calbond Certified Installer Program provides the proper procedures and proven techniques to ensure a quality corrosion resistant conduit system. With proper installation, one can expect a long lasting, superior corrosion resistant conduit system that requires little to no maintenance.

Course Content

Standards Review

- Review of the industry standards applicable to PVC coated conduit systems.

Field Installation Topics

Cutting

- Highlight the various tools and techniques for cutting and preparing coated conduit for threading and bending in field setting.

Clamping

- Demonstrate proper use of recommended clamping devices and additional tools required to ensure integrity of PVC coating over UL galvanized rigid conduit GRC.

Threading

- List the appropriate threading tools and machinery for each trade size of coated conduit.

Bending

- Proper bending techniques for custom field bending on coated conduit.

Repair

- Recommended procedures for repairing areas of damaged coating on PVC coated conduit systems. Properly repaired coating is essential for a long lasting corrosion resistant system.

Certification Process

- Written examination.

Class Curriculum

- 30 minutes - Plant Operations Tour
- 1 hour - Classroom Instruction: Understanding Corrosion and its Consequences and Prevention
- 2 hours - Training Center - Hands-on Training
- 1 hour - Classroom Instruction - Standards, Installation Tools
- 30 minutes - Written Test Administered
- Closing - Presentation of Course Completion Materials



65% Practical 35% Theory Qualification

- Calbond Certified Installer

Who should attend

- Installers and electricians who install Calbond PVC Coated Conduit Systems

Benefits of attending the course

- Quality installation by trained professionals
- Meet industry specifications requiring certified installers of PVC coated conduit systems
- Lower Cost of Ownership
- Extends product warranty from 2 years to 5 years

Course objectives

- To have a full understanding for current applicable specifications along with the skills and expertise to install Calbond PVC Coated Conduit Systems

Prerequisites

- Suggested 2 years experience installing PVC coated conduit systems

Course locations

- Hobart, IN
- * On-Site Training requires minimum of 5 participants.

Contact mlang@atkore.com
to Register





Allied Tube & Conduit ▸ AFC Cable Systems ▸ Heritage Plastics ▸ Unistrut
Unistrut Construction ▸ Cope ▸ US Tray ▸ Calbrite ▸ Calbond ▸ Kaf-Tech
Power-Strut ▸ Calconduit ▸ Razor Ribbon ▸ Calpipe Security ▸ Vergokan ▸ Cii
Columbia-MBF ▸ Eastern Wire + Conduit ▸ ACS/Uni-Fab ▸ Sasco Strut ▸ Marco
FRE Composites ▸ Queen City Plastics ▸ Four Star Industries ▸ Flexicon

Atkore
12160 Woodruff Ave.
Downey, CA 90241

TOLL FREE / 562-803-4388
FAX / 310-885-1894
calbond.com

Want to join a company that helps you build
the mindset, skill set and tool set for success?
Visit us at [atkore.com/careers](https://www.atkore.com/careers)